

Fig. 22: View Of Pushrods
Courtesy of GENERAL MOTORS CORP.

4. Remove the pushrods.

CYLINDER HEAD REMOVAL - LEFT SIDE

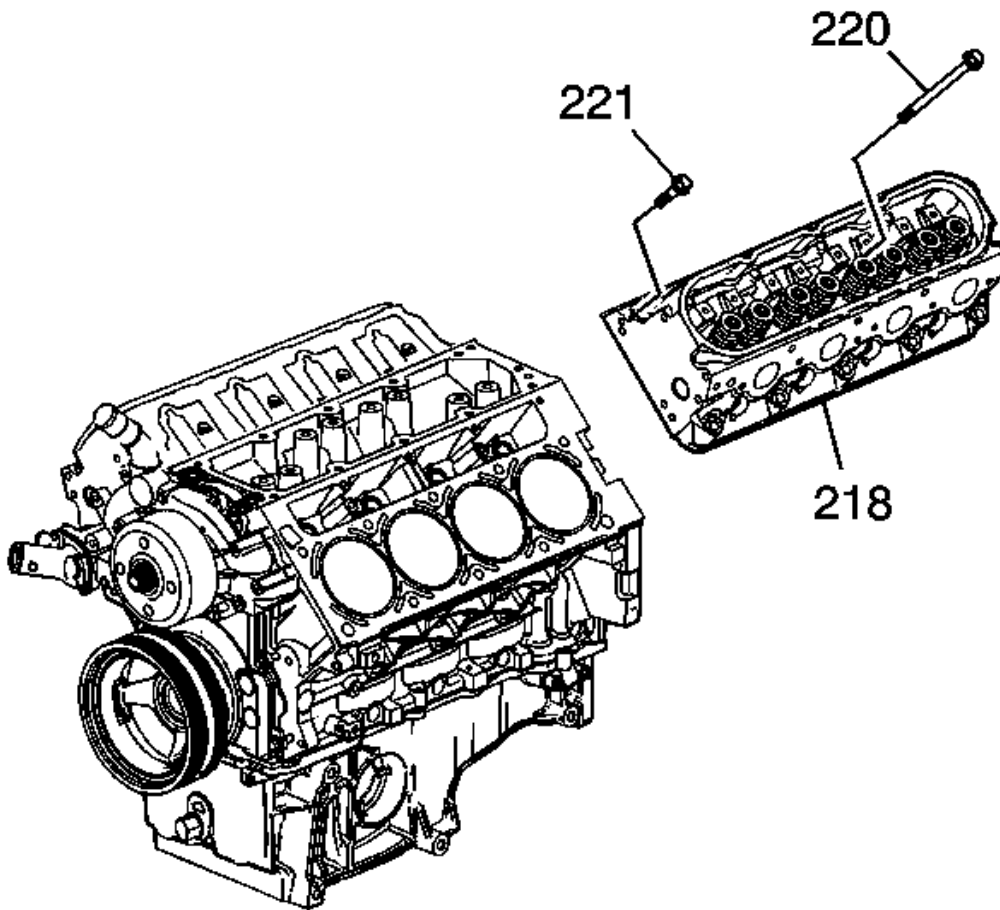

Fig. 23: Identifying Cylinder Head
Courtesy of GENERAL MOTORS CORP.

NOTE: The cylinder head bolts are of a torque-to-yield design and are NOT to be used again. Install NEW cylinder head bolts during assembly.

1. Remove the cylinder head bolts (220, 221).

CAUTION: After removal, place the cylinder head on 2 wood blocks in order to prevent damage to the sealing surfaces.

2. Remove the cylinder head (218).

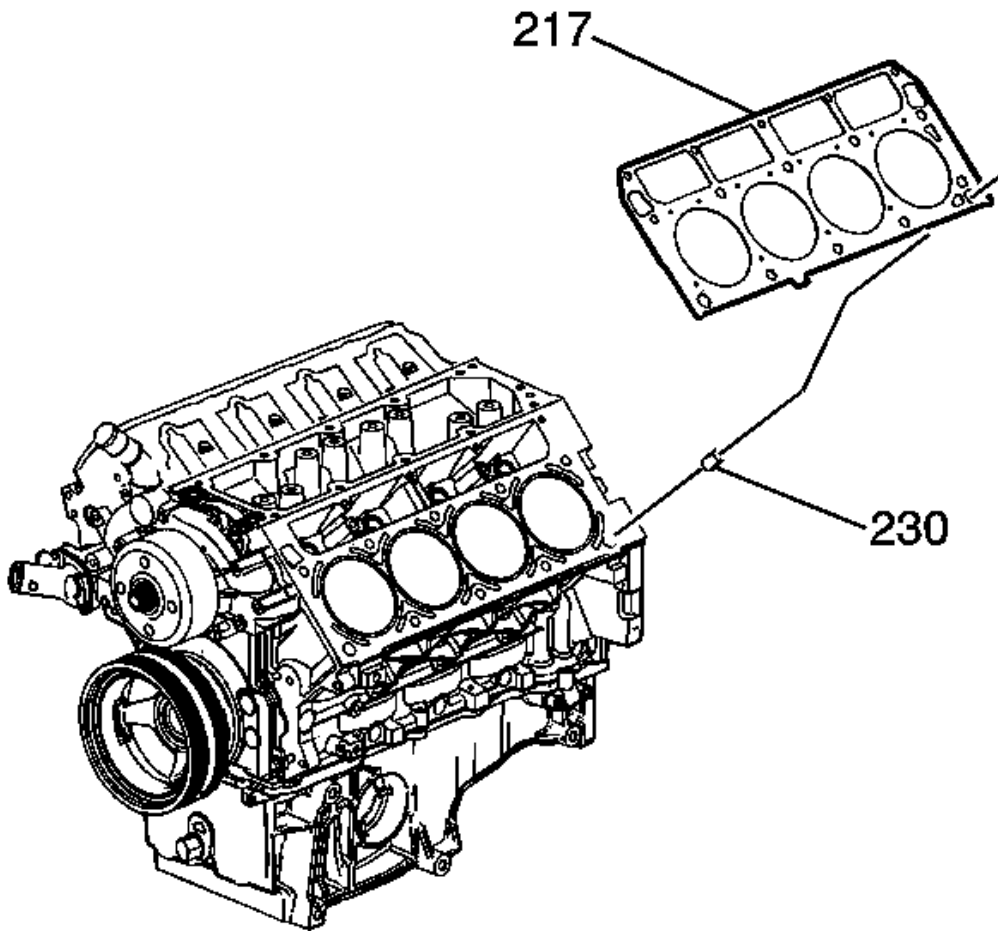

Fig. 24: Identifying Cylinder Head Gasket
Courtesy of GENERAL MOTORS CORP.

3. Remove the gasket (217) and locating pins (230).
4. Discard the gasket and cylinder head bolts.

CYLINDER HEAD REMOVAL - RIGHT SIDE

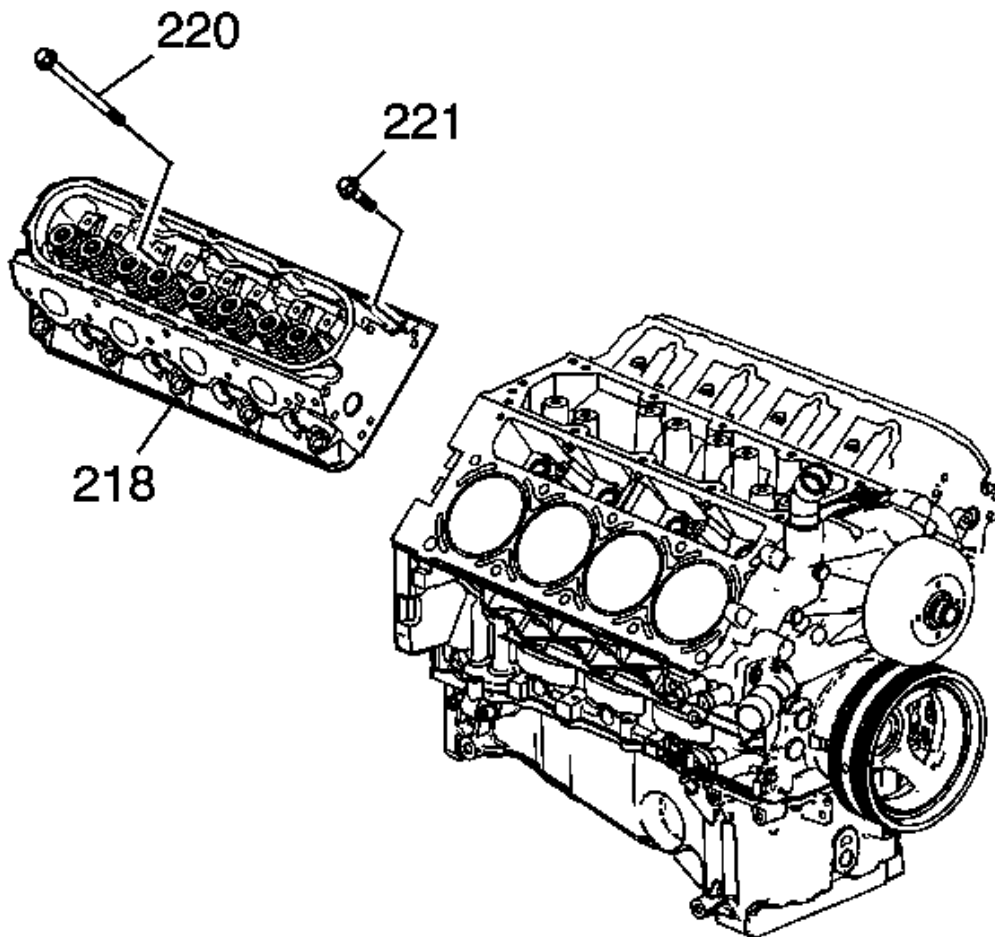

Fig. 25: Identifying Cylinder Head
Courtesy of GENERAL MOTORS CORP.

NOTE: The cylinder head bolts are of a torque-to-yield design and are NOT to be used again. Install NEW cylinder head bolts during assembly.

1. Remove the cylinder head bolts (220, 221).

CAUTION: After removal, place the cylinder head on 2 wood blocks in order to prevent damage to the sealing surfaces.

2. Remove the cylinder head (218).

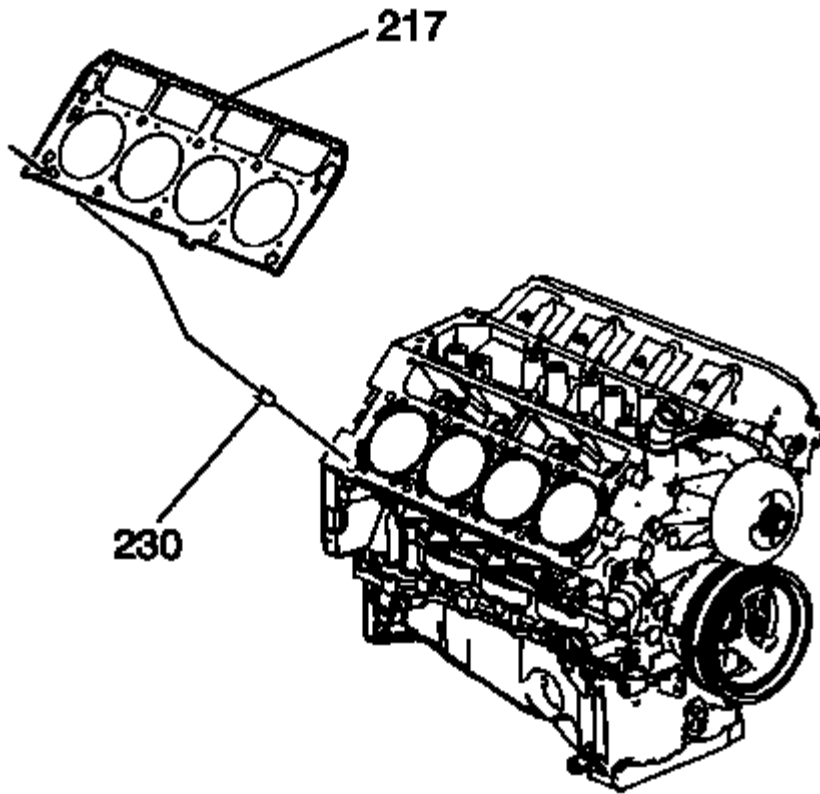

Fig. 26: Identifying Cylinder Head Gasket
Courtesy of GENERAL MOTORS CORP.

3. Remove the gasket (217) and locating pins (230).
4. Discard the gasket and cylinder head bolts.

VALVE LIFTER REMOVAL (5.3L)

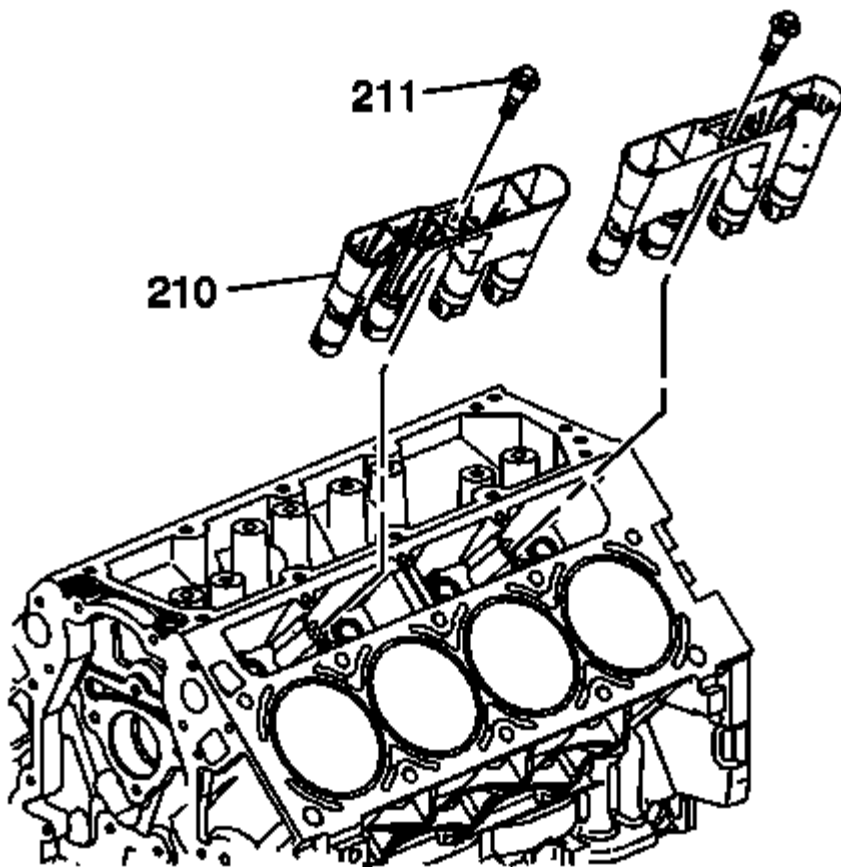

Fig. 27: View Of Lifter Guides & Lifters
Courtesy of GENERAL MOTORS CORP.

1. Remove the bolts (211).
2. Remove the guides (210) with lifters.

Note the installed position of the guides. The notched area of the guide is to align with the locating tab of the block.