

REMOVAL OF SERVO VALVE ASSEMBLY (PC120,130,150)

1. CO, NC valve assembly
For details, see REMOVAL OF CO, NC VALVE ASSEMBLY.
2. Remove servo valve assembly (1). (See F1)

INSTALLATION OF SERVO VALVE ASSEMBLY (PC120,130,150)

- Carry out installation in the reverse order to removal.

REMOVAL OF SERVO VALVE ASSEMBLY (PC180)

1. CO, NC valve assembly
For details, see REMOVAL OF CO, NC VALVE ASSEMBLY.
2. Remove servo valve assembly (1). (See F2)

INSTALLATION OF SERVO VALVE ASSEMBLY (PC180)

- Carry out installation in the reverse order to removal.

REMOVAL OF WORK EQUIPMENT PPC VALVE ASSEMBLY



Lower the work equipment to the ground and stop the engine. Operate the control levers several times to release the remaining pressure in the hydraulic piping. Then loosen the oil filler cap slowly to release the pressure inside the hydraulic tank.

1. Remove plate (1). (See F3)
2. Remove seat assembly (2). (See F3)
3. Disconnect wiring connector (3). (See F4)
4. Remove lever assembly (4). (See F4)
5. Remove cover (5). (See F4) ※1
6. Remove bracket (6). (See F5)
★ Remove the mounting bolts, and move the bracket towards the window.
7. Disconnect hose (7). (See F5)
★ Disconnect 6 hoses.
8. Remove PPC valve assembly (8). (See F5)
★ Remove mounting bolts, then remove it together with the hose.

INSTALLATION OF WORK EQUIPMENT PPC VALVE ASSEMBLY

- Carry out installation in the reverse order to removal.



- ★ Fit the stopper for the slide securely to the inside lever.

K203P5

F1

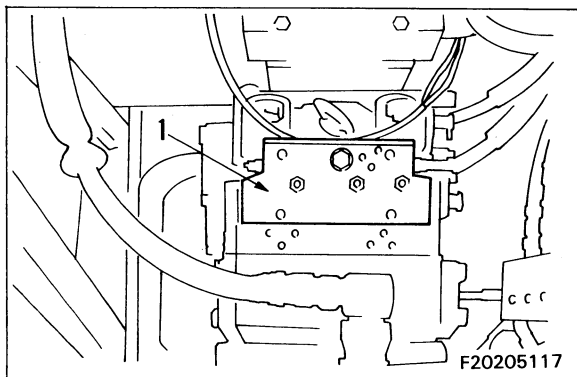

F3

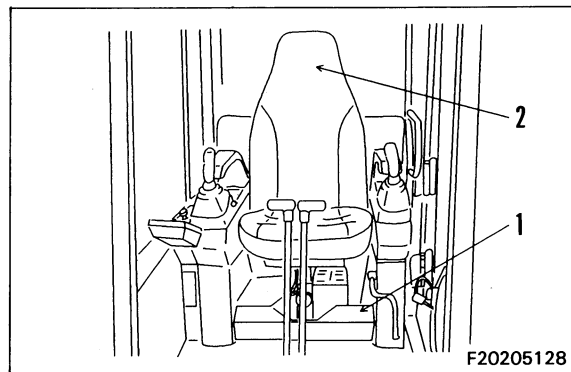

F4

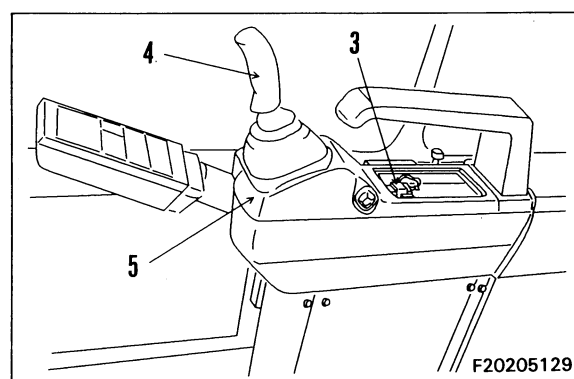

F2

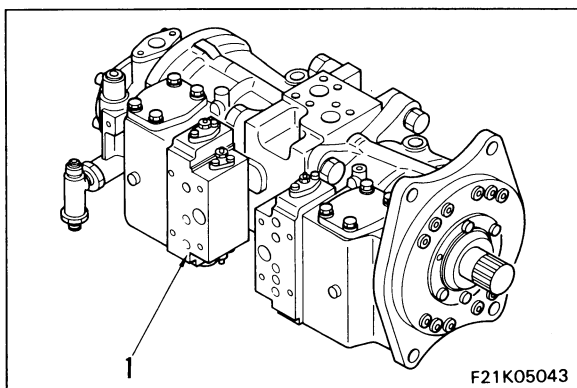

F5

