

# FUEL LEVEL METER/GAUGE

## FUEL METER INSPECTION

To test the Fuel Meter two different checks may be used. The first, and simplest test will tell if the meter is operating but will not indicate the meters accuracy throughout the range. To perform this test, remove the seat and right frame cover and disconnect the B/W and Y/B lead wires of the fuel gauge sending unit. Connect a jumper wire between B/W and Y/B wires coming from the main wiring harness. With the ignition switch turned ON, the fuel meter should indicate "F".

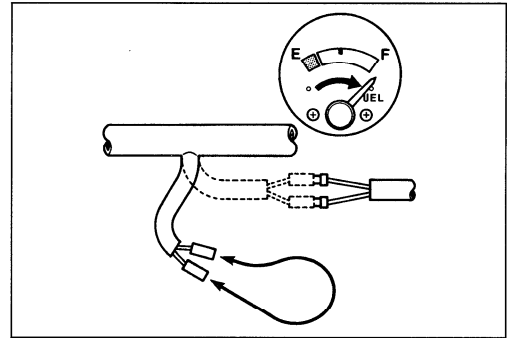

The second test will check the accuracy of the meter in the full and empty positions. Connect a 110-ohm resistor between the Y/B lead wire of the fuel gauge and the ground lead wire. The fuel meter is normal if its pointer indicates the E (empty) position when the specified voltage is applied to the circuit and if its pointer indicates the F (full) position when the resistor is changed to 3 ohms. If either one or both indications are abnormal, replace the fuel meter with a new one.

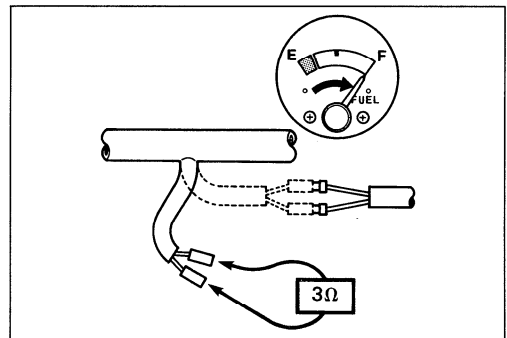
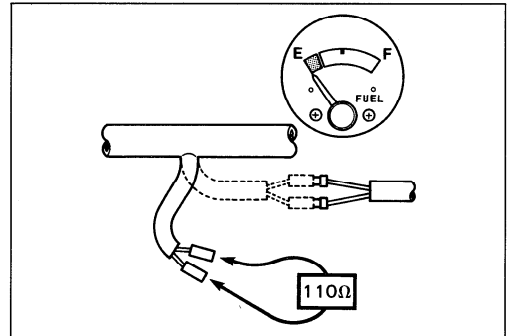

## FUEL GAUGE SENDING UNIT INSPECTION

- Remove the lead wires coming out of the fuel gauge and check resistance of each position.
- If the resistance measured is incorrect, replace the fuel gauge assembly with a new one.
- The relation between the position of the fuel gauge float and resistance is shown in the following table.

Float position	Resistance
F (Full)	Approx. 3 Ω
1/2	Approx. 32.5 Ω
E (Empty)	Approx. 110 Ω

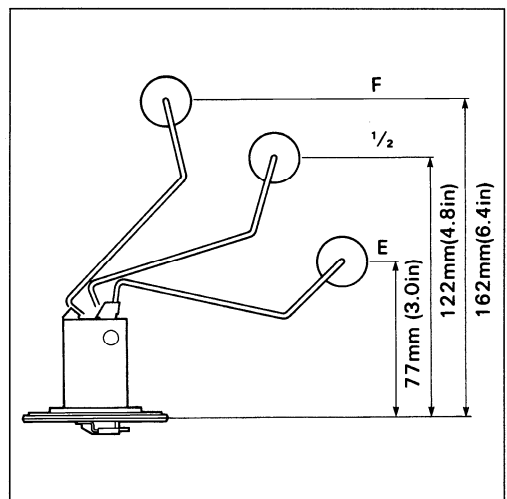

## DIGITAL CLOCK

### BATTERY REPLACEMENT

This clock is powered by built-in long-life lithium batteries. If the clock loses the function, replace the battery as follows.

- Remove the lower and upper fairings.
- Remove the headlight.
- Remove the combination meter.
- Remove the clock by removing two screws.
- Remove the cover by removing eight screws.
- Replace the two batteries with new ones.

**NOTE:**

The stamped  $\oplus$  mark on the battery is positioned outside.

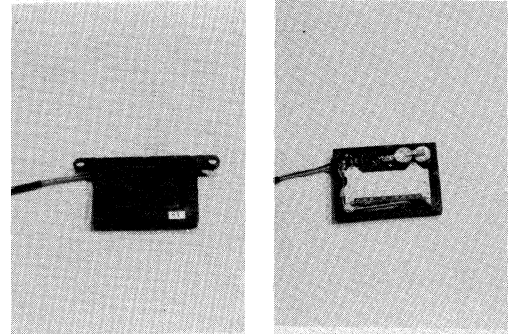
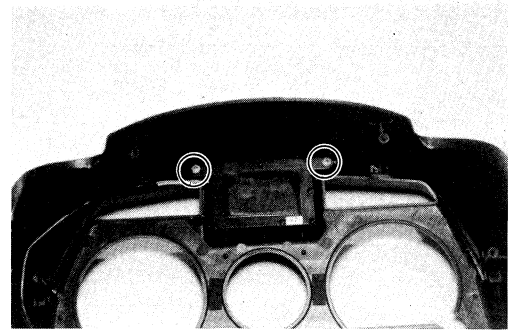

## LAMPS

### HEADLIGHT

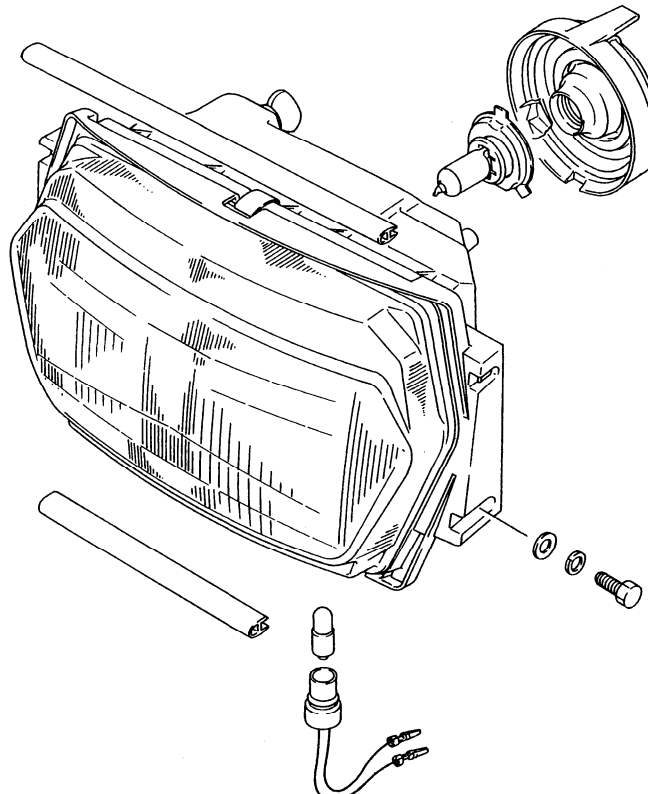

**NOTE:** Adjust the headlight, both vertical and horizontal, after reassembling.

### TAIL/BRAKE LIGHT

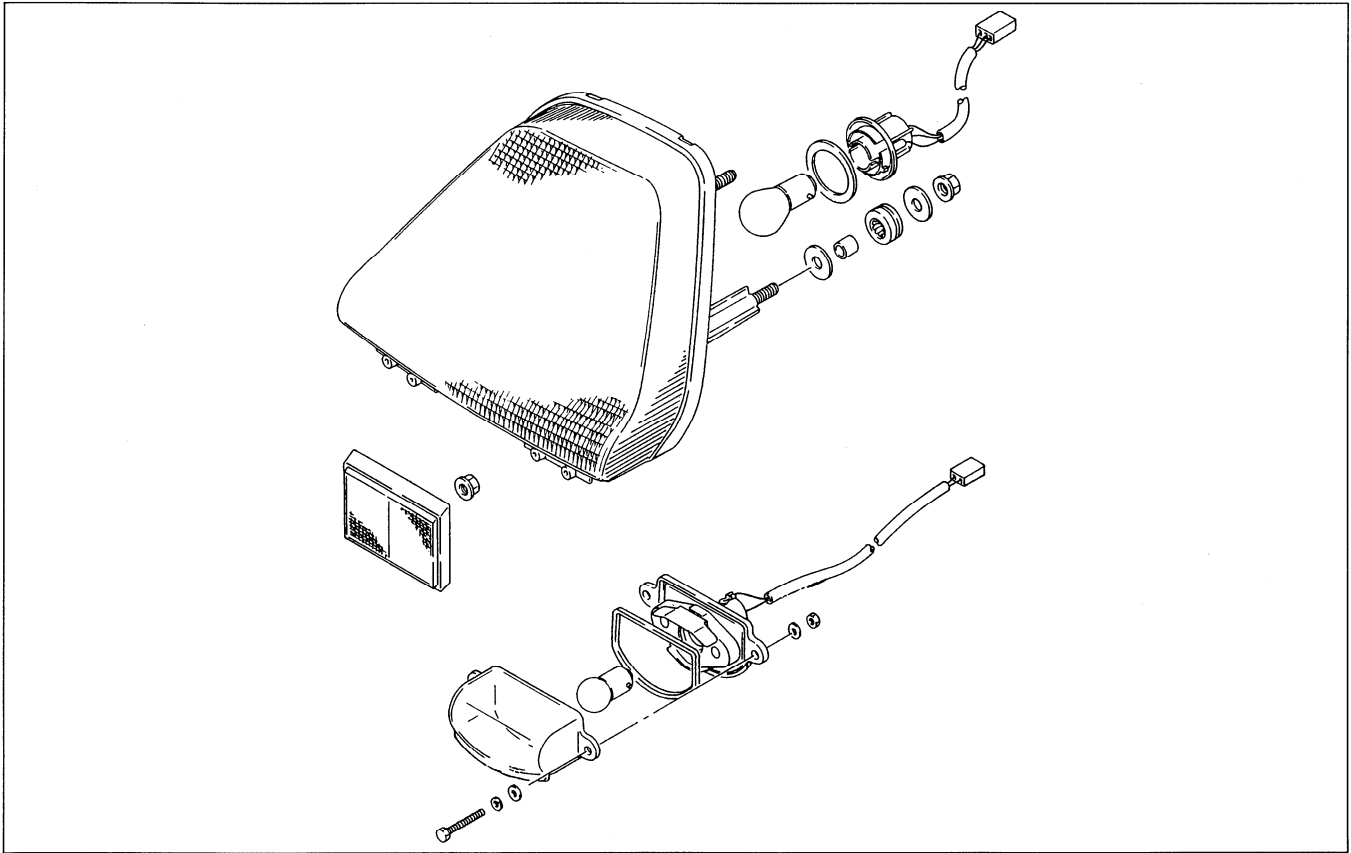

### TURN SIGNAL LIGHT

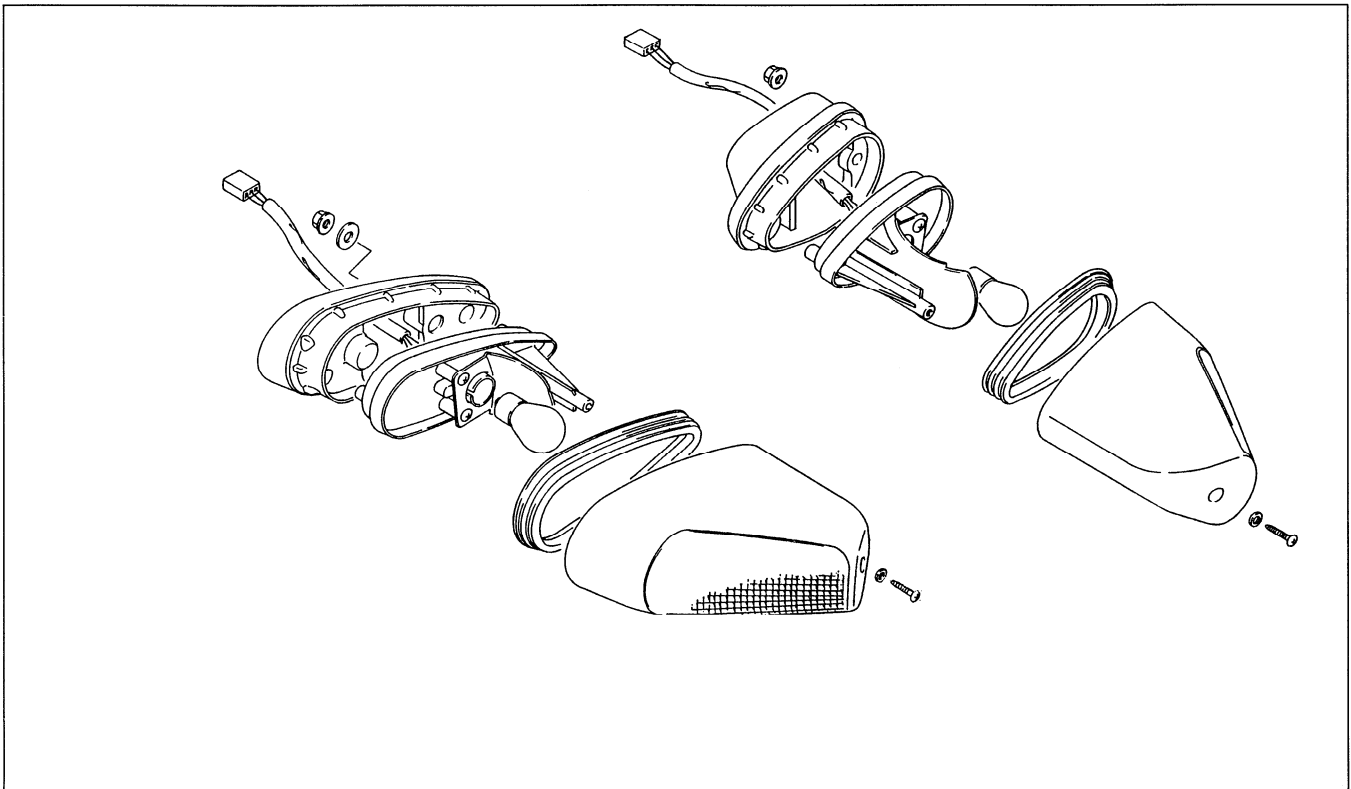

## SWITCHES

Inspect each switch for continuity with the pocket tester referring to the chart. If any abnormality is found, replace the respective switch assemblies with new ones.

09900-25002: Pocket tester

### IGNITION SWITCH

	R/W	O	Gr	Br
OFF				
ON				
P				

### LIGHTING SWITCH (Except for E-28 model)

	O/R	Y/W	O/Lg	Gr
OFF				
S				
ON				

### TURN SIGNAL SWITCH

	B	Lbl	Lg
R			
•			
L			

### PASSING SWITCH (Except for E-28 model)

	Y	O/R
ON (Push)		
OFF		

### ENGINE STOP AND START SWITCH

	O/BI	O/W	Y/G
OFF			
RUN			
START (Push)			

### DIMMER SWITCH

	W	Y	Y/W
HI			
LO			

### FRONT BRAKE SWITCH

	O/G	W/B
ON (Squeeze lever)		
OFF		

### HORN SWITCH

	G	B/W
ON (Push)		
OFF		

### NEUTRAL INDICATOR SWITCH

	BI	Ground
ON (Neutral position)		
OFF		

### CLUTCH SWITCH (For E-28 model)

	Y/G	Y/G
ON (Squeeze lever)		
OFF		

**REAR BRAKE SWITCH**

	O/G	W/B
ON (Depress pedal)	○ — ○	○ — ○
OFF		

**SIDE STAND SWITCH**

	G	B/W
ON (Upright position)	○ — ○	○ — ○
OFF (Down position)		

**OIL PRESSURE SWITCH**

- Continuity, when engine is stopped.
- No continuity, when engine is running.

	G/Y	Ground
ON	○ — ○	○ — ○
OFF		

**NOTE:**

*Before inspecting the oil pressure switch, check the engine oil level at oil inspection window.*

**WINDOW SCREEN SWITCH**

	W/G	O	W/R
UP		○ — ○	○ — ○
●			
DOWN	○ — ○	○ — ○	

**WIRE COLOR**

- Gr..... Gray
- Br..... Brown
- W..... White
- Y..... Yellow
- Y/W..... Yellow with White tracer
- B..... Black
- Lbl..... Light blue
- Lg..... Light green
- G..... Green
- B/W..... Black with White tracer
- O/W..... Orange with White tracer
- Y/G..... Yellow with Green tracer
- O/G..... Orange with Green tracer
- Bl..... Blue
- G/Y..... Green with Yellow tracer
- W/B..... White with Black tracer
- O/Bl..... Orange with Blue tracer
- R/W..... Red with White tracer
- O/R..... Orange with Red tracer
- O/Lg..... Orange with Light green tracer
- W/G..... White with Green tracer
- O..... Orange
- W/R..... White with Red tracer

## RELAY

### SIDE-STAND RELAY

The side-stand relay is located on the battery holder of front side.

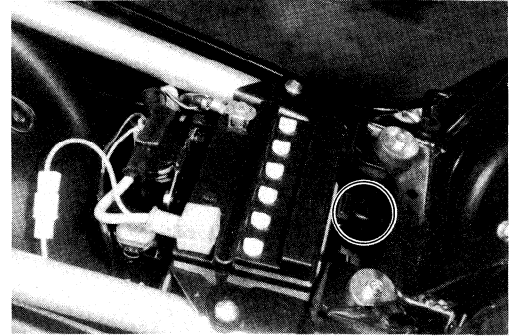

#### INSPECTION

##### First:

Check the insulation between ③ and ④ terminals with pocket tester.

##### Second:

Apply 12 volts to ① and ② terminals,  $\oplus$  to ① and  $\ominus$  to ②, and check the continuity between ③ and ④ with pocket tester. If there is no continuity, replace it with a new one.

**09900-25002: Pocket tester**

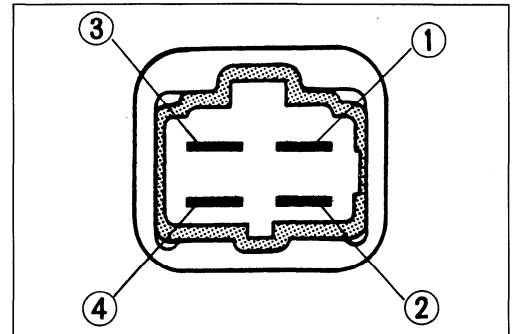

### WIND-SHIELD MOTOR RELAY

The wind-shield motor relay is located on the fairing brace of right side.

#### INSPECTION

##### First:

Check the insulation between terminals (① and ②, ① and ③) with pocket tester.

##### Second:

Apply 12 volts to ⑥ and ④ terminals,  $\oplus$  to ⑥ and  $\ominus$  to ④, and check the continuity between ① and ② terminals.

##### Third:

Apply 12 volts to ⑤ and ④ terminals,  $\oplus$  to ⑤ and  $\ominus$  to ④, and check the continuity between ① and ③ terminals.

If there is no continuity, replace it with a new one.

**09900-25002: Pocket tester**

