

## SECONDARY BEVEL GEARS CONSTRUCTION

Tightening torque

Item	N·m	kg·m	lb·ft
①	90 – 110	9.0 – 11.0	65.0 – 79.5
⑥	18 – 28	1.8 – 2.8	13.0 – 20.0
②②	18 – 28	1.8 – 2.8	13.0 – 20.0
②⑤	18 – 28	1.8 – 2.8	13.0 – 20.0

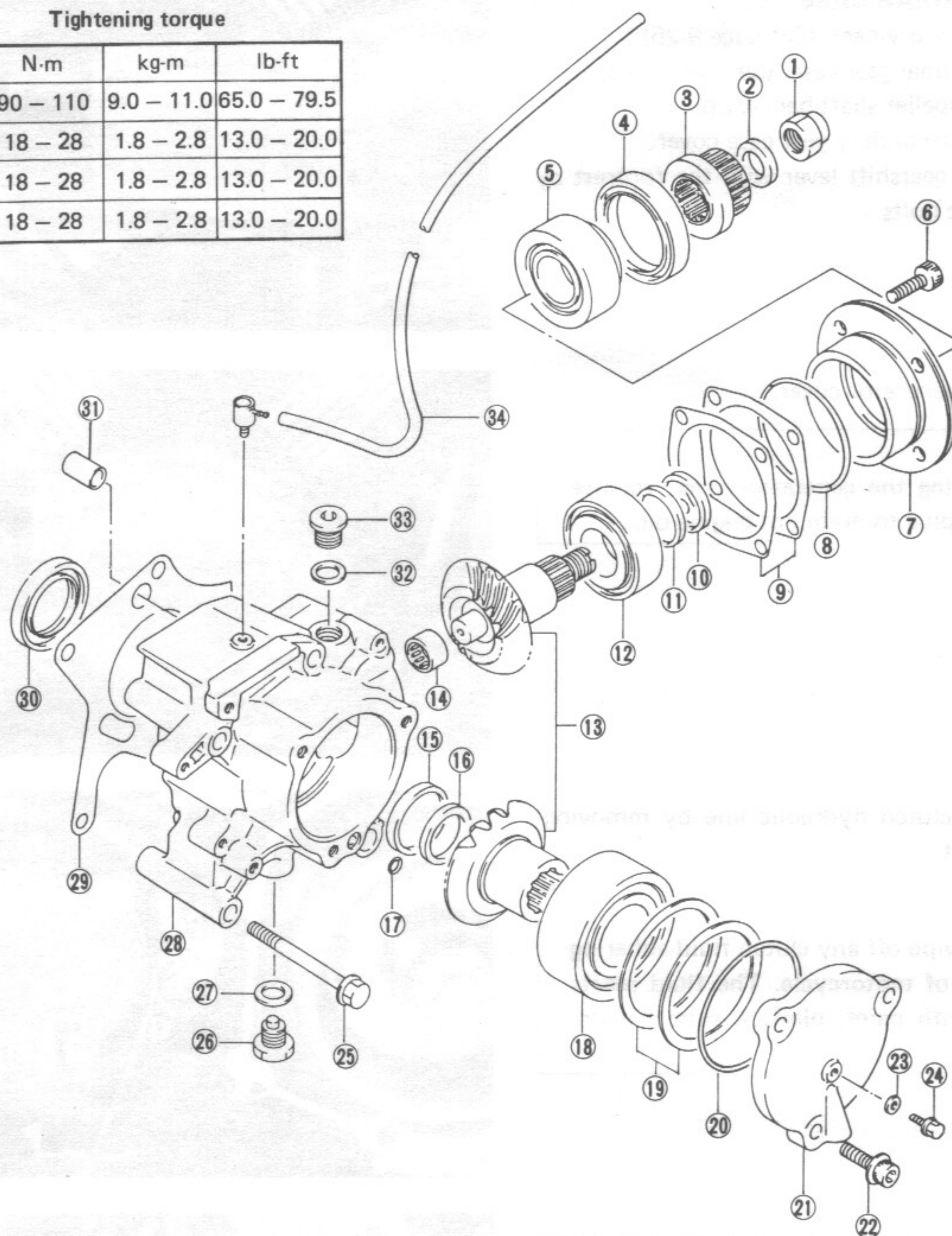

- |                                       |                                    |                        |
|---------------------------------------|------------------------------------|------------------------|
| ① Nut                                 | ⑬ Secondary bevel gear set         | ②⑤ Bolts (5 pcs)       |
| ② Washer                              | ⑭ Pilot bearing                    | ②⑥ Oil drain plug      |
| ③ Secondary driven coupling           | ⑮ Shim seat                        | ②⑦ Gasket              |
| ④ Oil seal                            | ⑯ Shims (19 kinds)                 | ②⑧ Secondary gear case |
| ⑤ Bearing                             | ⑰ O-ring                           | ②⑨ Gasket              |
| ⑥ Bolts (4 pcs)                       | ⑱ Bearing                          | ③① Oil seal            |
| ⑦ Secondary driven bevel gear housing | ⑲ Shims (5 kinds)                  | ③② Dowel pin           |
| ⑧ O-ring                              | ⑳ O-ring                           | ③③ Gasket              |
| ⑨ Shims (5 kinds)                     | ㉑ Secondary drive bevel gear cover | ③④ Oil filler plug     |
| ⑩ Shims (9 kinds)                     | ㉒ Bolts (3 pcs)                    | ③⑤ Breather hose       |
| ⑪ Spacer                              | ㉓ Gasket                           |                        |
| ⑫ Bearing                             | ㉔ Oil level screw                  |                        |



### REMOVAL AND DISASSEMBLY SECONDARY GEAR CASE

- Remove the rear wheel. (See page 9-25)
- Remove the final gear case. (See page 4-22)
- Slide the propeller shaft backward.
- Remove the secondary gear case cover.
- Remove the gearshift lever with the footrest by removing the bolts.

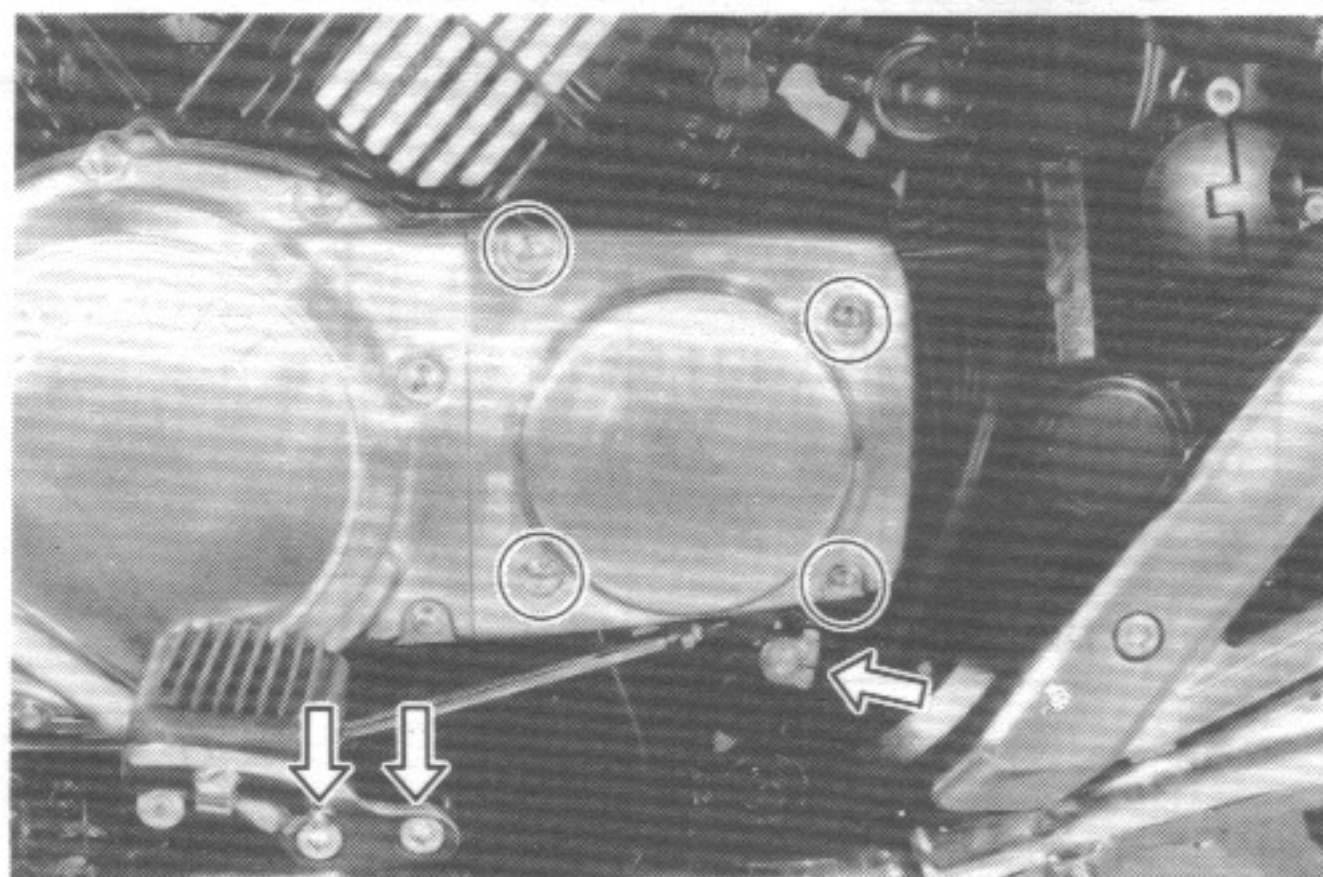

- Remove the generator cover.

**NOTE:**

When removing the generator cover, remove the oil drain plug to drain out engine oil.

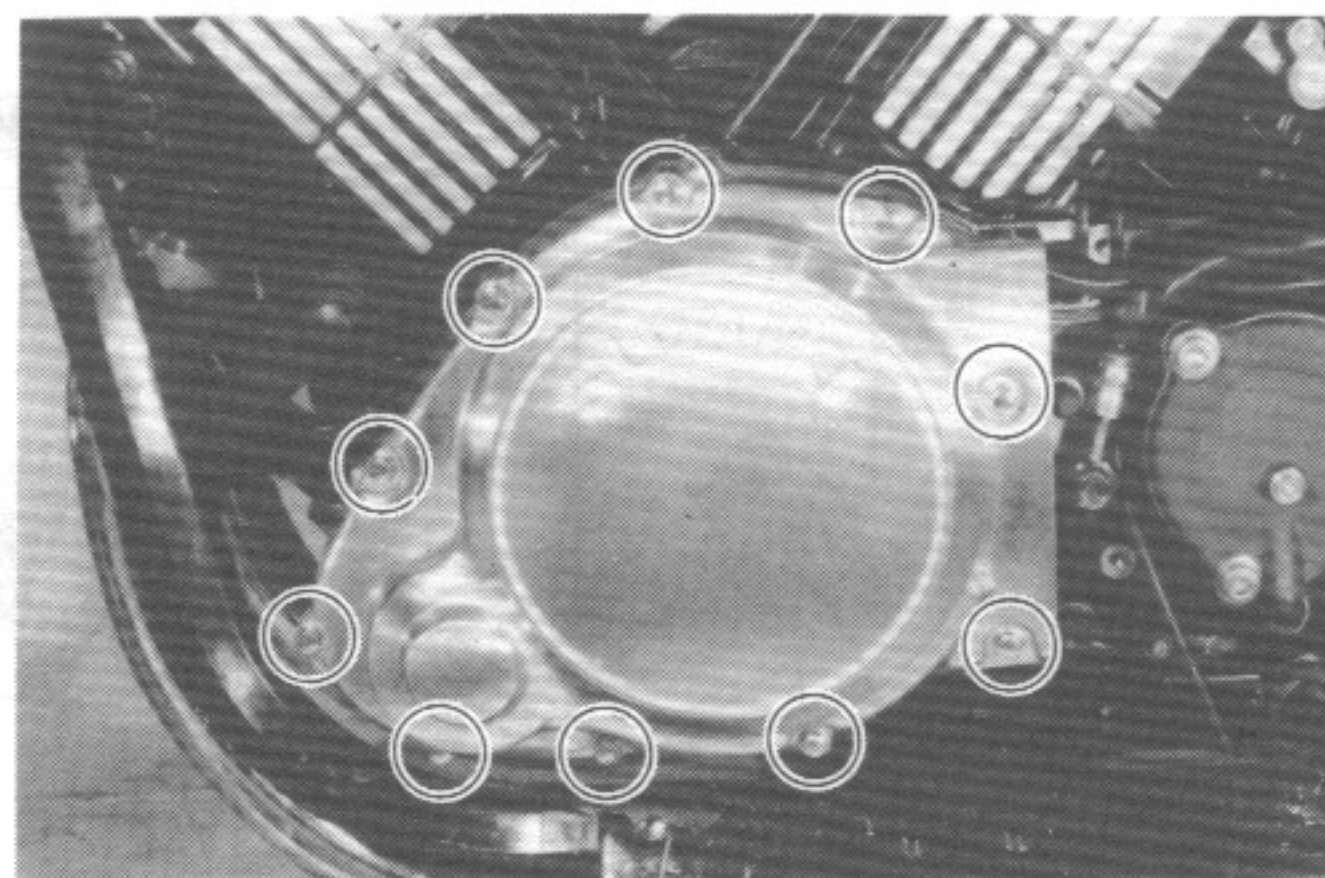

- Remove the clutch hydraulic line by removing the union bolt.

**NOTE:**

Completely wipe off any clutch fluid adhering to any part of motorcycle. The fluid reacts chemically with paint, plastics, rubber materials, etc.

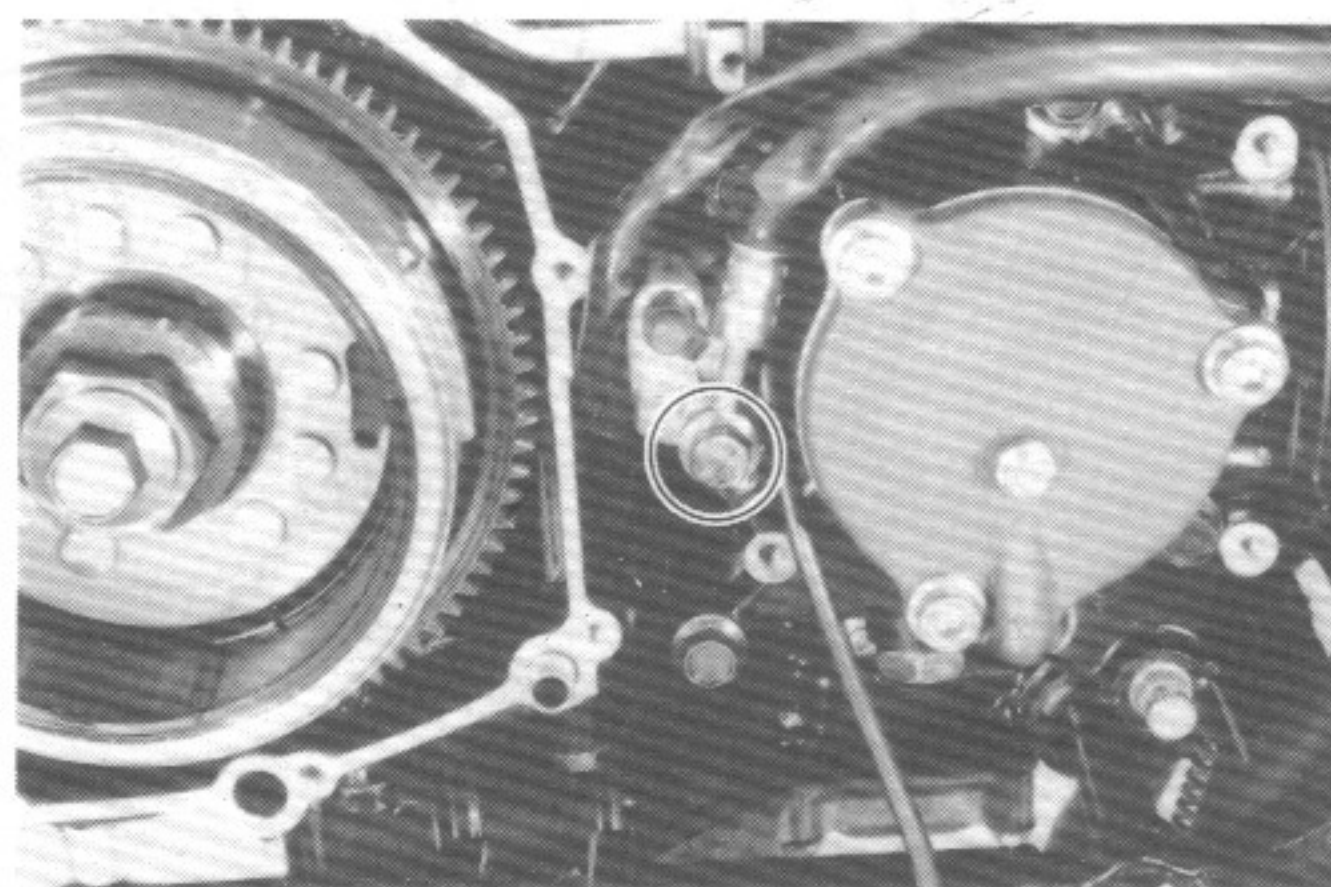

- Loosen the boot clamp and slide the boot from the secondary gear case.
- Place an oil pan under the secondary gear case and remove the oil drain plug to drain out gear oil.
- Remove the secondary gear case from the crankcase by removing the five bolts.

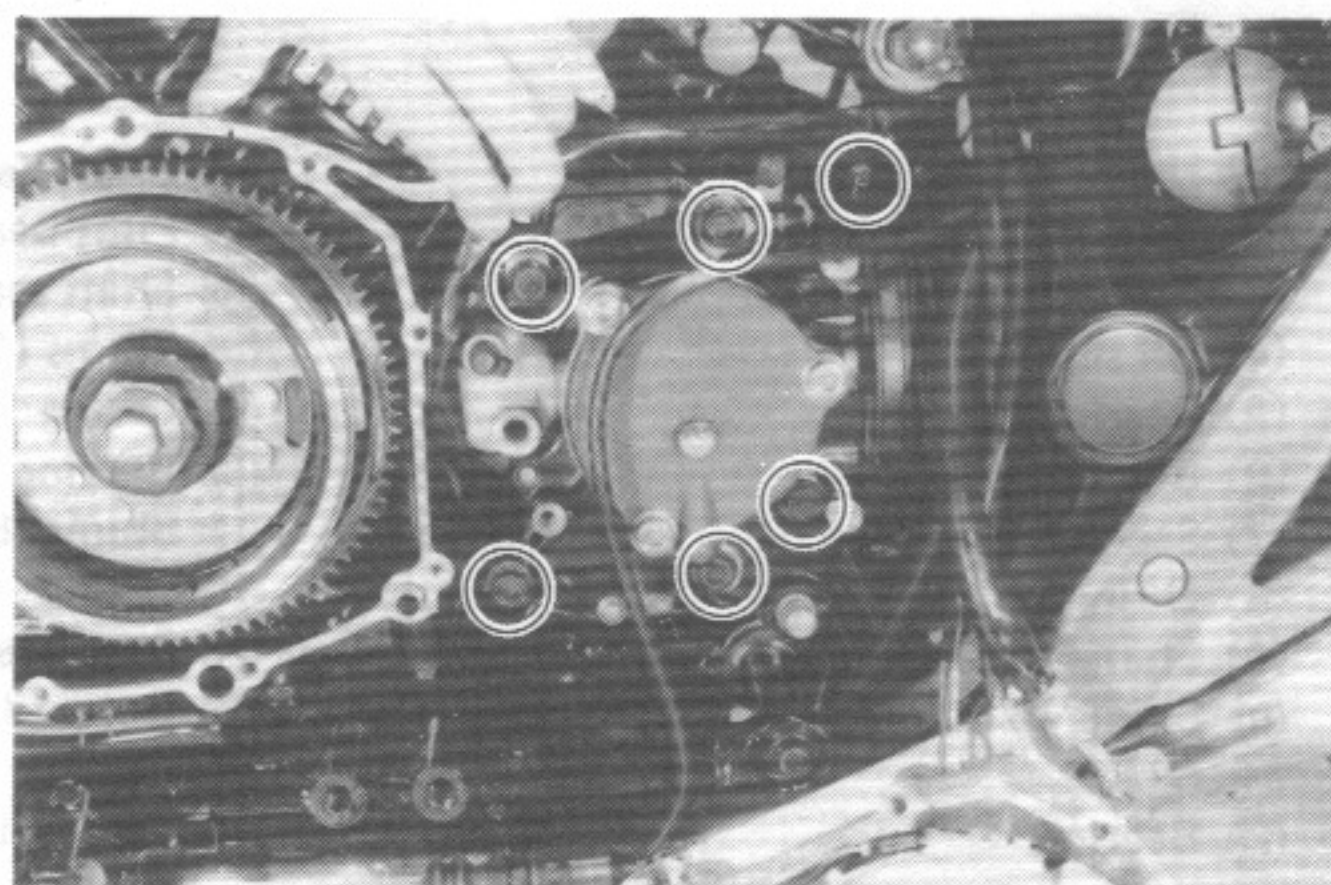



**SECONDARY DRIVE BEVEL GEAR**

- Remove the secondary drive bevel gear cover and shims by removing the three bolts.

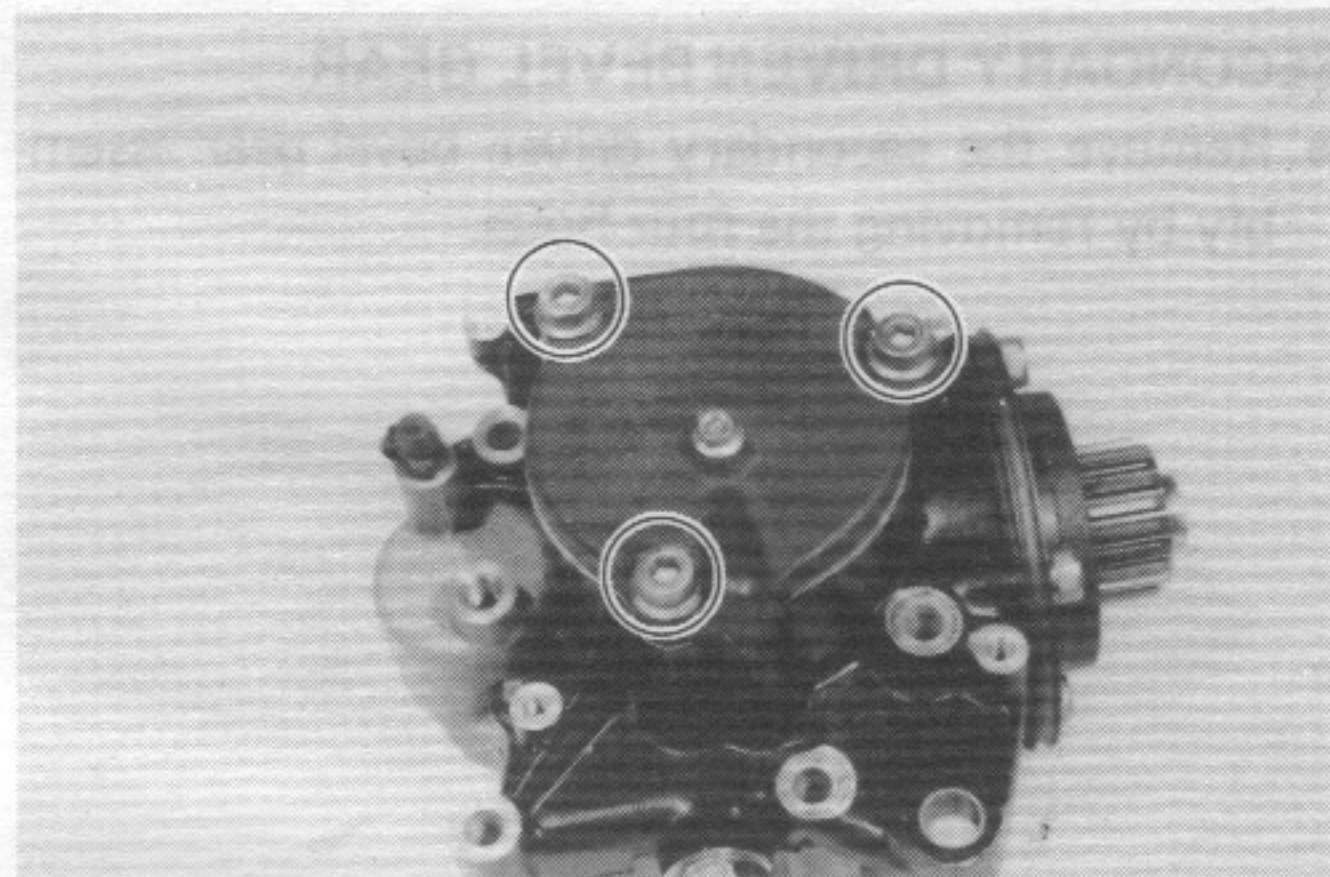

- Remove the O-rings and draw out the bearing with the secondary drive bevel gear.

**CAUTION:**

The removed O-rings should be replaced with new ones.

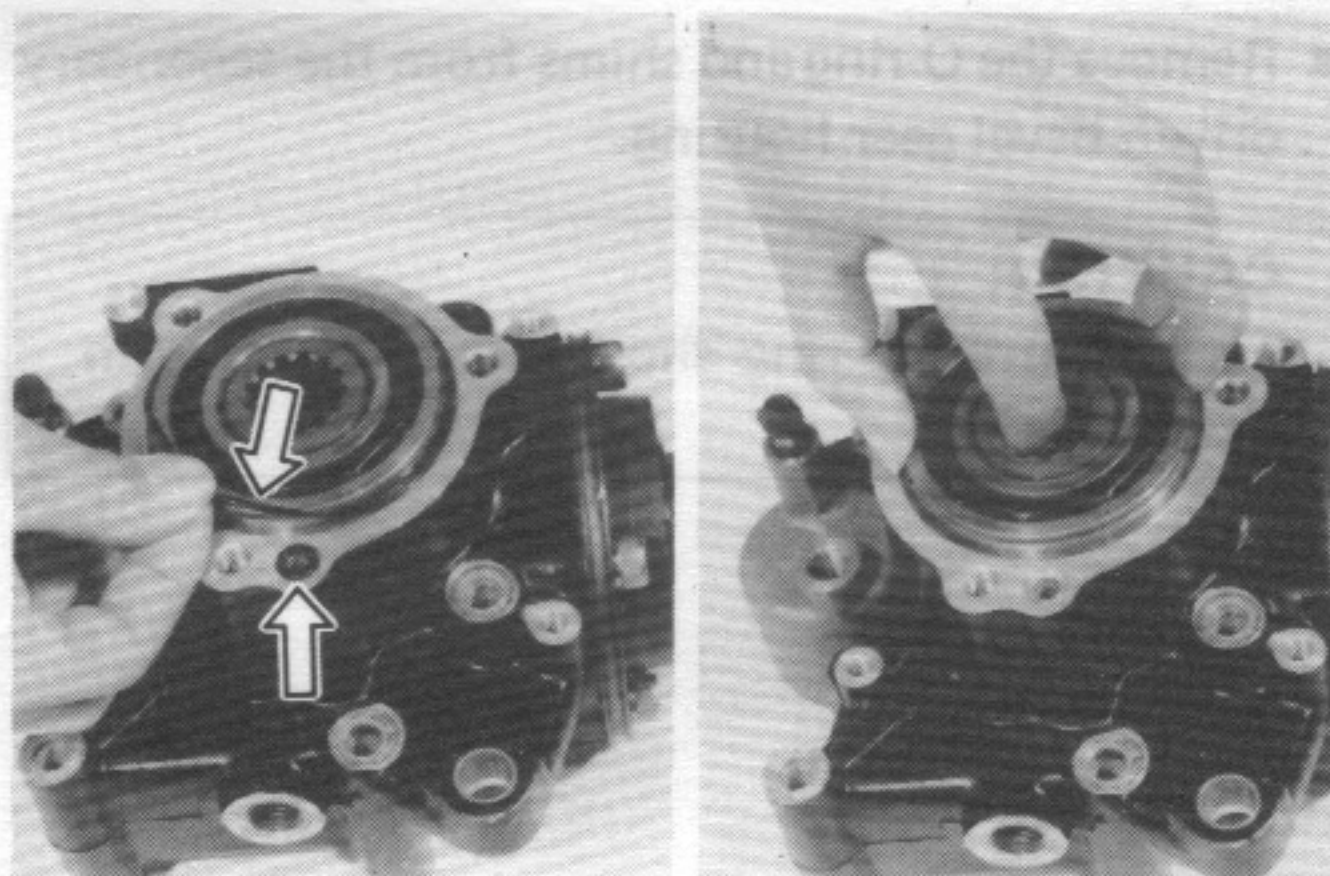

- Remove the secondary drive bevel gear shim.

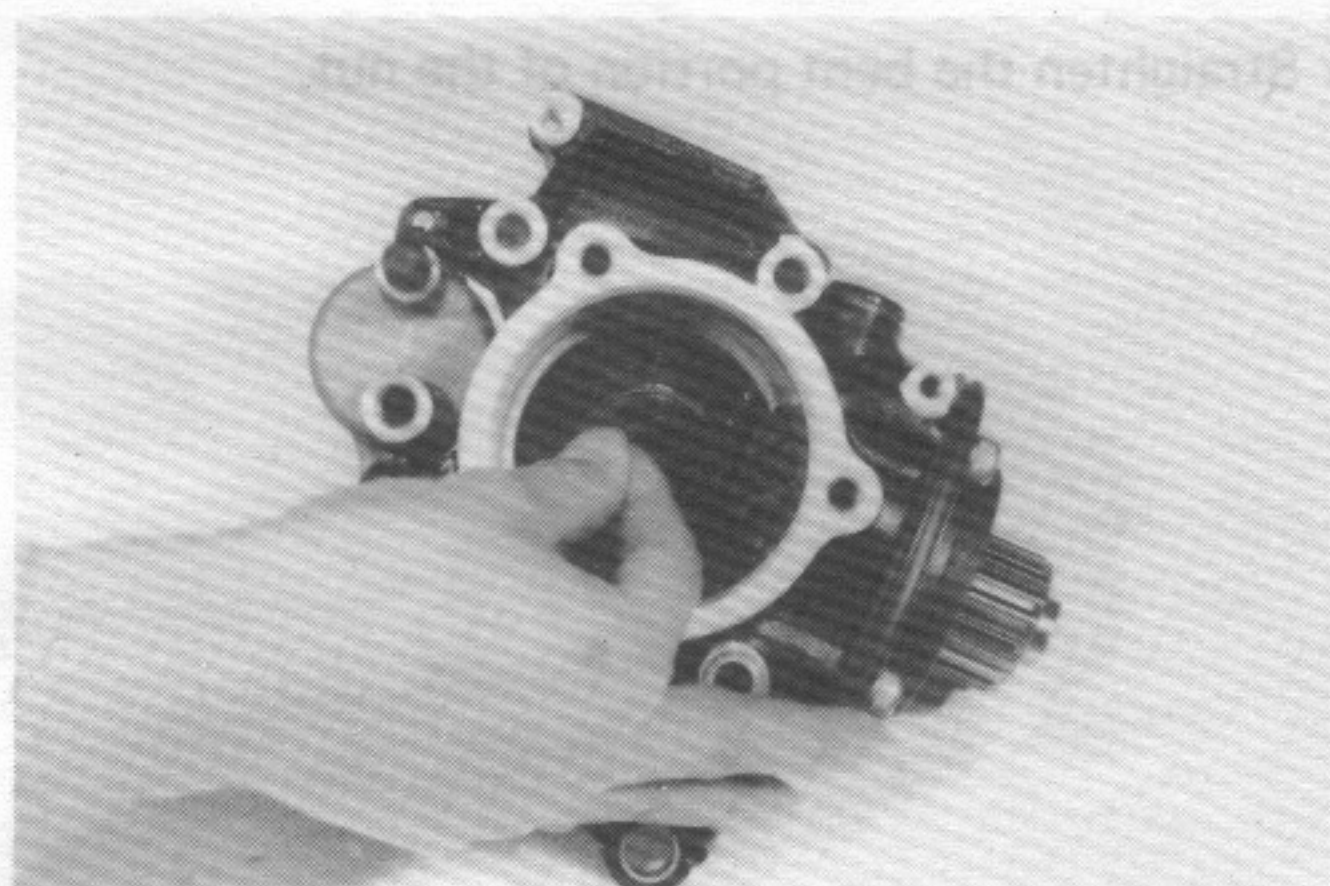

- Draw out the bearing from the secondary drive bevel gear by using the bearing puller and appropriate drift.

09913 - 61510

Bearing puller

