

Unit Repair Overhaul

DISMOUNTING

In Engine Room

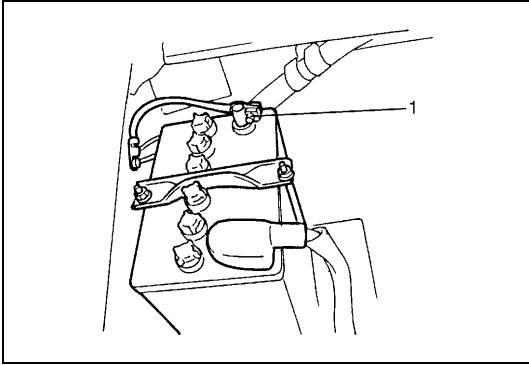

- 1) Disconnect negative cable (1) at battery.

In Cabin

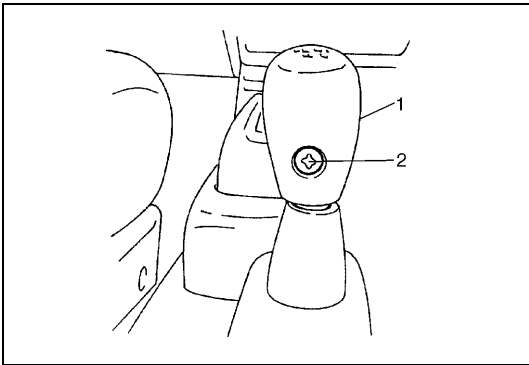

- 1) Remove transfer shift knob (1) by removing screw (2).

On Lift

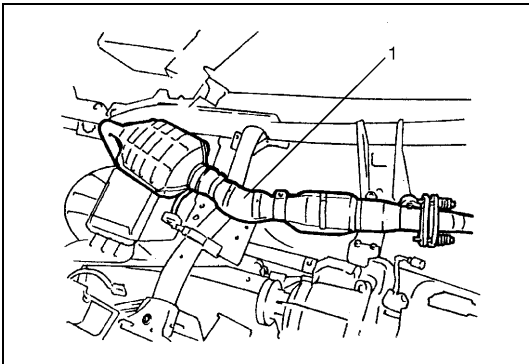

- 1) Drain transfer oil referring to "Oil Change" in this section.
- 2) Remove exhaust pipe (1).

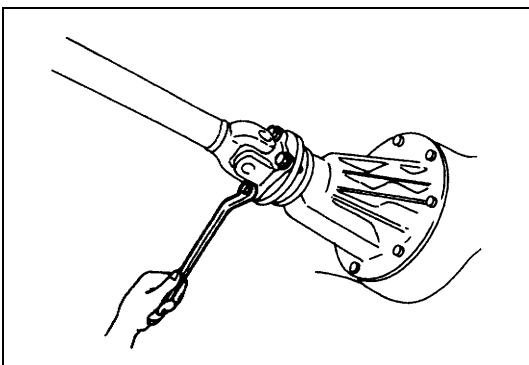

- 3) Give match marks on each joint flange and propeller shaft.
- 4) Remove securing bolts from each flange connection, sever 3 propeller shafts from transfer gear box and suspend propeller shafts with a wire hook or like.

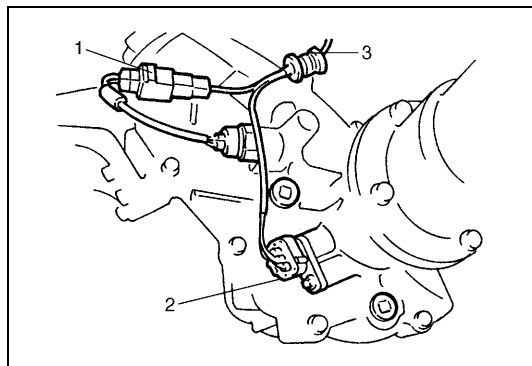

- 5) Disconnect 4WD switch wire at coupler (1) and unclamp harness. Disconnect speed sensor coupler.

2. Speed sensor
3. Clamp

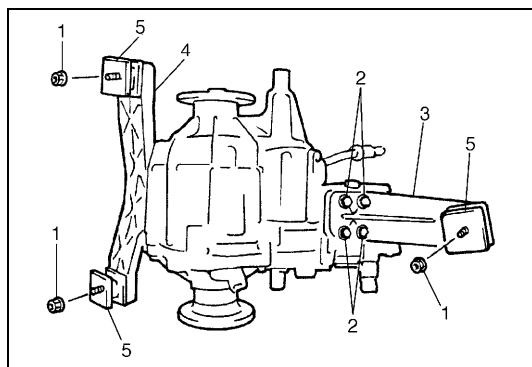

- 6) With transfer supported on jack, remove 3 mounting nuts (1) and 4 bolts (2).
 7) Remove transfer with mountings from body.
 8) Remove mounting from transfer.

3. Mounting right bracket
4. Mounting left bracket
5. Mounting

REMountING

For remounting, reverse dismounting procedure, noting following.

- Use specified torques as given below.

Tightening torque

Transfer mounting nut

(a) : 30 N·m (3.0 kg-m, 22.0 lb-ft)

Transfer mounting bracket bolt

(b) : 23 N·m (2.3 kg-m, 17.0 lb-ft)

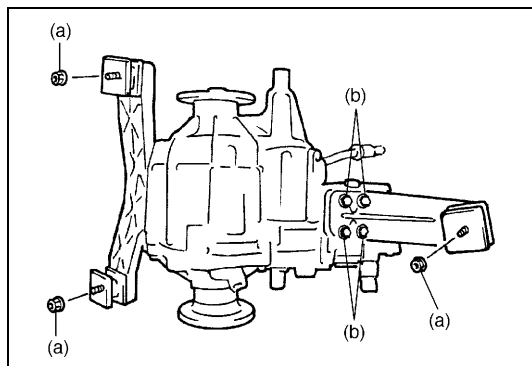

- Set each clamp for wiring securely.
- Connect couplers to speed sensor and 4WD switch securely.
- Pour gear oil to transfer as specified.
- When installing propeller shafts, align the each match marks. For tightening torque of flange bolts, refer to "Propeller shafts" in Section 4B.
- Install exhaust pipe to "Component" in Section 6K.
- Install shift knob.
- Connect battery.

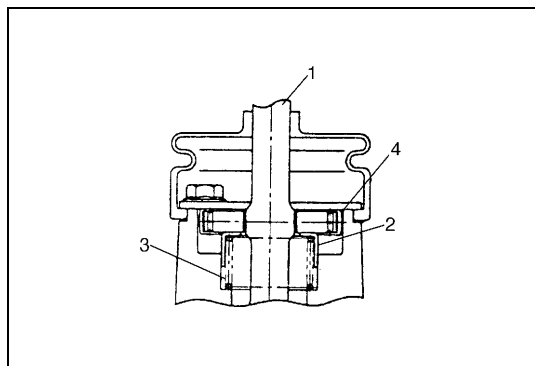
DISASSEMBLY

- 1) Remove boot and then plate, bush (4) and spring (3).
Disconnect gear shift control lever (1).

2. Cap

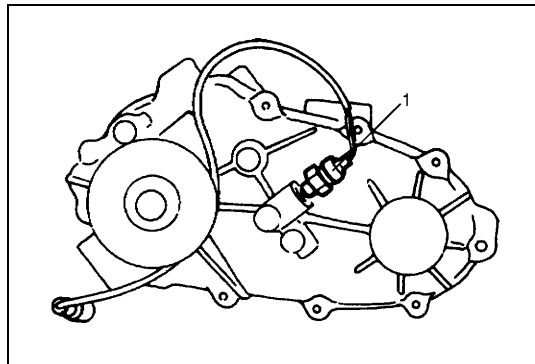

- 2) Remove 4WD switch (1) and take out steel ball.

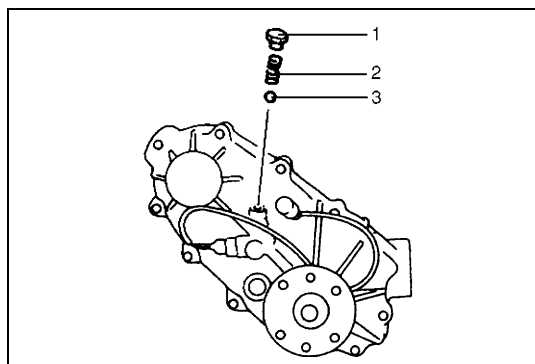

- 3) Remove locating spring bolt (1) and take out locating spring (2) and steel ball (3).

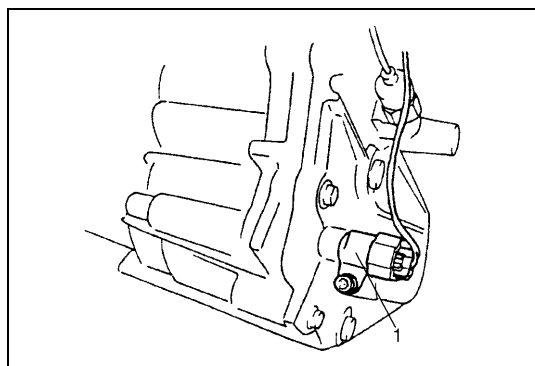

- 4) Remove vehicle speed sensor (1).

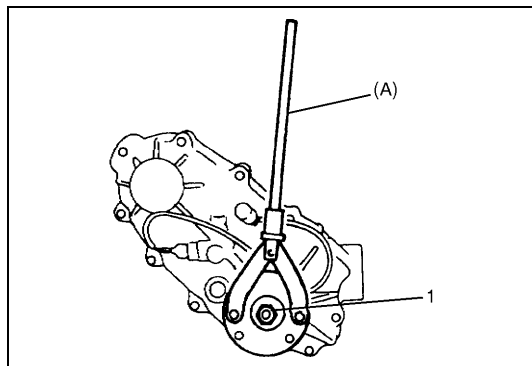

- 5) Remove rear output side flange. To lock flange, use special tool. With flange locked, remove flange nut (1).

Special tool

(A) : 09930-40113

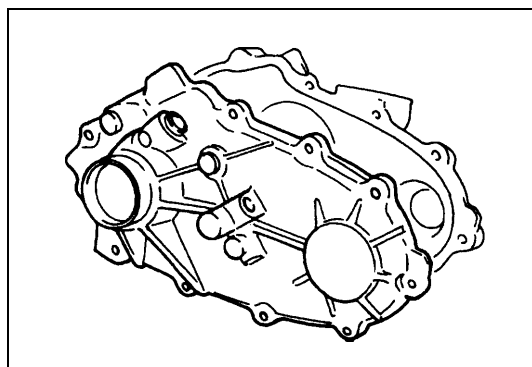

- 6) Remove 11 rear case bolts and then separate case by using special tool.

NOTE:

To separate case, use special tool at 2 points in turn and make opening wider evenly.

Special tool

09912-34501

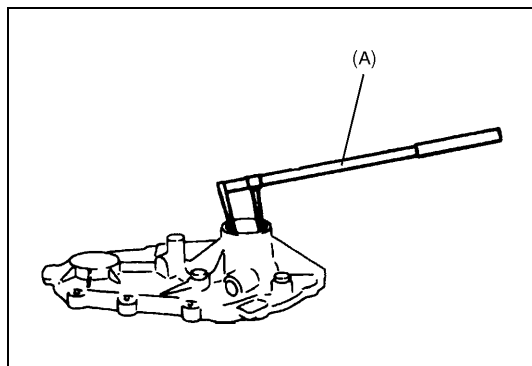

- 7) Remove oil seal from rear case by using special tool.

Special tool

(A) : 09913-50121

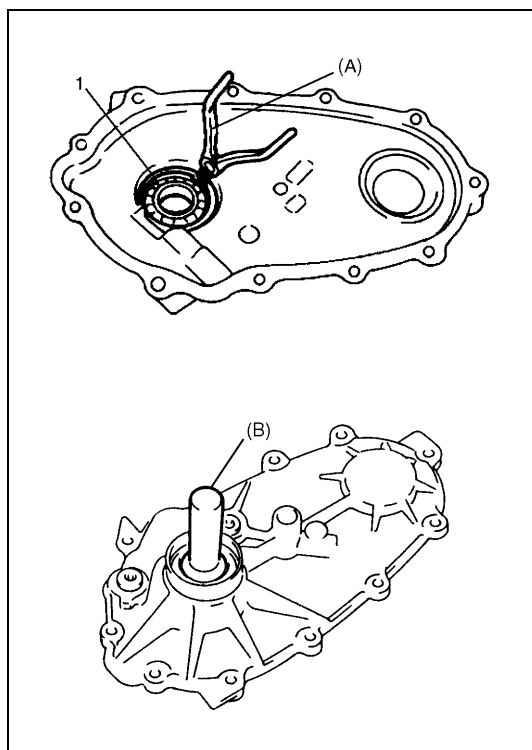

- 8) Remove circlip (1) by using special tool and then remove bearing by using special tool.

Special tool

(A) : 09900-06108

(B) : 09913-75830

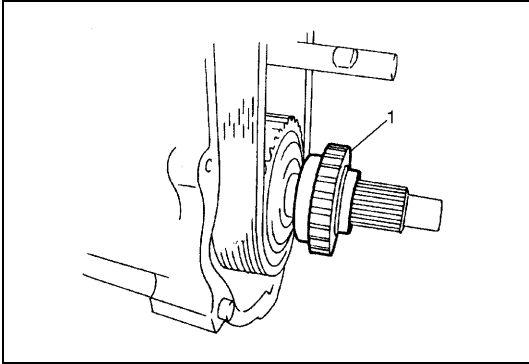

9) Pull out speedometer sensor rotor (1).

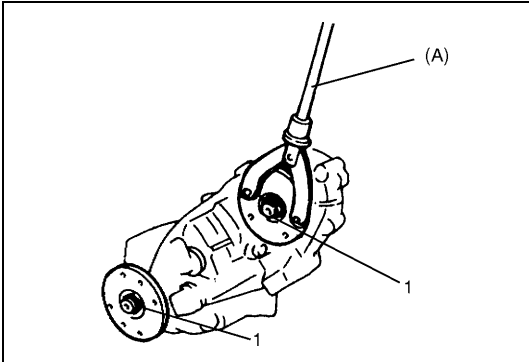

10) Remove flanges. To lock flange, use special tool.
With flange locked, remove flange nut (1).

Special tool
(A) : 09930-40113

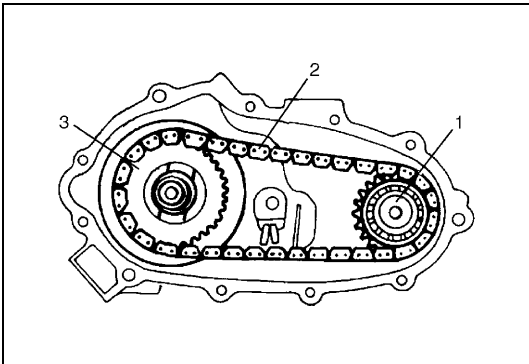

11) Remove drive chain (2), input shaft (1) and ring and sprocket gear assembly (3) as an assembly.

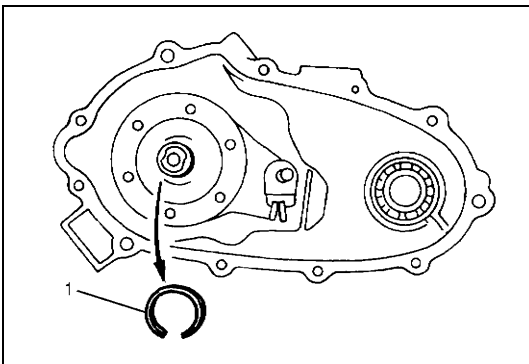

12) Remove needle roller bearing (1).

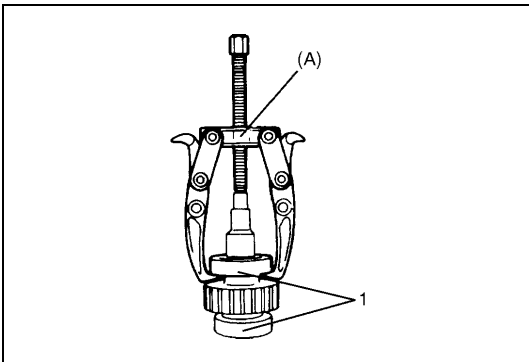

13) Pull out bearings (1) from input shaft by using special tool.

Special tool
(A) : 09913-65135

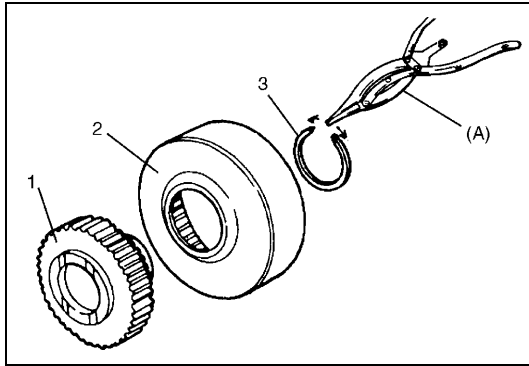

- 14) Disassemble ring and sprocket gear assembly by removing circlip (3).

Special tool

(A) : 09920-76010

1. Sprocket gear
2. Ring gear

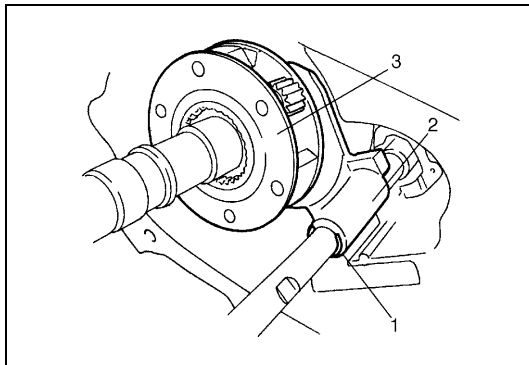

- 15) Remove snap ring (1) and pull out Hi-Lo shift fork (2) and planetary gear assembly (3) as an assembly.

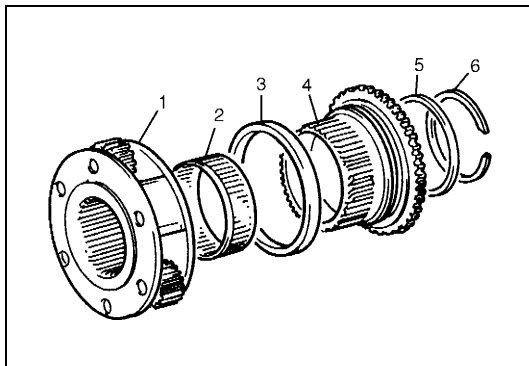

- 16) Disassemble planetary gear unit by removing circlip (6).

1. Planetary gear assembly
2. Needle roller bearing
3. Shift fork spacer
4. Planetary sun gear
5. Thrust washer

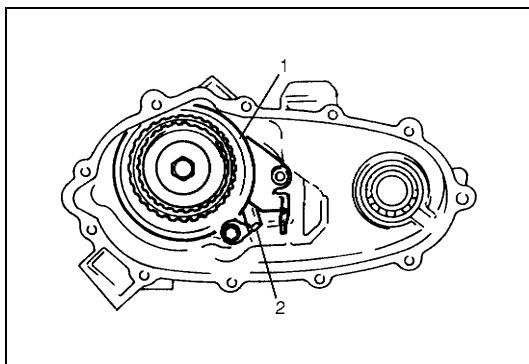

- 17) Remove lock up plate (1) and oil gutter (2) by removing 3 bolts.

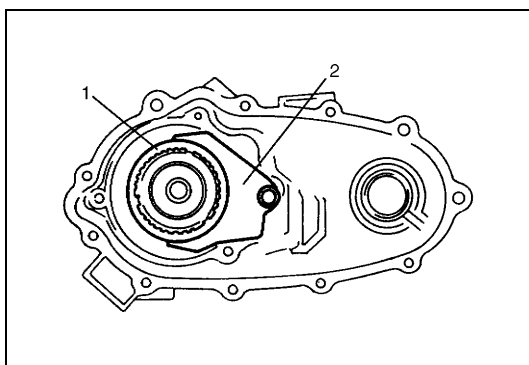

- 18) Remove output rear shaft, shift shaft, reduction clutch sleeve (1) and 2-4 shift fork (2) as an assembly.
Disassemble shift shaft by removing snap ring as necessary.

- 19) Remove synchronizer ring.

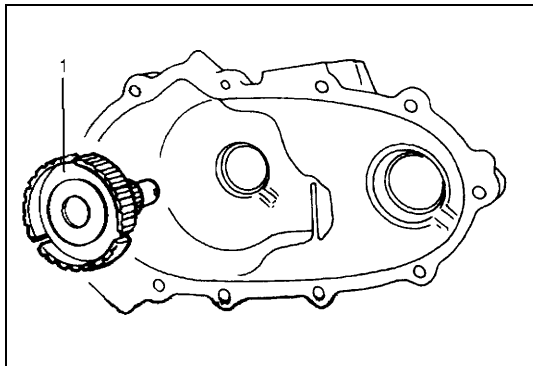

20) Remove output front shaft (1).

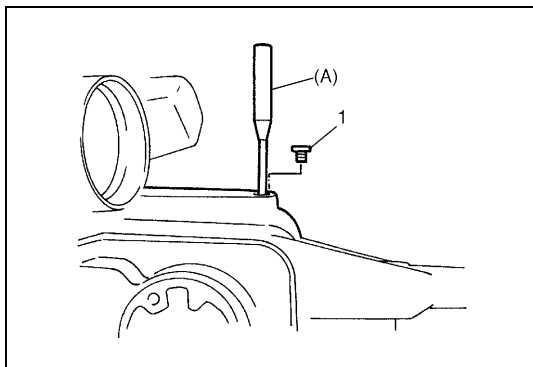

21) Remove screw (1) and drive out pin with special tool.

Special tool

(A) : 09922-85811

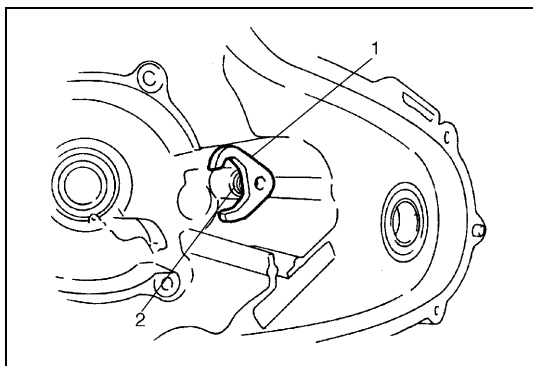

22) Remove interlock block (1) and return spring (2).

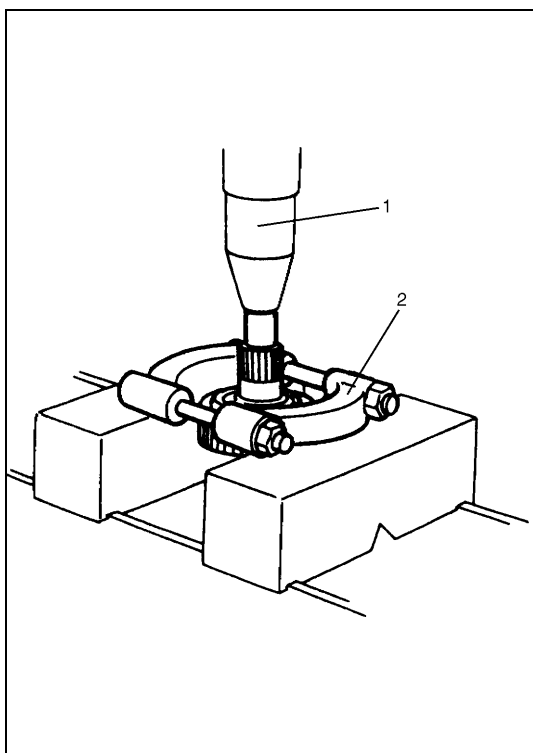

23) By using bearing puller (2) and hydraulic press (1), remove bearing from output front shaft.