

CARBURETOR CONSTRUCTION

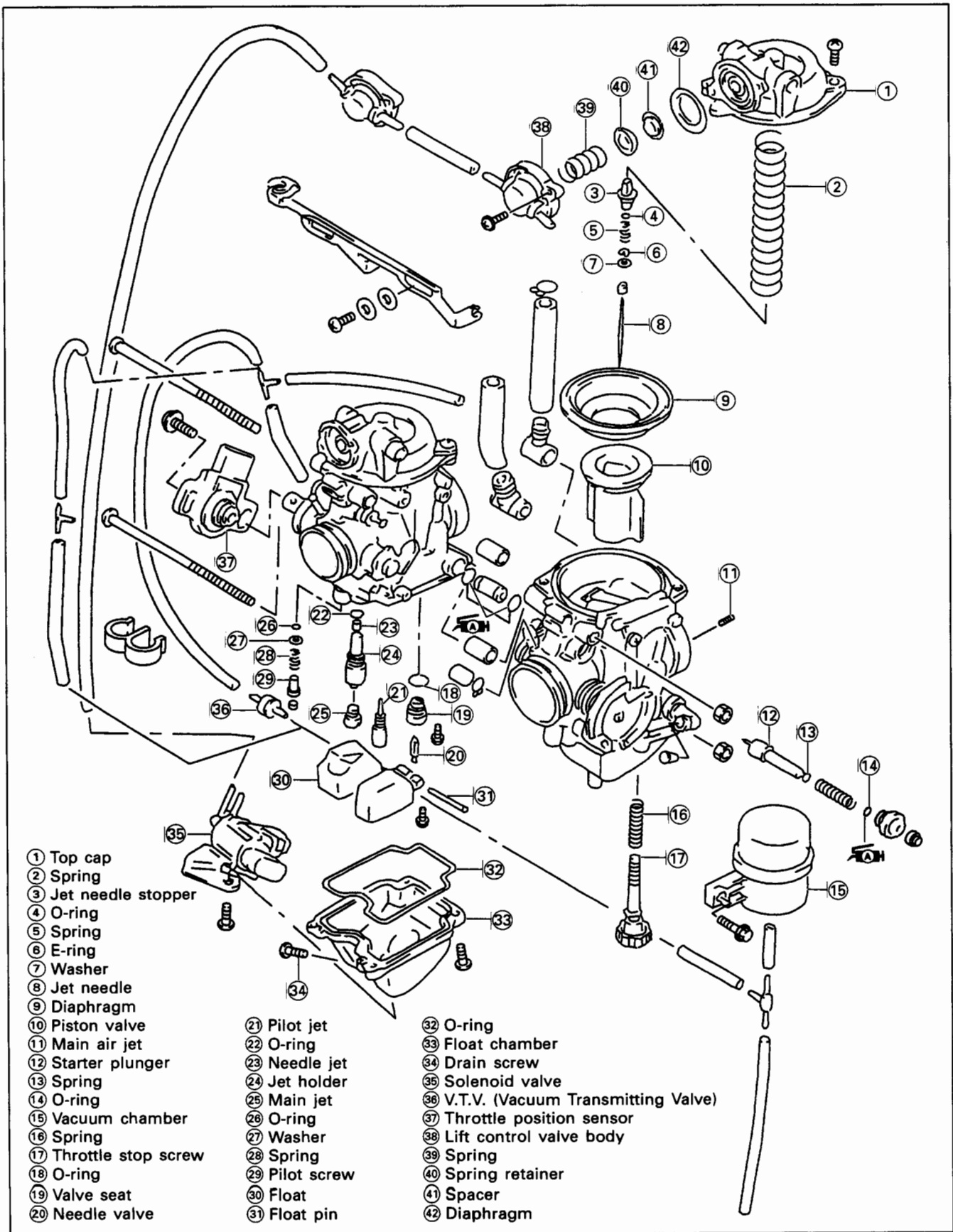

SPECIFICATIONS

ITEM	SPECIFICATION			
	E-02, 04, 17, 22, 24, 25, 34	E-18	U-type E-22	E-37
Carburetor type	MIKUNI BSR32SS	←	←	←
Bore size	32 mm	←	←	←
I.D. No.	04F0	04F1	04F3	04F4
Idle r/min.	1 500 ± 100 r/min.	1 500 ± 50 r/min.	1 500 ± 100 r/min.	←
Float height	13.0 ± 1.0 mm (0.51 ± 0.04 in)	←	←	←
Main jet (M.J.)	#115	←	←	←
Jet needle (J.N.)	5DH23-53-3rd	←	←	←
Needle jet (N.J.)	P-0	←	←	←
Throttle valve (Th.V.)	#90	←	←	←
Pilot jet (P.J.)	#20	←	←	←
Starter jet (G.S.)	#57.5	←	←	#62.5
Pilot screw (P.S.)	PRE-SET (3 turns back)	←	←	←
Throttle cable play (pulling cable)	0.5–1.0 mm (0.02–0.04 in)	←	←	←
Choke cable play	0.5–1.0 mm (0.02–0.04 in)	←	←	←

COUNTRY OR AREA

- | | |
|-------------------|-------------------|
| E-02: U.K. | E-24: Australia |
| E-04: France | E-25: Netherlands |
| E-17: Sweden | E-34: Italy |
| E-18: Switzerland | E-37: Brazil |
| E-22: Germany | |

I.D. NO. LOCATION

Each carburetor has I.D. Number ① printed on the carburetor body according to its specification.

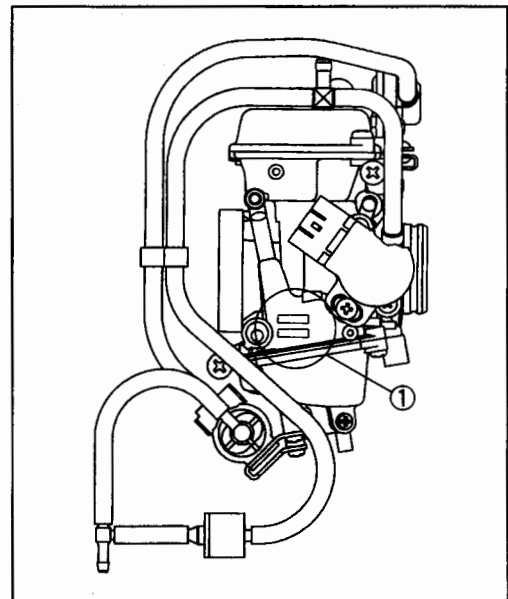

SLOW SYSTEM

This system supplies fuel during engine operation with throttle valve ① closed or slight opened. The fuel from float chamber ② is metered by pilot jet ③ where it mixes with air coming in through pilot air jet ④. This mixture, rich with fuel, then goes up through pilot passage to pilot screw ⑤. A part of the mixture is discharged into the main bore out of bypass ports ⑥. The remainder of mixture is metered by pilot screw ⑤ and sprayed out into the main bore through pilot outlet ⑦.

