

## Swing Gear Case Disassemble and Assemble

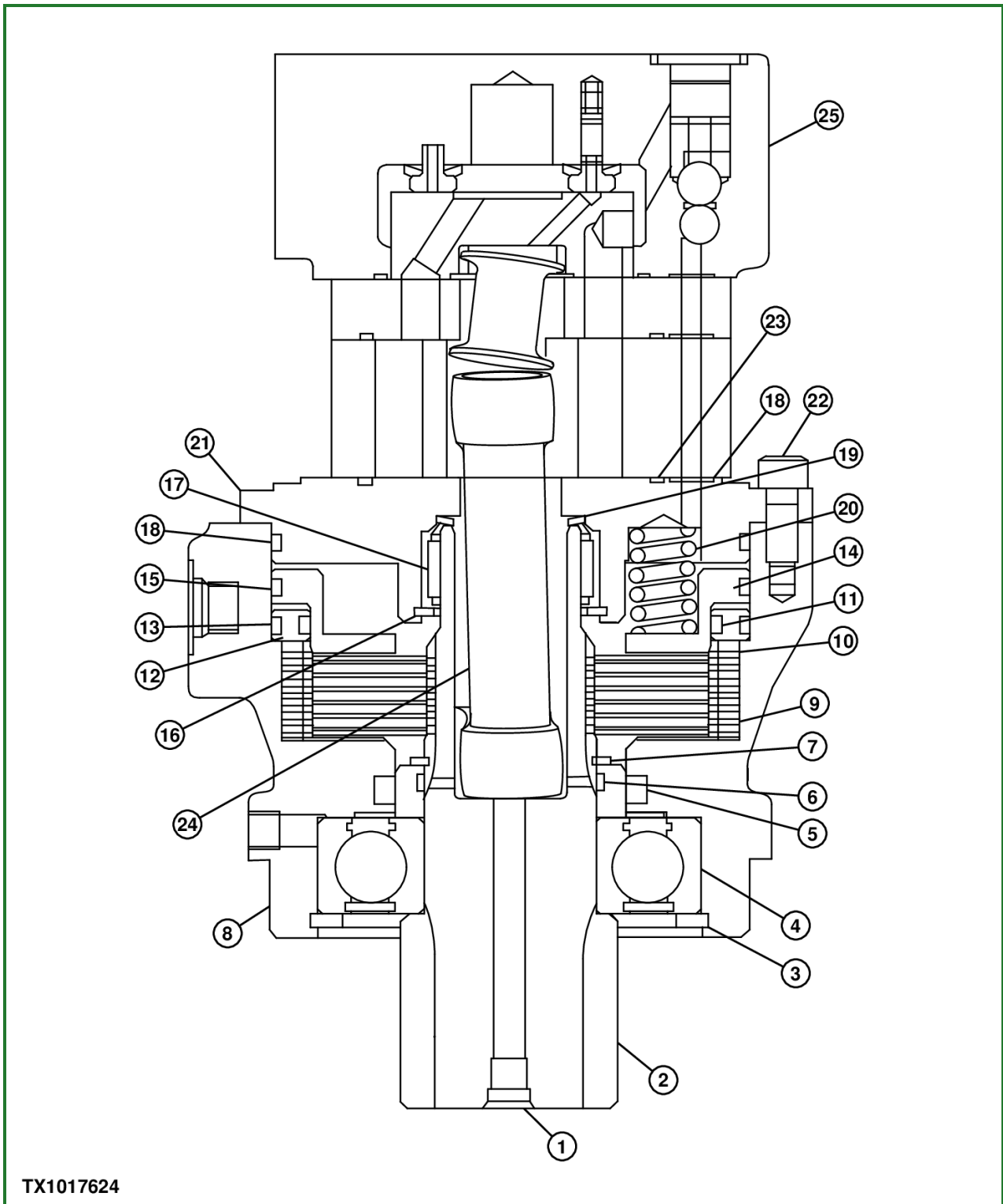

TX1017624-UN: Swing Gear Case-Exploded View

**LEGEND:**

- 1 - Plug (2 used)
- 2 - Pinion Gear
- 3 - Retaining Ring
- 4 - Front Bearing
- 5 - Ring
- 6 - Retaining Ring
- 7 - Friction Plate (6 used)
- 8 - Plate (7 used)

- 9 - O-Ring
- 10 - Piston
- 11 - Spring (8 used)
- 12 - Shaft Seal
- 13 - Socket Head Screw (8 used)
- 14 - O-Ring
- 15 - Swing Motor
- 16 - Flange
- 17 - Rear Bearing
- 18 - O-Ring
- 19 - O-Ring
- 20 - O-Ring
- 21 - Ring
- 22 - Retaining Ring
- 23 - Bearing Housing
- 24 - Drive

1. Remove socket head screws (13). Remove swing motor (15) from gear case.