

Priority Valve and Relief Valve Pressure Test

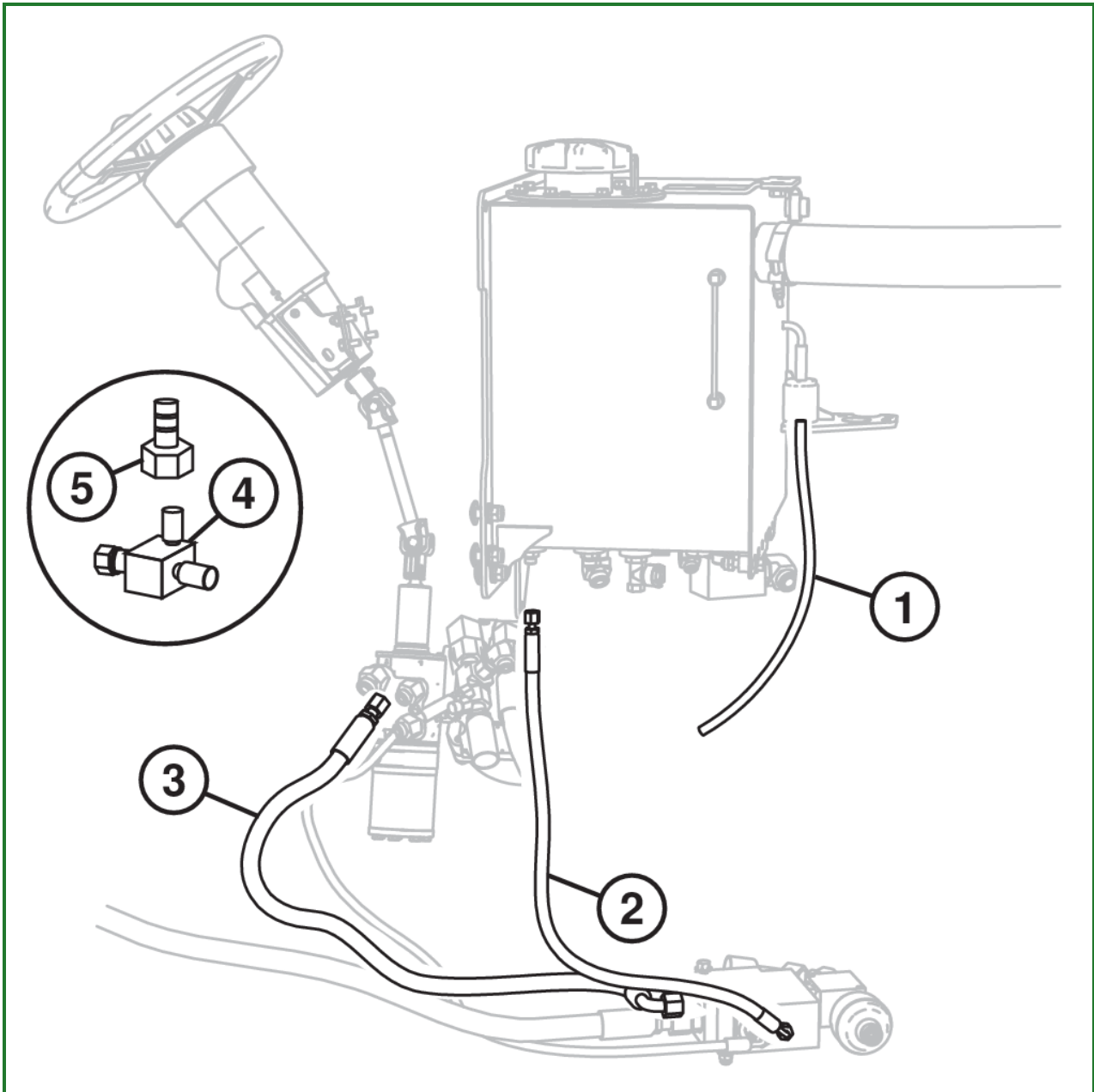

TX1018948-UN: Priority Valve and Relief Valve Pressure Test

LEGEND:

- 1 - Hydraulic Reservoir Breather Hose
- 2 - Priority Valve T Port-to-Hydraulic Reservoir Line
- 3 - Priority Valve-to-Steering Valve Pressure Line
- 4 - 38H1033 Tee
- 5 - JT03485 Special Male Quick Coupler

-: Specifications

SPECIFICATIONS	
Hydraulic Oil Temperature	35—45°C 94—114°F
Engine Speed	2345—2360 rpm
Steering Wheel Force	22 N 5 lb-force

SPECIFICATIONS	
Priority Valve and Relief Valve Relief Pressure	19443—19857 kPa 195—199 bar 2820—2880 psi

-: Essential Tools

ESSENTIAL TOOLS
38H1033 (-12 M x -12 M x -12 F ORFS) (Parker No. 12 R6LO-6) Tee
JT03485 (1/8 M Quick Coupler x -12 F ORFS) Special Male Quick Coupler

-: Service Equipment and Tools

SERVICE EQUIPMENT AND TOOLS
Gauge 35 000 kPa (350 bar) (5000 psi)
7/32 in. Hex Key Wrench

This test will check the priority valve and relief valve for proper operation and correct pressure setting.

1. Install tee (4) in priority valve-to-steering valve pressure line (3) at steering valve.
2. Install JT03485 special male quick coupler (5) to tee (4). Connect hose (3) .
3. Connect gauge.
4. Monitor hydraulic oil temperature on the monitor panel display window or use a temperature reader. [See Monitor Panel Functions](#) . (Operator's Manual.)
5. Monitor engine speed on the monitor panel display window or use a electronic tachometer.
6. Warm hydraulic oil to test specifications. [See Hydraulic Oil Warm-Up Procedure](#) . (Group 9025-25.)

Item	Measurement	Specification
Hydraulic Oil Temperature		35—45°C
		94—114°F

7. Run engine at specification.

Rapidly turn steering wheel in one direction until frames hit stops. Hold frames against stops using approximately 22 N (5 lb-force) on steering wheel.

Item	Measurement	Specification
Engine	Speed	2345—2360 rpm
Steering Wheel Force		22 N 5 lb-force

NOTE:

If steering wheel is turned slowly, it will continue to turn with the frames against stops. This will give an incorrect pressure reading.