

4.

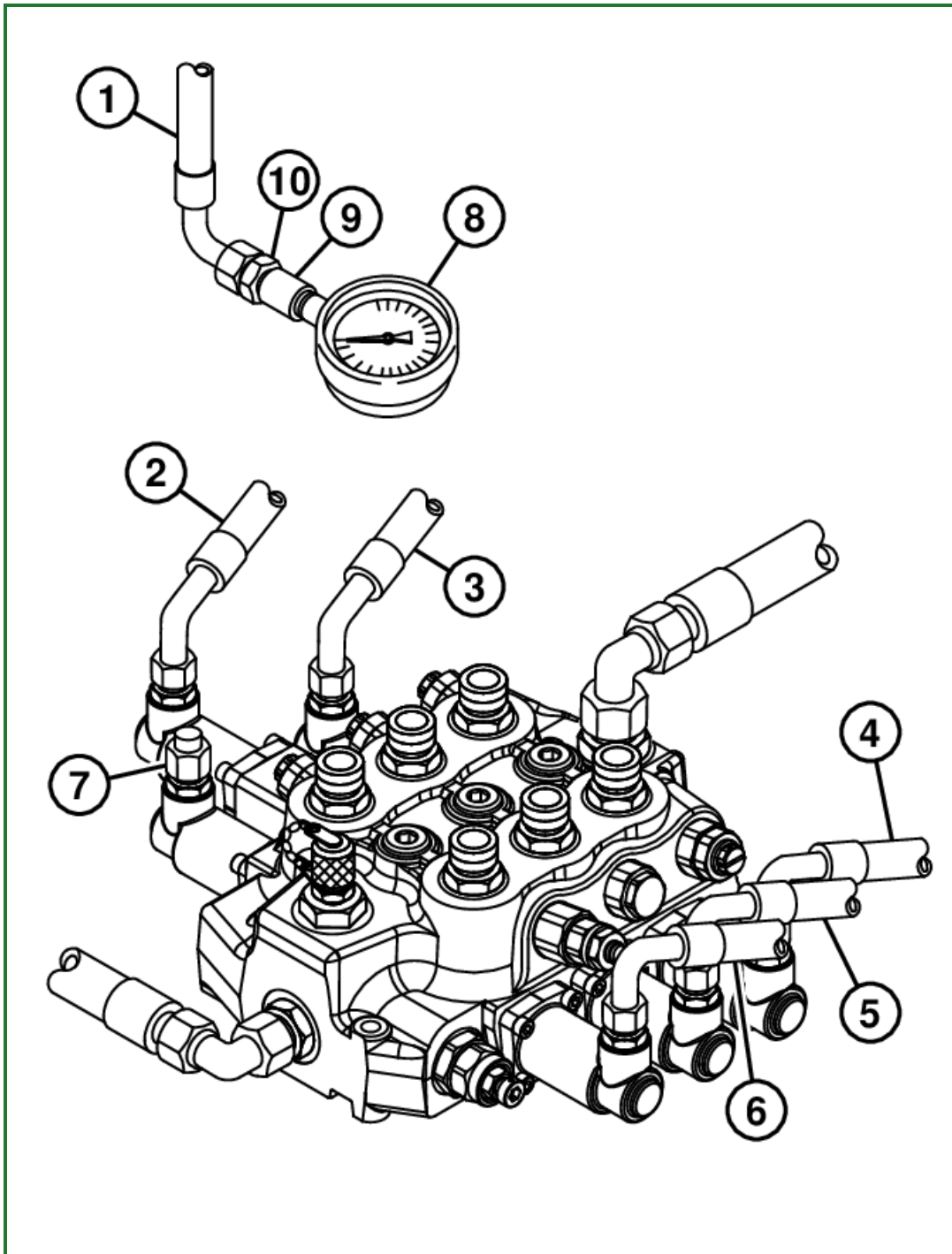

TX1056643-UN: Pilot Hose Test Connections

LEGEND:

- 1 - Bucket Rollback Pilot Hose
- 2 - Boom Raise Pilot Hose
- 3 - Auxiliary Pilot Hose Port B
- 4 - Auxiliary Pilot Hose Port A
- 5 - Boom Lower Pilot Hose
- 6 - Bucket Dump Pilot Hose
- 7 - Cap
- 8 - Gauge
- 9 - Coupling
- 10 - Adapter

Connect JT02156A Digital Pressure and Temperature Analyzer and JT02162 Transducer or gauge (8) to the pilot hose of function to be checked using adapter (10) and coupling (9). Install cap (7) on open valve fitting. [See Digital Pressure and Temperature Analyzer Installation](#) . (Group 9025-25.)

5. Attach JT02165 Thermo-Coupler and JT02156A Digital Pressure and Temperature Analyzer to hydraulic reservoir return fitting or connect Service ADVISOR™ to monitor warm-up. See [Digital Pressure and Temperature Analyzer Installation](#) (Group 9025-25) or see [Service ADVISOR™ Connection Procedure](#) . (Group 9015-20.)
6. [Perform Hydraulic Oil Warm-Up Procedure](#) . (Group 9025-25.)

Item	Measurement	Specification
Hydraulic Oil Temperature		50—60°C 120—140°F

7. Operate engine at specification.

Item	Measurement	Specification
Engine Speed		2850—2950 rpm

8. The “feel point” position is felt on boom lower, boom raise, and bucket rollback functions before entering detent position. As the control lever is moved from neutral, the pilot pressure will suddenly increase as specified at 10—16 mm (3/8—5/8 in.) of lever travel. The pressure should increase smoothly as specified, at the “feel point” position (75% lever travel). Then pressure should increase to specification as the lever is moved into detent.

Item	Measurement	Specification
Feel Point Position—Boom Lower, Boom Raise, and Bucket Rollback at 10—16 mm (3/8—5/8 in.) Lever Travel	Pressure	800 kPa 8 bar 116 psi
Feel Point Position—Boom Lower, Boom Raise, and Bucket Rollback at 75% Lever Travel	Pressure	2000 kPa 20 bar 290 psi
Feel Point Position—Boom Lower, Boom Raise, and Bucket Rollback at Detent	Pressure	3000 kPa 30 bar 435 psi

9. Activate function to be tested and record pilot pressure reading. The pilot pressure reading should be to specification.

Item	Measurement	Specification
Begin Metering Lever Travel	Distance (measured at top of lever)	10—16 mm 3/8—5/8 in.
Boom Float Engagement	Pressure (minimum)	2300 kPa 23 bar 334 psi
Boom, Bucket, and Auxiliary Pilot Pressure	Pressure	2800—3200 kPa 28—32 bar 406—464 psi

10. If pilot pressure is less than specification and charge pressure is within specification:
 - Check for obstruction in lines.
 - Check for proper function of pilot control solenoid.
 - Repair or replace pilot control valve. See [Pilot Control Valve Disassemble and Assemble](#) or see [Pilot Control Valve Remove and Install](#) . (Group 3160.)