

Non-adjustable Circuit Relief Valve Disassemble and Assemble

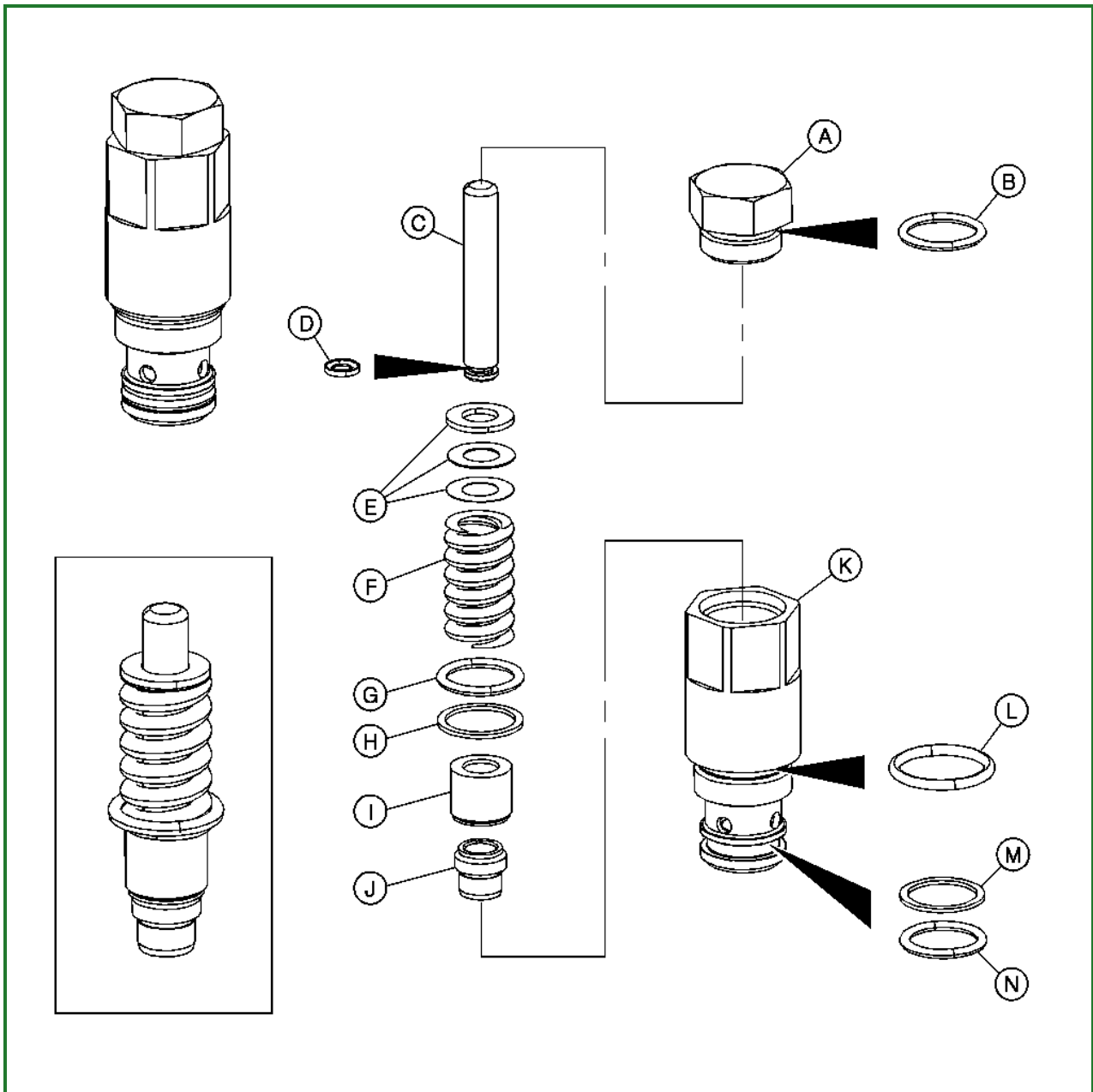

TX1009005-UN: Non-adjustable Circuit Relief Valve

LEGEND:

- A - Cap
- B - O-ring
- C - Rod
- D - Seal
- E - Shims (As required)
- F - Spring
- G - O-ring
- H - Backup Ring
- I - Poppet
- J - Poppet Stem
- K - Valve Body
- L - O-ring
- M - Backup Ring
- N - O-ring

1. The non-adjustable circuit relief valve can be disassembled as shown.
2. Inspect poppet (I) seal for damage.
3. Replace o-rings, backup rings and seals.
4. When installing relief valve on control valve, tighten valve to specified torque.

Item	Measurement	Specification
Non-adjustable Circuit Relief Valve	Torque	100 N·m 75 lb-ft

Go to [Section_38:Group_3860](#)

PM10405,0000471-19-20090916