

## DEFROSTER FAN

### General Information

The defroster fan is attached above on the right hand side of the canopy roof. Used in conjunction with cab, the fan is a visibility aid when fogging is a problem.

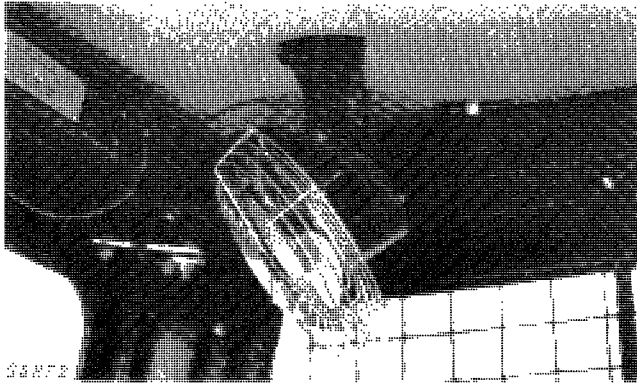

Fig. 4-Defroster Fan Removal

Disconnect fan wires from harness. Remove attaching hardware holding defroster fan to the canopy roof.

### Repair

Replacement parts can be ordered only as a complete fan assembly.

### Installation

Install fan to roof canopy with attaching hardware.

Connect fan wire to wiring harness.

## WINDSHIELD WIPER

### General Information

The windshield wiper is attached to the top of the cab door.

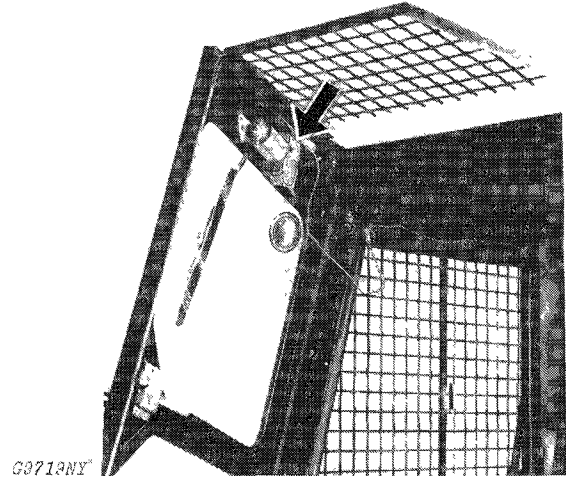

Fig. 5-Windshield Wiper Removal

Disconnect wiper motor wire from wiring harness.

Remove wiper arm and blade from motor.

Remove wiper motor from inside of cab door.

### Repair

Motor replacement parts can be ordered only as a complete assembly.

### Installation

Install wiper motor to inside of cab door.

Connect wiper motor wire to wiring harness.

Install wiper arm and blade to wiper motor on the outside of the cab door.

## INSTRUMENT PANEL

### General Information

The instrument panel is located on the left hand side of the operator's seat. Instruments and indicators are easily accessible for service.

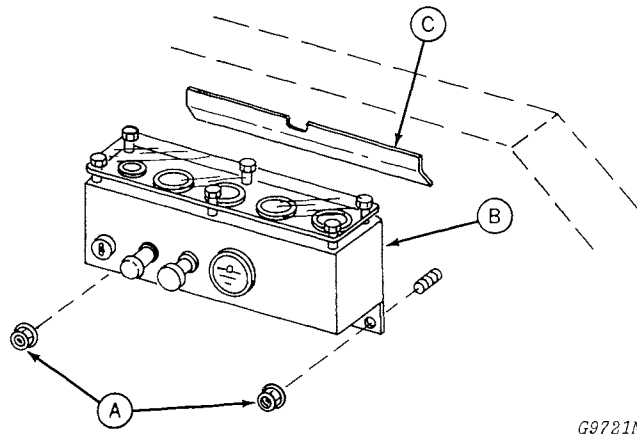

A—Lock Nuts  
B—Instrument Panel  
C—Support Ledge

Fig. 6-Instrument Panel

### Removal

Remove instrument panel by removing two lock nuts, swing panel outward and lift off support ledge.

### Repair

Examine parts for damage and replace if necessary.

### Installation

Reverse removal procedure to install instrument panel.