

## Grapple Rotate Solenoid Valve Disassemble and Assemble

1. Remove grapple rotate solenoid valve. See [Grapple Rotate Solenoid Valve Remove and Install](#) . (Group 3860.)

2.

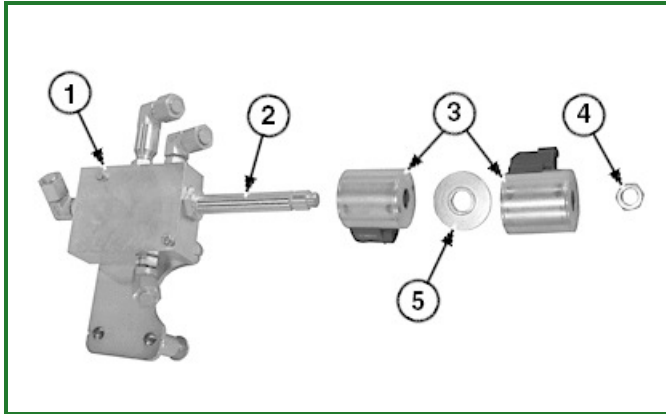

**TX1080241A-UN: Grapple Rotate Solenoid Valve Exploded View**

**LEGEND:**

- 1 - Valve Body
- 2 - Cartridge
- 3 - Coil (2 used)
- 4 - Coil Nut
- 5 - Coil Spacer

Remove coil nut (4) from cartridge (2).

3.

**NOTE:**

*Identify location of coils for ease of installation.*

Remove coils (3) and coil Spacer (5).

4. Remove cartridge from valve body (1).

5. Inspect parts for damage, wear, or contamination. Replace as necessary.

6.

**NOTE:**

*Identify location of O-rings and backup rings for ease of installation.*

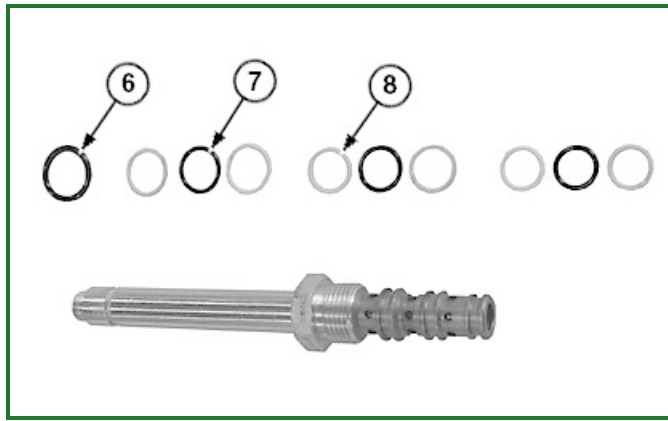

**TX1080240A-UN: Cartridge**

**LEGEND:**

- 6 - Cartridge-to-Valve Body O-Ring
- 7 - O-Ring (3 used)
- 8 - Backup Ring (6 used)

Remove and replace cartridge O-rings (7) and backup rings (8), using petroleum jelly for installation.

7. Install cartridge into valve body. Tighten to specification.

Item	Measurement	Specification
Cartridge Installation Torque	Torque	32.7-35.4 Nm 24-26 lb-ft

8. Install coils and spacer to cartridge.

9. Install coil nut. Torque to specification.

Item	Measurement	Specification
Coil Nut Installation Torque	Torque	9.5—13.6 N·m 7—10 lb-ft

10. Install grapple rotate solenoid valve. See [Grapple Rotate Solenoid Valve Remove and Install](#) . (Group 3860.)

11. Operate grapple through several cycles to remove air trapped in system and to fill components with oil.

12. Check hydraulic oil level. See [Check Hydraulic System Oil Level](#) . (Operator's Manual.)

Go to [Section\\_38:Group\\_3860](#)

NM00125,0000588-19-20101008