

**Boom and Bucket Linkage Remove and Install**

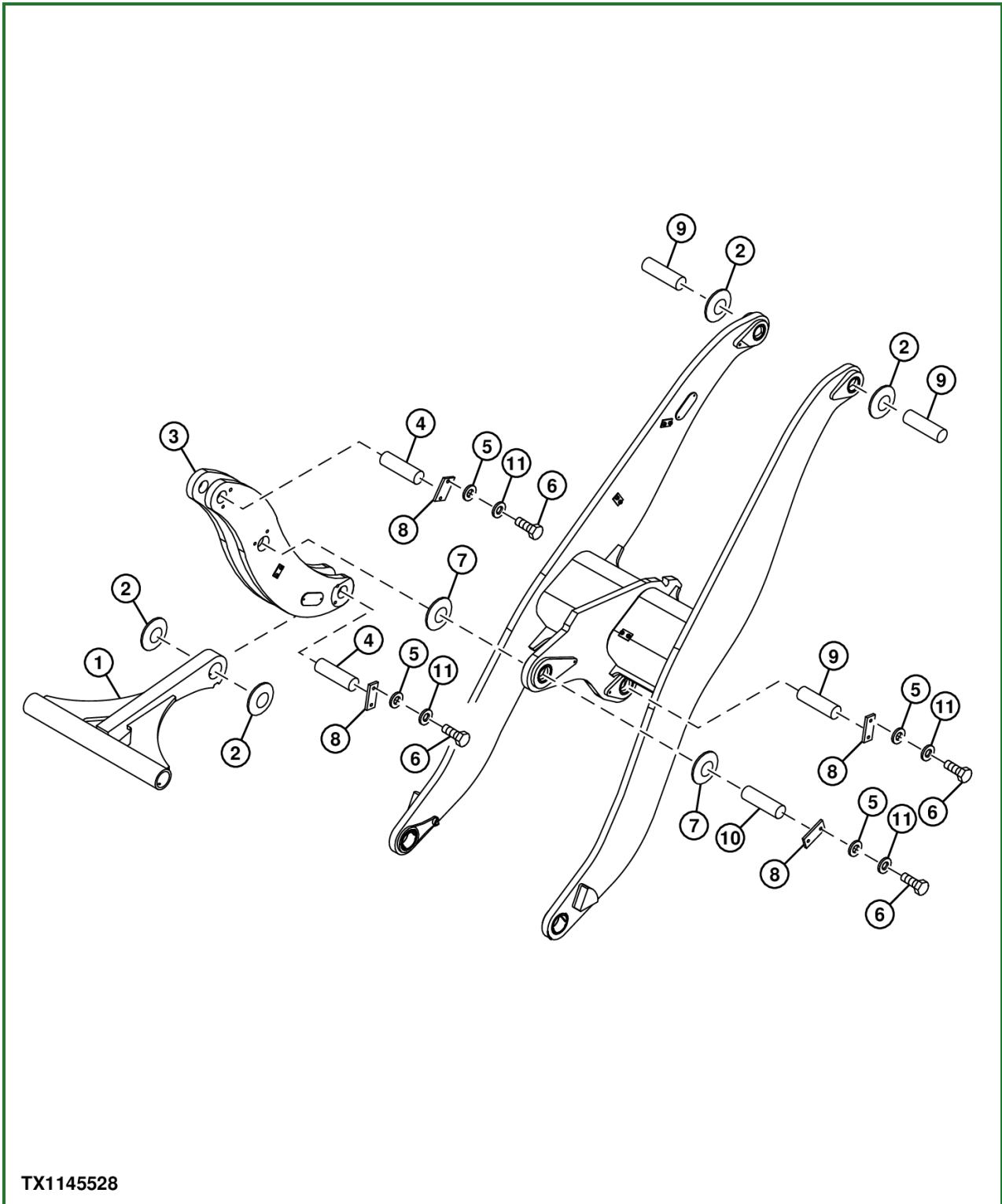

**TX1145528-UN: Bucket Linkage**

**LEGEND:**

- 1 - Lower Bucket Link
- 2 - Shim (4 used)
- 3 - Upper Bucket Link
- 4 - Pin (2 used)
- 5 - Washer (4 used)
- 6 - Cap Screw (4 used)
- 7 - Shim (2 used)
- 8 - Keeper (4 used)

- 9 - Pin (3 used)
- 10 - Pin
- 11 - Lock Washer (4 used)

**-: Specifications**

SPECIFICATIONS	
Bucket Cylinder Weight (approximate)	57 kg 125 lb.
Boom Cylinder Weight (approximate)	84 kg 185 lb.
Lower Bucket Link Weight (approximate)	45 kg 100 lb.
Upper Bucket Link Weight (approximate)	95 kg 210 lb.
Boom Weight (approximate)	399 kg 880 lb.

**-: Other Material**

OTHER MATERIAL
271 Loctite® Thread Lock and Sealer (high strength)
7649 Loctite® Cure Primer

1. Park and prepare machine for service safely. See [Park and Prepare for Service Safely](#) . (Group 0001.)
2. Remove attachment. See [Operating Attachment Mounting System—Quik-Tatch™](#) . (Operator’s Manual.)
3. Remove Quik-Tatch™ . See [Quik-Tatch™ Coupler Remove and Install](#) . (Group 3104.)

4.  **CAUTION:**

*To avoid injury from escaping fluid under pressure, stop engine and relieve the pressure in the system before disconnecting or connecting hydraulic or other lines.*

*Never attempt to relieve hydraulic system pressure by loosening a fitting. Tighten all connections before applying pressure.*

Stop engine. Relieve pressure from hydraulic system. See [Hydraulic System Pressure Discharge Procedure](#) . (Group 9025-25.)

5.  **CAUTION:**

*Prevent possible crushing injury from heavy component. Use appropriate lifting device.*

*Attach hoist to component before removing pins. Removing pins before supporting component could result in personal injury.*