

Repair Boom Valve Section

IMPORTANT:

Keep valve section components together as a matched set.

1.

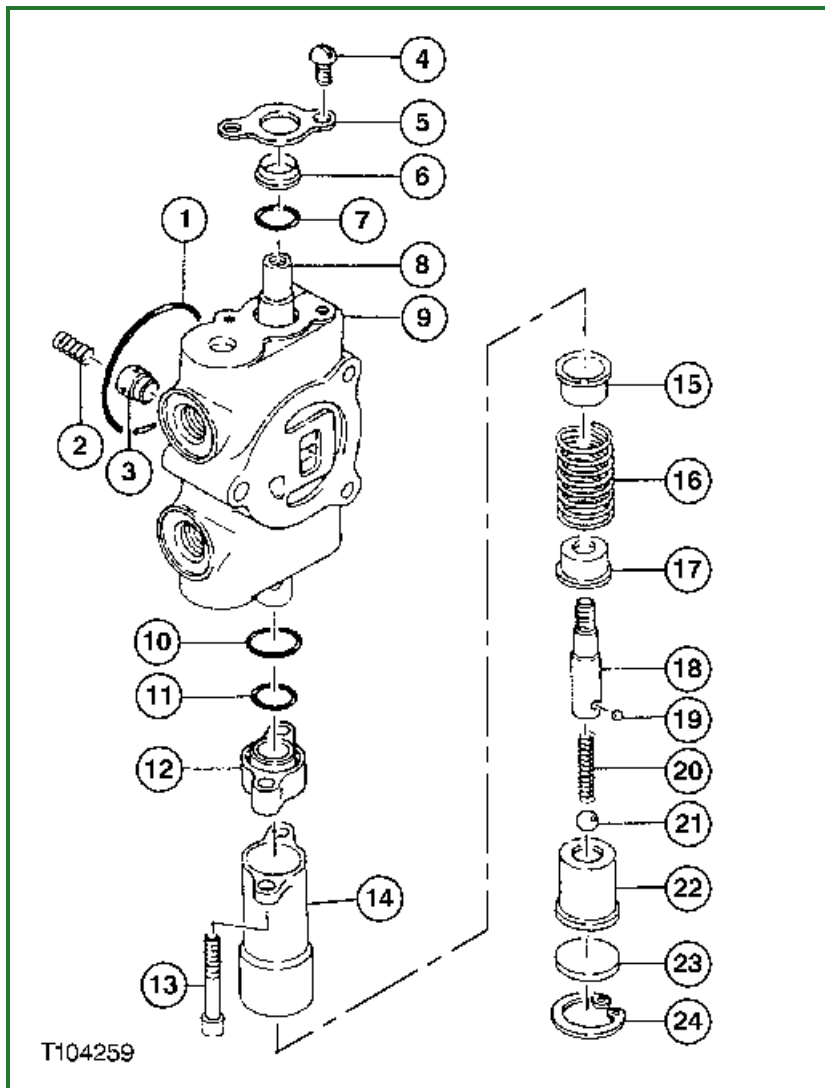

T104259-UN: Boom Valve Section Disassembled

LEGEND:

- 1 - O-Ring
- 2 - Spring
- 3 - Lift Check
- 4 - Cap Screw (2 used)
- 5 - Seal Retainer
- 6 - Wiper Seal
- 7 - O-Ring
- 8 - Spool
- 9 - Boom Valve Section
- 10 - O-Ring
- 11 - O-Ring
- 12 - Spacer
- 13 - Cap Screw (2 used)
- 14 - Cap
- 15 - Spring Guide

- 16 - Spring
- 17 - Spring Guide
- 18 - Spool Pin
- 19 - Detent Ball (4 used)
- 20 - Spring
- 21 - Ball
- 22 - Sleeve
- 23 - Disk
- 24 - Retaining Ring

Remove O-ring (1), spring (2) and lift check (3). Inspect lift check and seat for nicks or pitting. Replace parts as necessary.

2. Remove cap screws (4), retainer (5), wiper seal (6) and O-ring (7).
3. Remove cap screws (13) and pull spool assembly from valve section (9).
4. Remove retaining ring (24) and disk (23). Push in ball (21) with a 3 mm (0.12 in.) diameter wire to remove sleeve (22). DO NOT lose detent balls (19).
5. Disassemble parts (10-21).
6. Check spool and valve section for nicks or scratches. Spool and valve section must be replaced as a set.
7. Apply LUBRIPLATE® Lubricant or an equivalent on springs, spring guides and detent balls.
8. Assemble parts (10-18). Tighten spool pin (18) to 20 N·m (180 lb-in.).

Item	Measurement	Specification
Boom Valve Section:		
Spool Pin Torque		20 N·m (180 lb-in.)

9. Install spring (20) and balls (19 and 21) in spool pin.
10. Push in ball (21) with 3 mm (0.12 in.) diameter wire and install sleeve (22).
11. Install disk and retaining ring.
12. Apply clean hydraulic oil to spool and install spool in valve section. Tighten cap screws (13) to 10 N·m (96 lb-in.).

Item	Measurement	Specification
Boom Valve Section:		
Cap Screw Torque		10 N·m (96 lb-in.)

13. Install O-ring, wiper seal and seal retainer. Tighten cap screws (4) to 2.7 N·m (24 lb-in.)

Item	Measurement	Specification
Boom Valve Section:		
Seal Retainer Cap Screw Torque		2.7 N·m (24 lb-in.)

14. Apply clean hydraulic oil to lift check and install lift check and spring.