

CABLE ROUTING

SPEC

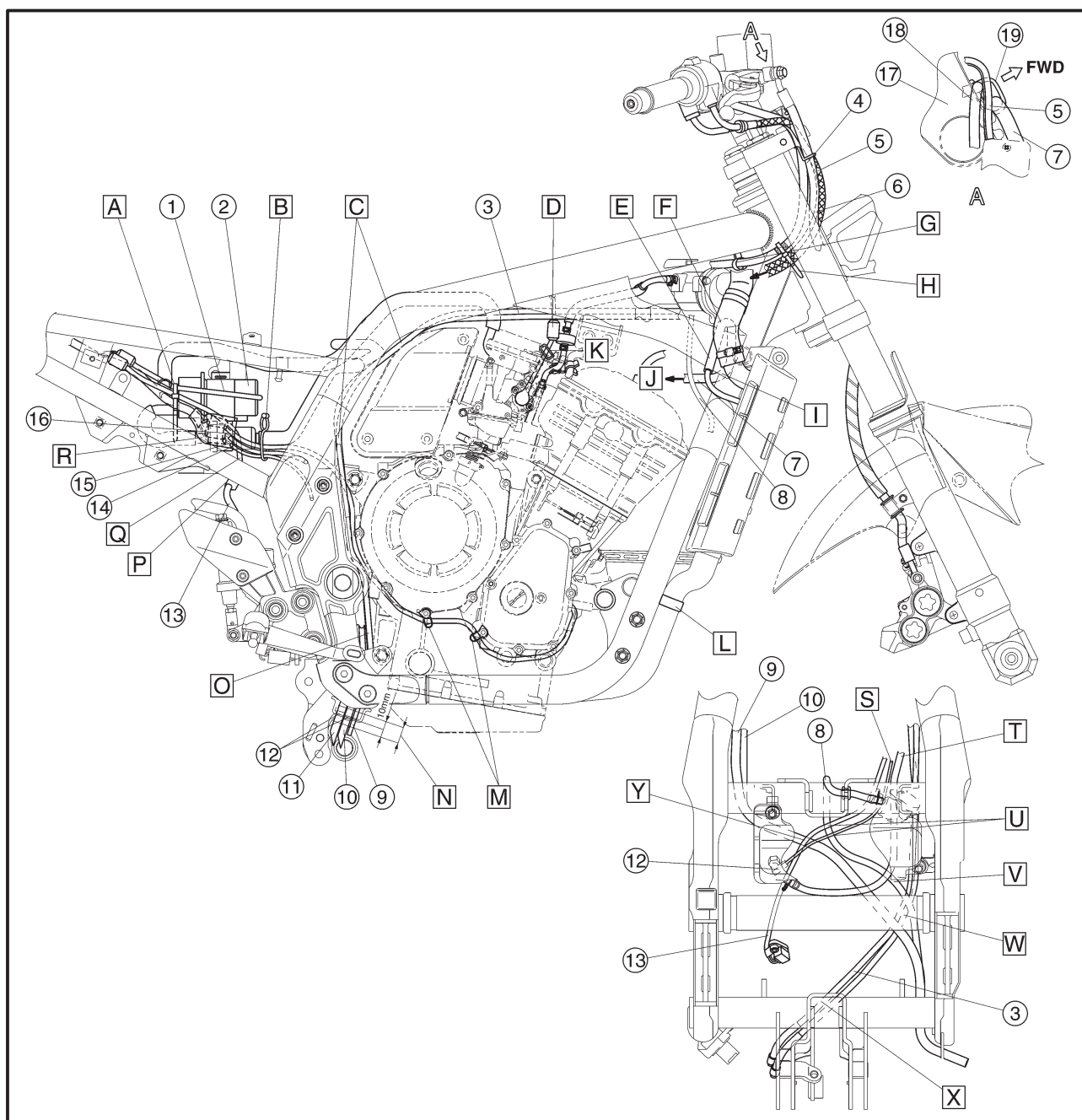

- I Route the water-carburetor hose between the frame cross pipe and fan motor lead.
- J To the carburetor
- K Fasten the T.P.S. lead with a steel clamp.
- L Fasten the coolant hose with a plastic band.
- M Fasten the pickup coil lead with a steel clamp.
- N Pass the coolant reservoir tank overflow hose, fuel tank drain hose and fuel tank breather hose through the frame hose holder from the inside of the vehicle to the outside. At this time, pull the fuel tank drain hose and fuel tank breather hose so that the white paint marks are within a 20 mm range.
- O Route the EXUP cable forward the another hoses, and upward the engine mounting bracket.
- P Fasten the rear brake light switch lead with a plastic guide.
- Q Insert the all couplers into the rubber cover.
- R Route the rear brake light switch lead inside the another leads.
- S Route the neutral switch lead and speed sensor lead left side the coolant reservoir hose.
- T Route the coolant reservoir hose left side the engine mounting bracket.
- U Route the coolant reservoir hose forward the neutral switch lead and speed sensor lead.
- V Route the coolant reservoir hose backward the another hoses.
- W Route the EXUP cable forward the another hoses.
- X Route the EXUP cable forward the frame cross pipe.
- Y Route the fuel tank drain hose and fuel tank breather hose forward the neutral switch lead and speed sensor lead.



CABLE ROUTING

SPEC



- ① Starter cable
- ② Clutch cable
- ③ Handlebar switch lead (left)
- ④ Main switch lead
- ⑤ EXUP servo motor
- ⑥ Starting circuit cutoff relay
- ⑦ Starter motor lead
- ⑧ Fan motor relay
- ⑨ Air cleaner case drain hose
- ⑩ Sidestand switch lead
- ⑪ oil level switch lead
- ⑫ ACgenerator lead
- ⑬ Water-head pipe
- ⑭ Water-carburetor hose
- ⑮ Throttle cable 2
- ⑯ Throttle cable 1
- ⑰ EXUP cable

- A Fasten the main switch lead and handlebar switch lead with a plastic guide.
- B Fasten the water-head hose and water-carburetor hose with a plastic band.
- C Fasten the clutch cable with a plastic band.
- D Fasten the clutch cable with a steel clamp.
- E Fasten the wire harness with a plastic band.
- F To the fuel sender.
- G Route the fuel sender lead inside the seat rail.
- H Route the battery negative lead forward the frame stay.
- I Route the main harness inside the rear fender groove.
- J Fasten the wire harness, sidestand switch lead, oil level switch and flame with a plastic band. Do not fasten the Acgenerator lead (white).
- K Route the starter motor lead and battery negative lead inside the plastic band.
- L Route the all hoses outside the fuel hose.
- M Route the fuel hose through the steel guide.

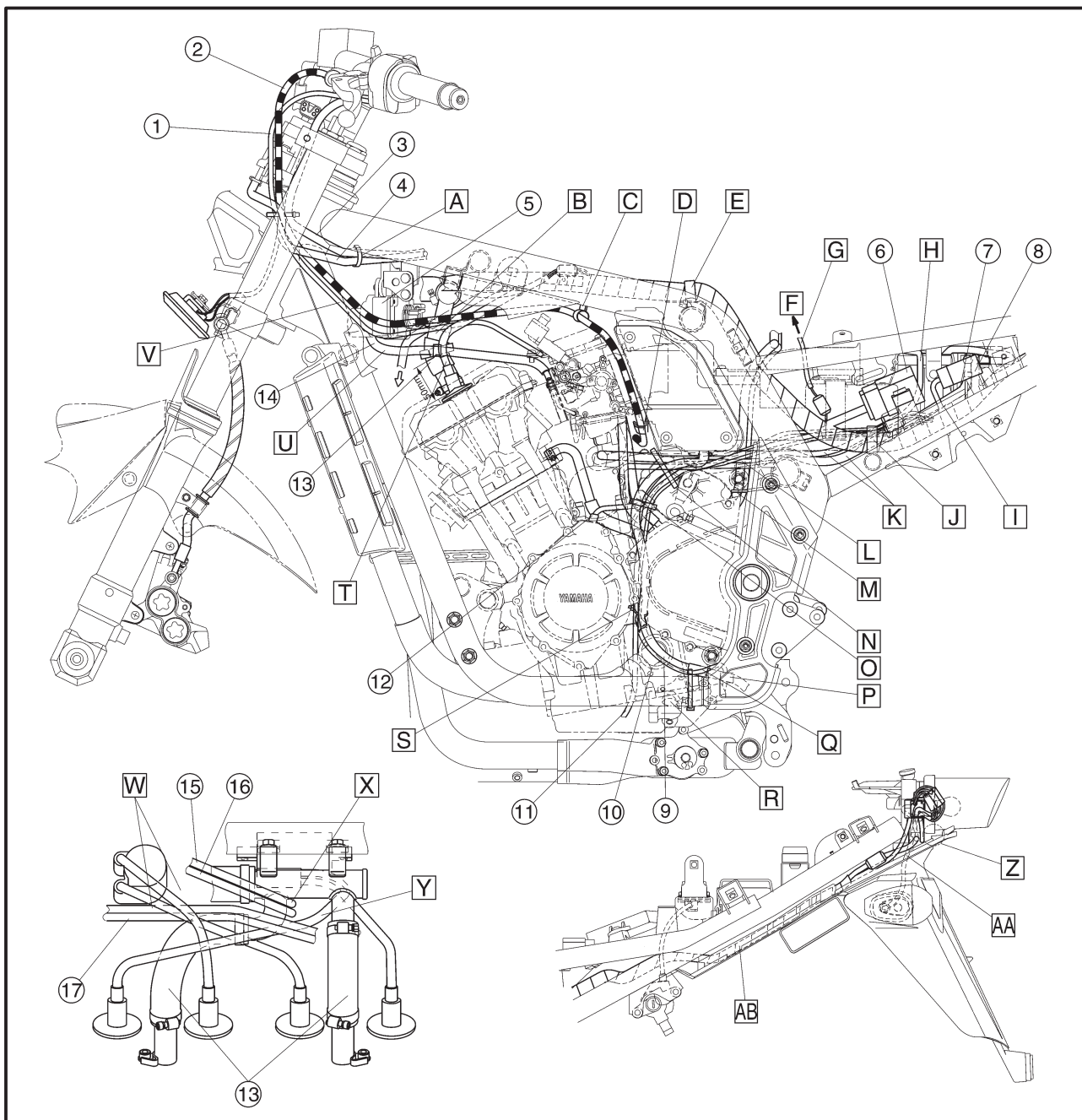

CABLE ROUTING

SPEC



- N** Fasten the sidestand switch lead, oil level switch lead, ACgenerator lead, starter motor lead, battery negative lead and air cleaner case drain hose with a plastic clamp.
- O** Fasten the sidestand switch lead, oil level switch lead, ACgenerator lead and air filter case drain hose with a plastic clamp.
- P** Fasten the sidestand switch lead and frame with a plastic clamp.
- Q** Route the air cleaner box drain hose inside the sidestand switch lead, and put the end of the hose backward.
- R** Fasten the sidestand switch lead and frame with a plastic clamp.
- S** Fasten the sidestand switch lead, oil level switch lead and air filter case drain hose with a plastic clamp. Do not crush the air filter case drain hose.
- T** Route the high tension cable (#1) outside the starter cable and water-carburetor hose, and under the clutch cable and rectifier regulator lead.
- U** Route the water carburetor hose outside the coolant hose.
- V** Route the starter cable outside the coolant hose, and upper the water-carburetor hose.
- W** Route the high tension cable (#2, 3) forward the EXUP cable and high tension cable (#4).
- X** Route the throttle cable between the water-head hose, and upper the EXUP cable.
- Y** Route the high tension cable (#4) between the water-head hose.
- Z** Taillight lead and flasher light lead (right) should not be stick out from the gap between the rear fender and taillight.
- AA** Route the flasher light lead through the hole on the rear fender.
- AB** Route the wire harness in the groove.

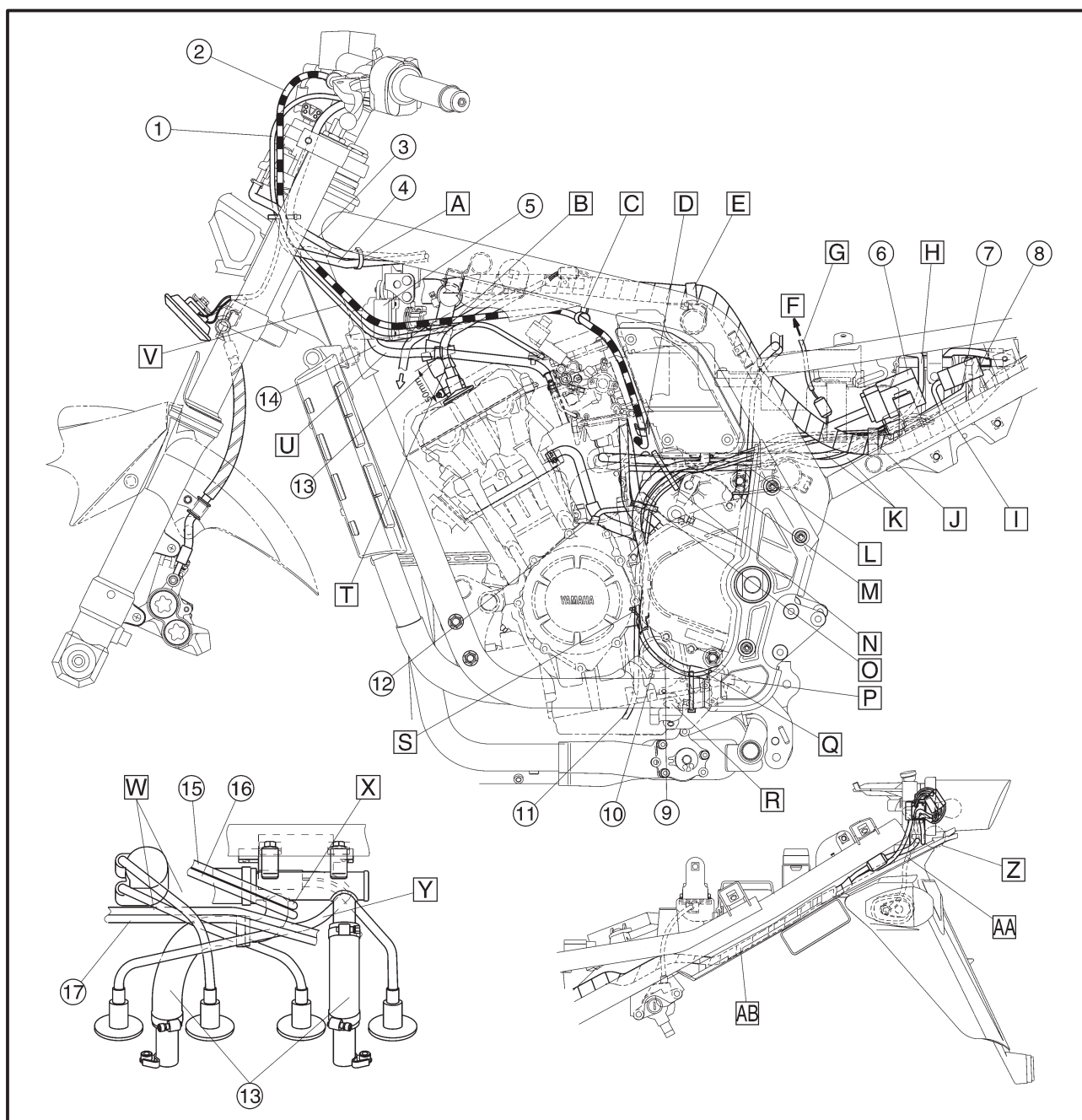



- | | |
|---------------------------------|----------------------------------|
| ① Clutch cable | ①⑦ Ignition coil lead |
| ② Handlebar switch lead | ①⑧ Battery |
| ③ Main switch lead | ①⑨ Emergency engine stop switch |
| ④ Starter cable | ①⑩ Flasher relay |
| ⑤ Thermo unit lead | ①⑪ Fuse box |
| ⑥ Throttle cable 1 | ①⑫ Igniter unit |
| ⑦ Throttle cable 2 | ①⑬ Flasher light lead |
| ⑧ Handlebar switch lead (right) | ①⑭ Taillight lead |
| ⑨ Coolant reservoir hose | ①⑮ Alarm coupler (free) |
| ⑩ Ignition coil | ①⑯ Starter relay |
| ⑪ Fuel hose | ①⑰ Battery positive lead |
| ⑫ Fan motor lead | ①⑱ Fan motor lead |
| ⑬ EXUP servo motor lead | ①⑲ Battery negative lead |
| ⑭ Rectifier/regulator lead | ①⑳ Starting circuit cutoff relay |
| ⑮ White paint mark | |
| ⑯ Main harness | |

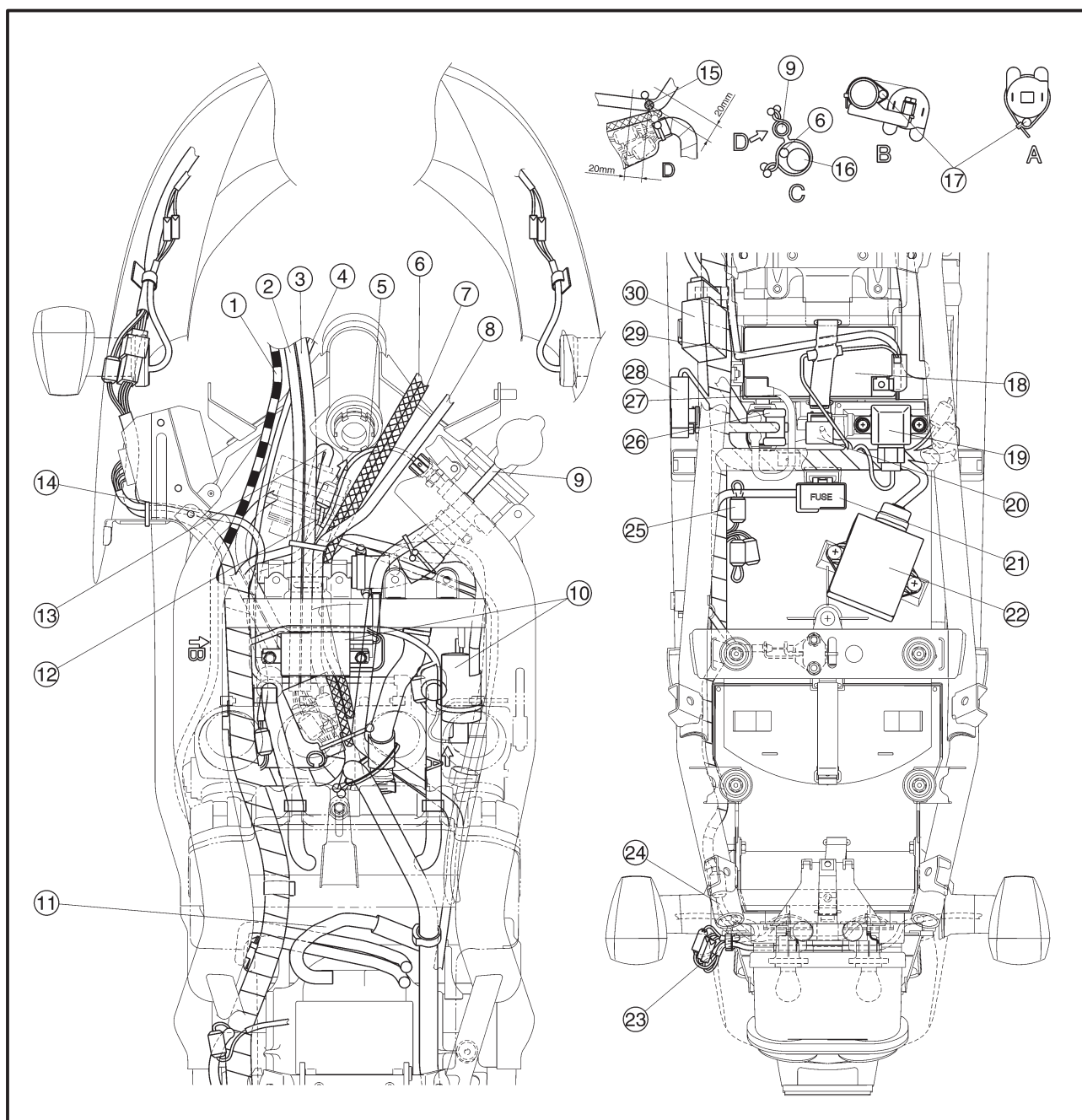

CABLE ROUTING

SPEC



- [A] Fasten the flasher light lead and headlight lead with a plastic clamp.
- [B] Route the rectifier/regulator lead upper the fan motor lead and EXUP servomotor lead.
- [C] Route the throttle cable right side the fan motor lead, EXUP servo motor lead and thermo unit lead.
- [D] Fasten the flasher light lead with a plastic clamp.
- [E] Route the all leads between the frame cross pipe and bracket.
- [F] Do not excessively bend the throttle cable.
- [G] Route the coolant reservoir hose under the frame cross pipe.
- [H] Fasten the ignition coil and ignition coil lead with a plastic clamp.
- [I] Route the T.P.S. lead under the air vent hose.
- [J] Fasten the EXUP cable with a plastic band.
- [K] Fasten the fuel hose and air induction system hose with a plastic clamp.
- [L] Route the coolant reservoir hose under the frame cross pipe.
- [M] Fasten the fuel hose and frame with a plastic band.
- [N] Put the fuel tank drain hose into the forward nipple on the fuel tank.
- [O] Put the fuel tank breather hose into the backward nipple on the fuel tank.
- [P] Route the coolant reservoir hose under the air vent hose and air induction system hose.
- [Q] Route the air vent hose upper the main harness.
- [R] All coupler into the rubber cover.
- [S] Fasten the Rectifier/regulator lead with a plastic band in the main harness.

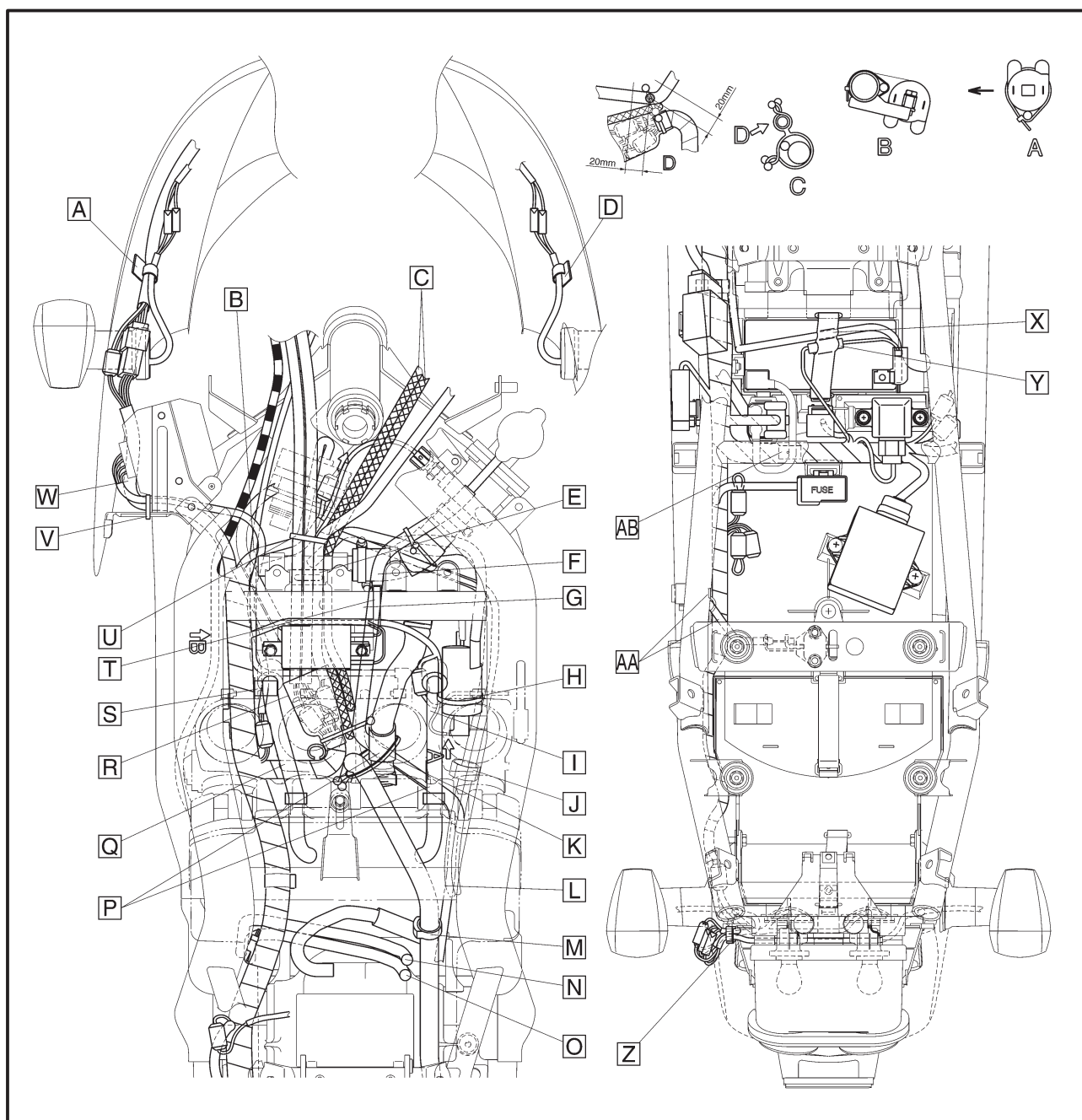

CABLE ROUTING

SPEC



- T** Fasten the ignition coil lead and frame cross pipe with a plastic clamp. Do not fasten the red/black lead and orange lead.
- U** Fasten the handlebar switch lead (left/right), main switch lead, EXUP servo motor lead, fan motor lead and thermo unit lead with a plastic clamp.
- V** Fasten the rectifier/regulator stay and rectifier/regulator lead with a plastic clamp.
- W** Route the wire harness under the rectifier/regulator.
- X** Fasten the battery negative lead with a battery band.
- Y** Insert the ground lead coupler in the battery band.
- Z** Fasten the taillight lead and flasher light lead, and put in the groove on the taillight bracket.
- AA** Put the seat lock cable into the groove on the rear fender.
- AB** Fasten the battery positive lead with a plastic band.

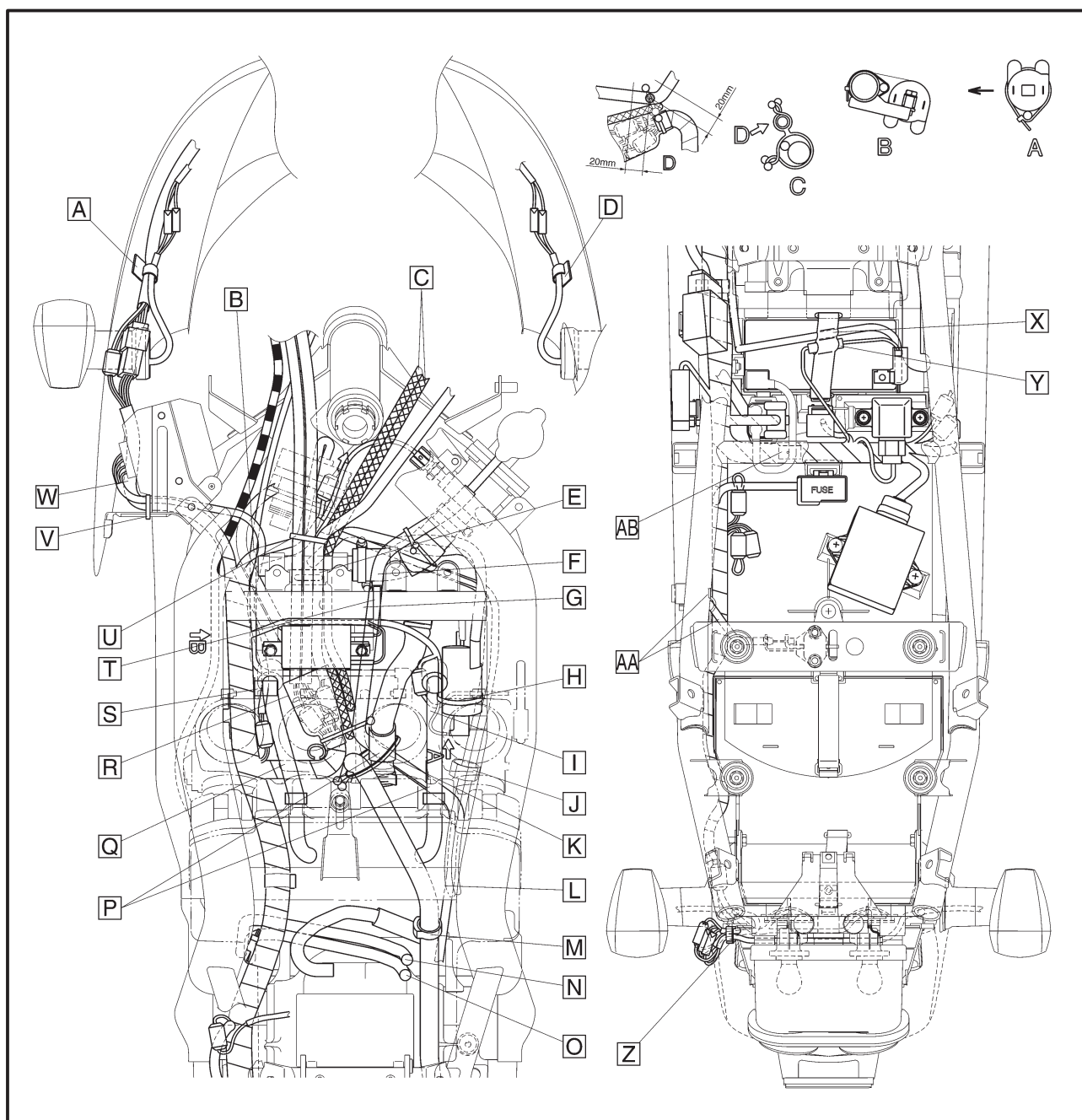



CHK

ADJ

3



CHAPTER 3 PERIODIC CHECKS AND ADJUSTMENTS

INTRODUCTION	3-1
PERIODIC MAINTENANCE/LUBRICATION INTERVALS	3-1
FRONT COWLING/SEAT/SIDE COVER/FUEL TANK	3-3
FRONT COWLING	3-3
SEAT, SIDE COVER AND FUEL TANK	3-4
ENGINE	3-5
ADJUSTING THE VALVE CLEARANCE	3-5
SYNCHRONIZING THE CARBURETORS	3-10
ADJUSTING THE ENGINE IDLING SPEED	3-12
ADJUSTING THE THROTTLE CABLE FREE PLAY	3-13
CHECKING THE SPARK PLUGS	3-15
CHECKING THE IGNITION TIMING	3-16
MEASURING THE COMPRESSION PRESSURE	3-17
CHECKING THE ENGINE OIL LEVEL	3-19
CHANGING THE ENGINE OIL	3-20
ADJUSTING THE CLUTCH CABLE FREE PLAY	3-22
CLEANING THE AIR FILTER ELEMENT	3-23
CHECKING THE CARBURETOR JOINTS AND INTAKE MANIFOLDS	3-24
CHECKING THE FUEL HOSES AND FUEL FILTER	3-24
CHECKING THE CRANKCASE BREATHER HOSE	3-25
CHECKING THE EXHAUST SYSTEM	3-25
ADJUSTING THE EXUP CABLES	3-26
CHECKING THE COOLANT LEVEL	3-27
CHECKING THE COOLING SYSTEM	3-29
CHANGING THE COOLANT	3-30
CHASSIS	3-33
ADJUSTING THE FRONT BRAKE	3-33
ADJUSTING THE REAR BRAKE	3-34
CHECKING THE BRAKE FLUID LEVEL	3-35
CHECKING THE BRAKE PADS	3-36
ADJUSTING THE REAR BRAKE LIGHT SWITCH	3-36
CHECKING THE BRAKE HOSES	3-37
BLEEDING THE HYDRAULIC BRAKE SYSTEM	3-37
ADJUSTING THE SHIFT PEDAL	3-38
ADJUSTING THE DRIVE CHAIN SLACK	3-39
LUBRICATING THE DRIVE CHAIN	3-41
CHECKING AND ADJUSTING THE STEERING HEAD	3-41
CHECKING THE FRONT FORK	3-43
ADJUSTING THE FRONT FORK LEGS	3-43
ADJUSTING THE REAR SHOCK ABSORBER ASSEMBLY	3-45
CHECKING THE TIRES	3-47

CHECKING AND LUBRICATING THE CABLES	3-50
LUBRICATING THE LEVERS AND PEDALS	3-50
LUBRICATING THE SIDESTAND	3-50
LUBRICATING THE REAR SUSPENSION	3-50

ELECTRICAL SYSTEMS	3-51
CHECKING AND CHARGING THE BATTERY	3-51
CHECKING THE FUSES	3-56
REPLACING THE HEADLIGHT BULBS	3-58
ADJUSTING THE HEADLIGHT BEAMS	3-59
ADJUSTING THE DIGITAL CLOCK	3-59

EAS00036

PERIODIC CHECKS AND ADJUSTMENTS

INTRODUCTION

This chapter includes all information necessary to perform recommended checks and adjustments. If followed, these preventive maintenance procedures will ensure more reliable vehicle operation, a longer service life and reduce the need for costly overhaul work. This information applies to vehicles already in service as well as to new vehicles that are being prepared for sale. All service technicians should be familiar with this entire chapter.

EAS00037

PERIODIC MAINTENANCE/LUBRICATION INTERVALS

NOTE: _____

- **The annual checks must be performed every year, except if a kilometer-based maintenance is performed instead.**
- From 50,000 km, repeat the maintenance intervals starting from 10,000 km.
- Items marked with an asterisk should be performed by a Yamaha dealer as they require special tools, data and technical skills.

NO.	ITEM	CHECK OR MAINTENANCE JOB	ODOMETER READING (× 1,000 km)					ANNUAL CHECK
			1	10	20	30	40	
1	* Fuel line (See page 3-24)	• Check fuel hoses for cracks or damage.		√	√	√	√	√
2	* Fuel filter (See page 3-24)	• Check condition.			√		√	
3	Spark plugs (See page 3-15)	• Check condition. • Clean and regap.		√		√		
		• Replace.			√		√	
4	* Valves (See page 3-5)	• Check valve clearance. • Adjust.	Every 40,000 km					
5	Air filter element (See page 3-23)	• Clean.		√		√		
		• Replace.			√		√	
6	Clutch (See page 3-22)	• Check operation. • Adjust.	√	√	√	√	√	
7	* Front brake (See page 3-35) (See page 3-36)	• Check operation, fluid level and vehicle for fluid leakage. (See NOTE)	√	√	√	√	√	√
		• Replace brake pads.	Whenever worn to the limit					
8	* Rear brake (See page 3-35) (See page 3-36)	• Check operation, fluid level and vehicle for fluid leakage. (See NOTE)	√	√	√	√	√	√
		• Replace brake pads.	Whenever worn to the limit					
9	* Brake hoses (See page 3-37)	• Check for cracks or damage.		√	√	√	√	√
		• Replace. (See NOTE)	Every 4 years					
10	* Wheels (See page 4-4)	• Check runout and for damage.		√	√	√	√	
11	* Tires (See page 3-47)	• Check tread depth and for damage. • Replace if necessary. • Check air pressure. • Correct if necessary.		√	√	√	√	
12	* Wheel bearings (See page 4-4)	• Check bearing for looseness or damage.		√	√	√	√	
13	* Swingarm (See page 4-68) (See page 4-69)	• Check operation and for excessive play.		√	√	√	√	
		• Lubricate with lithium-soap-based grease.	Every 50,000 km					
14	Drive chain (See page 3-39) (See page 4-69)	• Check chain slack. • Make sure that the rear wheel is properly aligned. • Clean and lubricate.	Every 1,000 km and after washing the motorcycle or riding in the rain.					
15	* Steering bearings (See page 3-41) (See page 4-59)	• Check bearing play and steering for roughness.	√	√	√	√	√	
		• Lubricate with lithium-soap-based grease.	Every 20,000 km					