

MANIFOLD, AIR FILTER AND MUFFLER ASSEMBLY

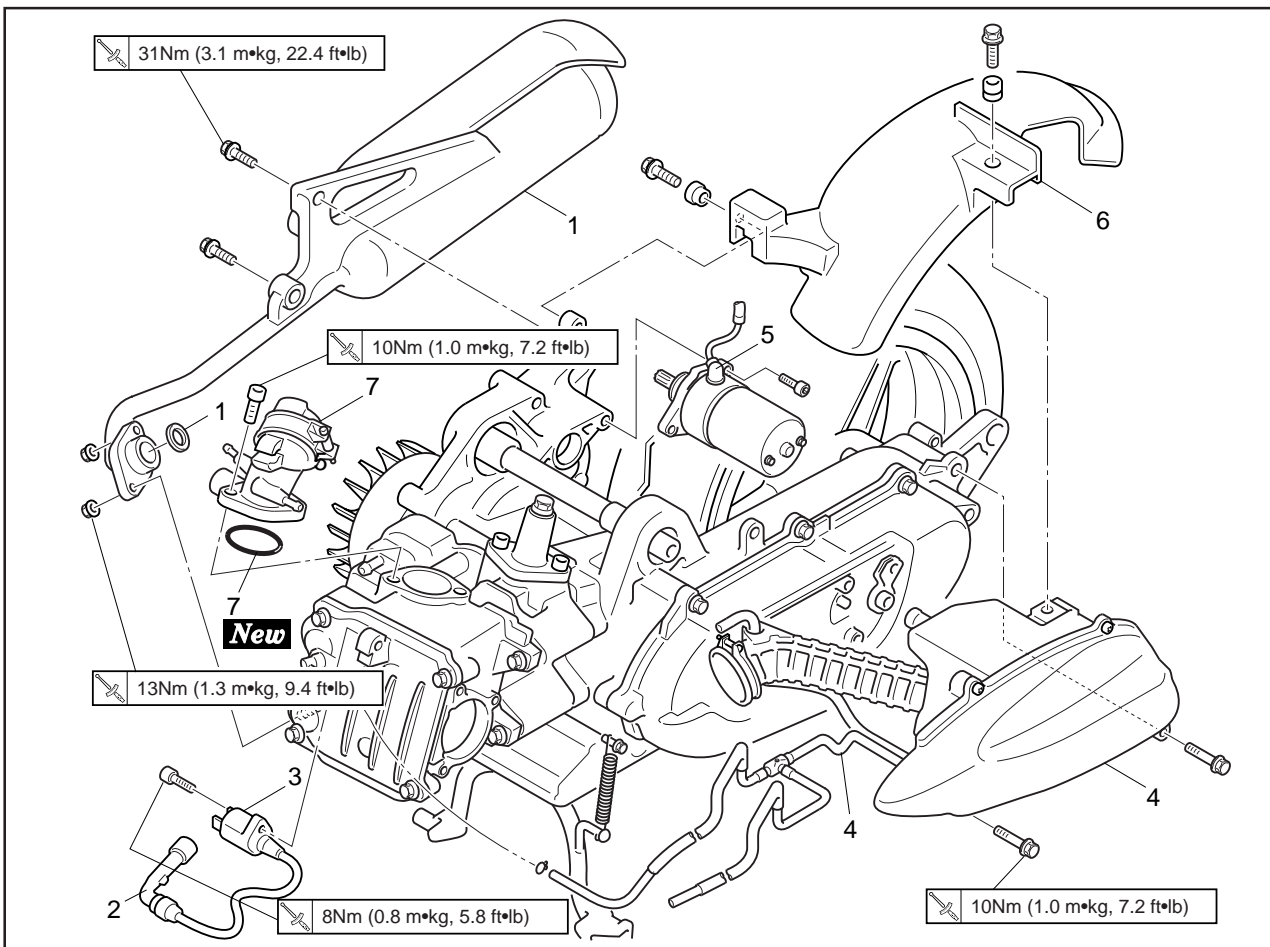

Order	Job/Part	Q'ty	Remarks
	Removing the manifold, air filter and muffler assembly		Remove the parts in the order listed.
	Rear brake cable(adjuster/pin)		Refer to "LEADS, HOSES AND REAR BRAKE".
	Rear wheel lock cable		
	Hose(to air cut-off valve)		
	Vacuum hose(to air cut-off valve)		
	Vacuum hose(to fuel cock)		Refer to "CARBURETOR" in chapter 7.
	Throttle cable kit		
	Auto choke lead		
	Throttle position sensor lead		
1	Muffler assembly/Gasket	1/1	
2	Spark plug cap	1	
3	Ignition coil	1	
4	Air filter assembly/Breather hose	1/1	
5	Starter motor assembly	1	
6	Rear fender	1	
7	Manifold/O-ring	1/1	
			For installation, reverse the removal procedure.

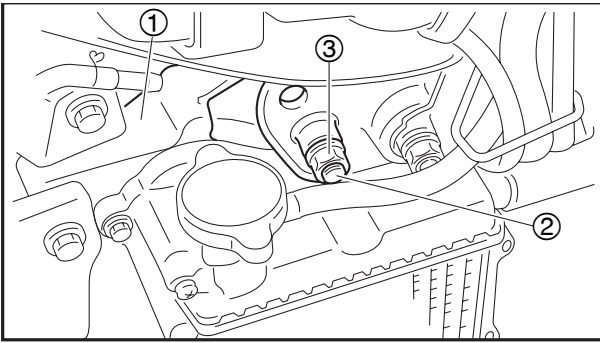

EAS00192

INSTALLING THE ENGINE

1. Install:
 - engine ①
 - engine mounting bolt ②
 - self lock nut③

NOTE:

Do not fully tighten the bolts.

2. Tighten:
 - self lock nut

 46Nm(4.6 m • kg, 33.3 ft • lb)

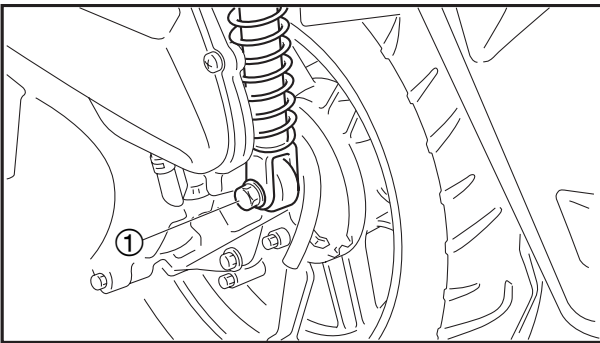

3. Tighten:
 - rear shock absorber assembly lower bolt①

 16 Nm (1.6 m • kg, 11.6 ft • lb)



EAS00221

CYLINDER HEAD

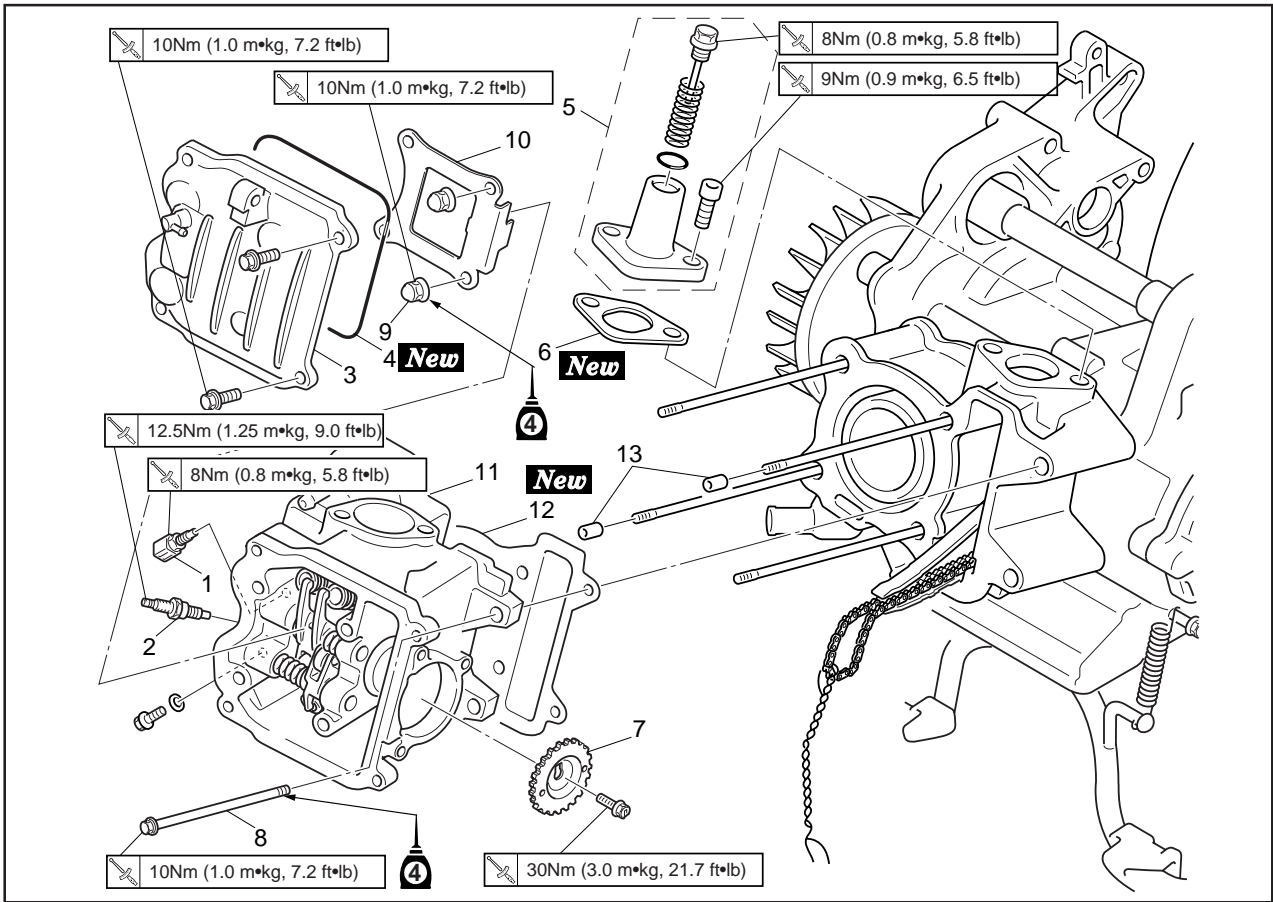

Order	Job/Part	Q'ty	Remarks
	Removing the cylinder head		Remove the parts in the order listed.
	Muffler assembly		Refer to "MANIFOLD, AIR FILTER AND MUFFLER ASSEMBLY".
	Air filter assembly/Breather hose		
	Manifold/O-ring		
1	Thermostat unit	1	Refer to "REMOVING THE CYLINDER HEAD".
2	Spark plug	1	
3	Cylinder head cover	1	
4	O-ring	1	
5	Timing chain tensioner assembly	1	
6	Timing chain tensioner gasket	1	
7	Camshaft sprocket	1	
8	Bolt	2	For installation, reverse the removal procedure.
9	Nut	4	
10	Plate	1	
11	Cylinder head	1	
12	Cylinder head gasket	1	
13	Dowel pin	2	



EAS00225

REMOVING THE CYLINDER HEAD

1. Remove :

- crankcase cover (left)
Refer to " BELT DRIVE".
- cylinder head cover

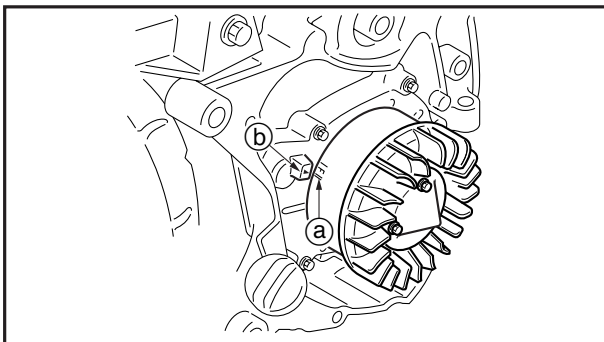

2. Align:

- "1" mark (a) on the magneto rotor
(with the stationary pointer (b) on the crankcase cover)

- a. Turn the primary fixed sheave counterclockwise.
- b. When the piston is at TDC on the compression stroke, align the "1" mark (c) on the camshaft sprocket with the mark (d) on the plate.

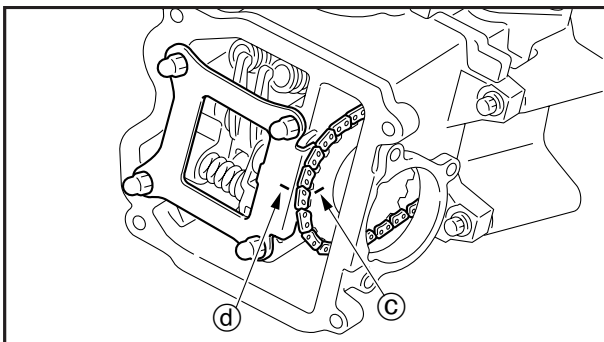

3. Loosen:

- timing chain tensioner bolt
 - camshaft sprocket bolt (1)
- While holding the crank bolt with a wrench (2), remove the camshaft sprocket bolt (1).

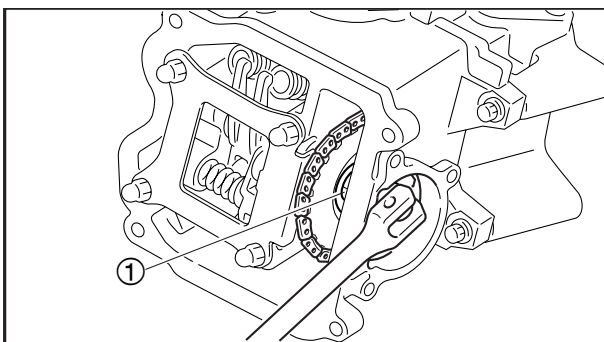

	<p>Rotor holding tool 90890-01235 YU-01235</p>
--	---

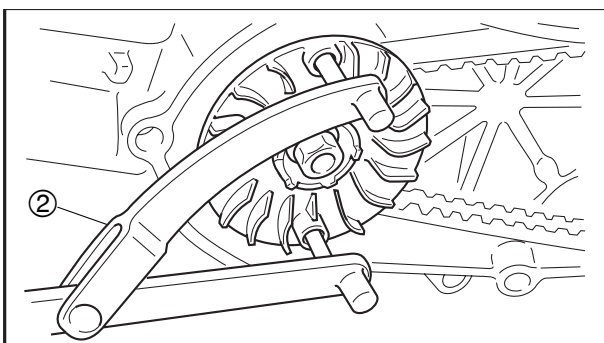

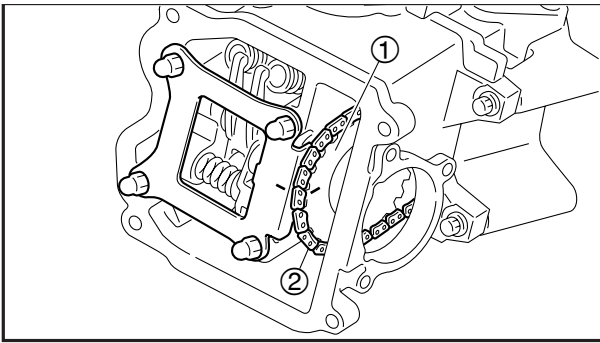

4. Remove:
- timing chain tensioner (along with the gasket)
 - camshaft sprocket ①
 - timing chain ②

NOTE: _____

To prevent the timing chain from falling into the crankcase, fasten it with a wire.

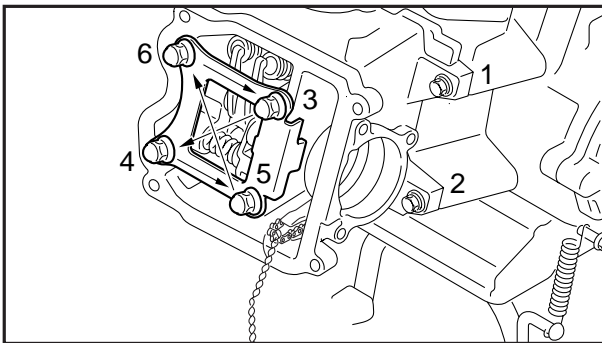

5. Remove:
- cylinder head

NOTE: _____

- Loosen the nuts in the proper sequence as shown.
- Loosen each nut 1/2 of a turn at a time. After all of the nuts are fully loosened, remove them.

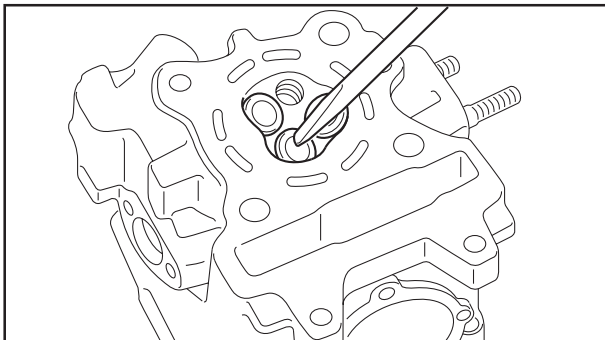

EAS00227

CHECKING THE CYLINDER HEAD

1. Eliminate:
 - combustion chamber carbon deposits (with a rounded scraper)

NOTE: _____

Do not use a sharp instrument to avoid damaging or scratching:

- spark plug bore thread
- valve seats

2. Check:
 - cylinder head
Damage/scratches → Replace.

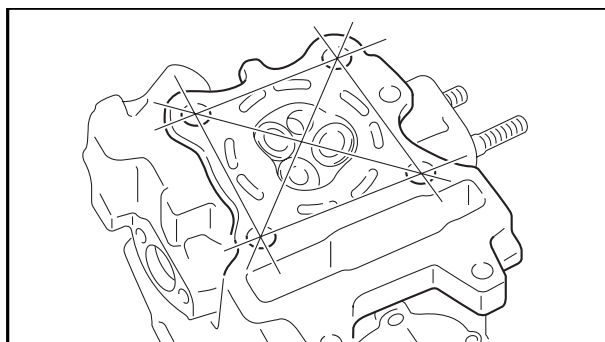

3. Measure:
 - cylinder head warpage
Out of specification → Resurface the cylinder head.

	Maximum cylinder head warpage 0.05 mm (0.002 in)
---	---

- a. Place a straightedge and a thickness gauge across the cylinder head.
- b. Measure the warpage.
- c. If the limit is exceeded, resurface the cylinder head as follows.
- d. Place a 400 ~ 600 grit wet sandpaper on the surface plate and resurface the cylinder head using a figure-eight sanding pattern.

NOTE: _____

To ensure an even surface, rotate the cylinder head several times.

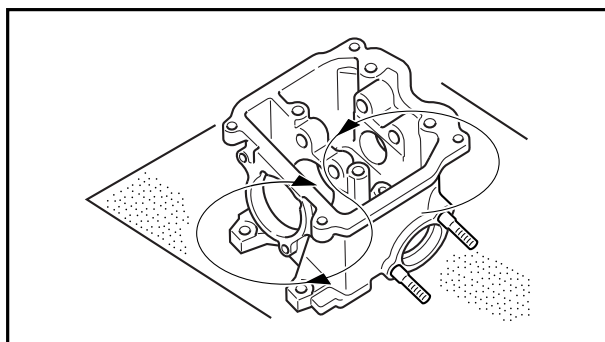

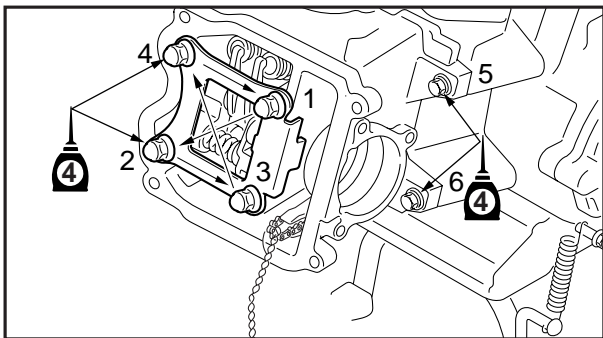

EAS00231

INSTALLING THE CYLINDER HEAD

1. Install:
 - gasket **New**
 - dowel pins
2. Install:
 - cylinder head
3. Tighten:
 - cylinder head nuts

10 Nm (1.0 m • kg, 7.2 ft • lb)

- cylinder head bolts

10 Nm (1.0 m • kg, 7.2 ft • lb)

NOTE: _____

- Lubricate the cylinder head nuts with engine oil.
- Tighten the cylinder head nuts in the proper tightening sequence as shown and torque them in two stages.

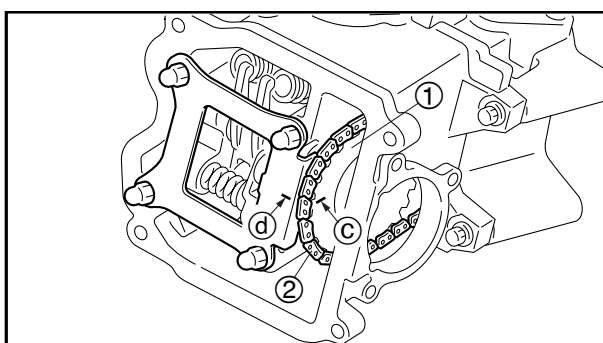
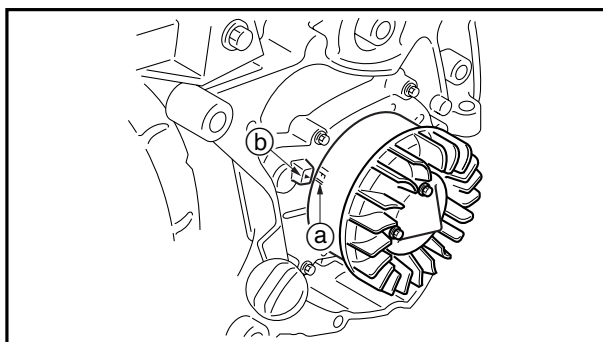

4. Install:
 - camshaft sprocket ①
 - timing chain ②

- a. Turn the primary pulley counterclockwise.
- b. Align the “I” mark (a) on the AC magneto rotor with the stationary pointer (b) on the crankcase cover.
- c. Align the “I” mark (c) on the camshaft sprocket with the stationary pointer (d) on the plate.
- d. Install the timing chain onto the camshaft sprocket, and then install the camshaft sprocket onto the camshaft.

NOTE: _____

- When installing the camshaft sprocket, be sure to keep the timing chain as tight as possible on the exhaust side.
- Align the slot on the camshaft with the tab in the camshaft sprocket.