

Marine Engines - Electronic Control System Wiring Diagram

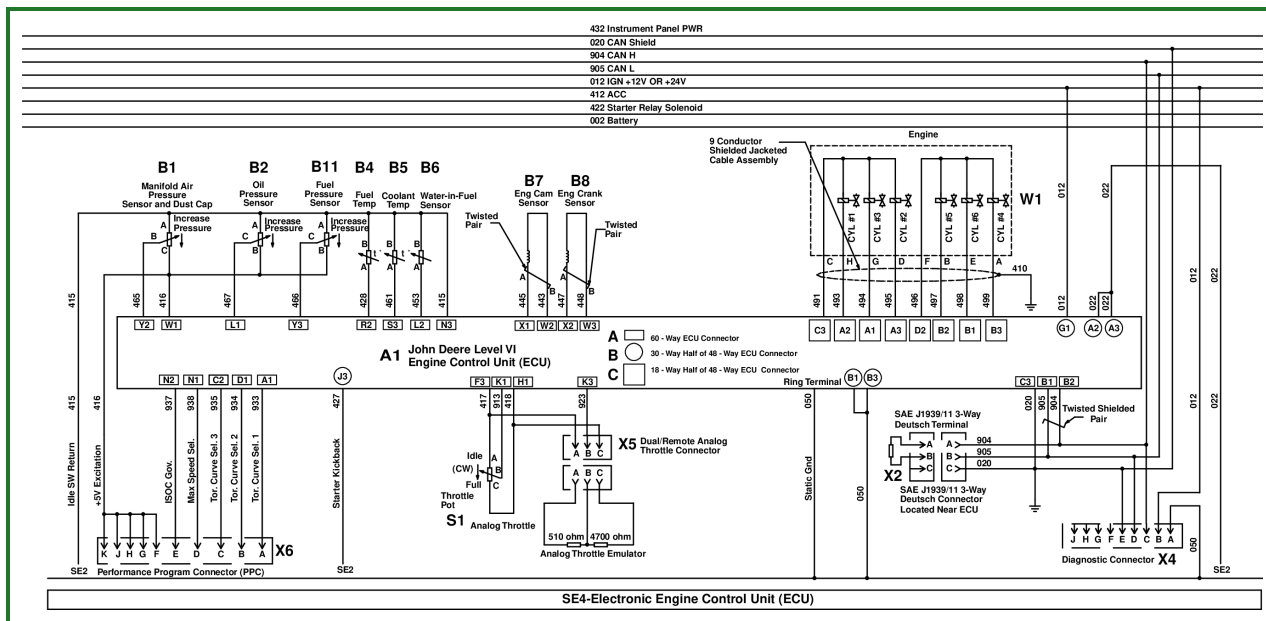

RG10696-UN: 10.5 L & 12.5 L Marine Electronic Control System Wiring Diagram

LEGEND:

- A - 60-way ECU Connector
- B - 30-way half of 48-way ECU connector
- C - 18-way half of 48-way ECU connector
- A1 - John Deere Level 6 Control Unit (ECU)
- B1 - Manifold Air Pressure Sensor
- B2 - Oil Pressure Sensor
- B4 - Fuel Temperature Sensor
- B5 - Engine Coolant Sensor
- B6 - Water in Fuel Sensor
- B7 - Engine Cam Sensor
- B8 - Engine Crank Sensor
- B10 - Fuel Vacuum Switch
- B11 - Fuel Pressure Sensor
- S1 - Analog Throttle (A)
- W1 - Electronic Unit Injectors (6)
- X2 - CAN Terminator
- X4 - Diagnostic Connector
- X5 - Analog Throttle (B)
- X6 - Performance Program Connector

Go to [Section_06:Group_210](#)

RG40854,0000021-19-20020417

12.5 L Marine Application Wheel House Panel Electrical Wiring Diagram

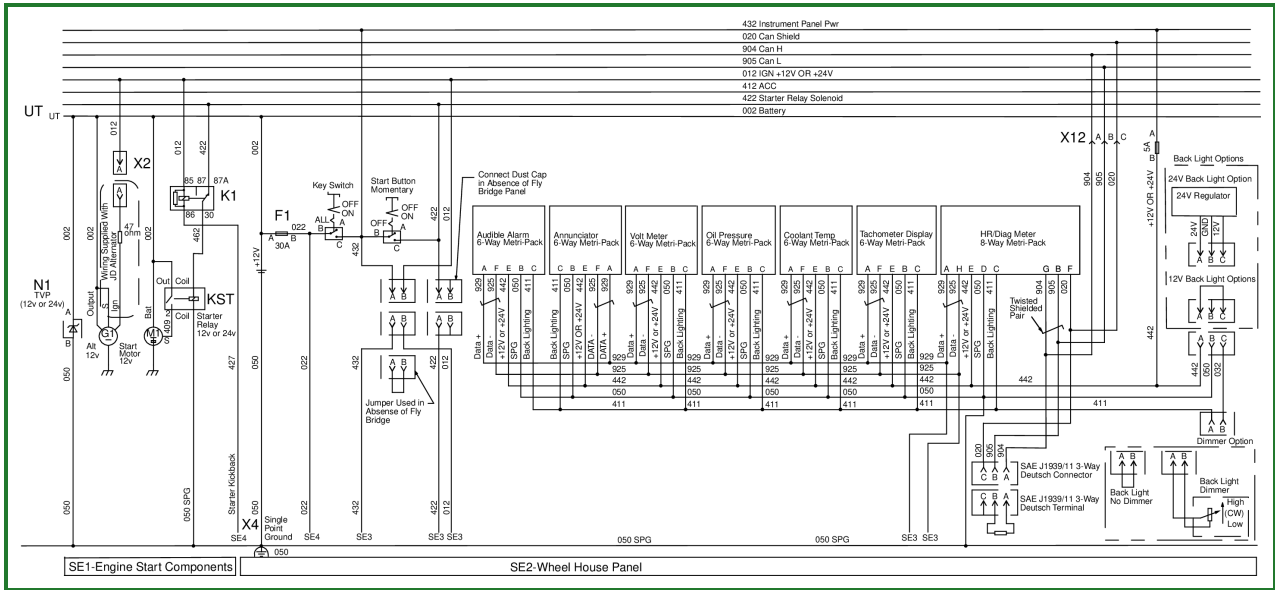

RG12802-19: Wheel House Panel Schematic

Go to [Section_06:Group_210](#)

RG41221,00000FF-19-20030306