

Adjustable Circuit Relief Valve Disassemble and Assemble

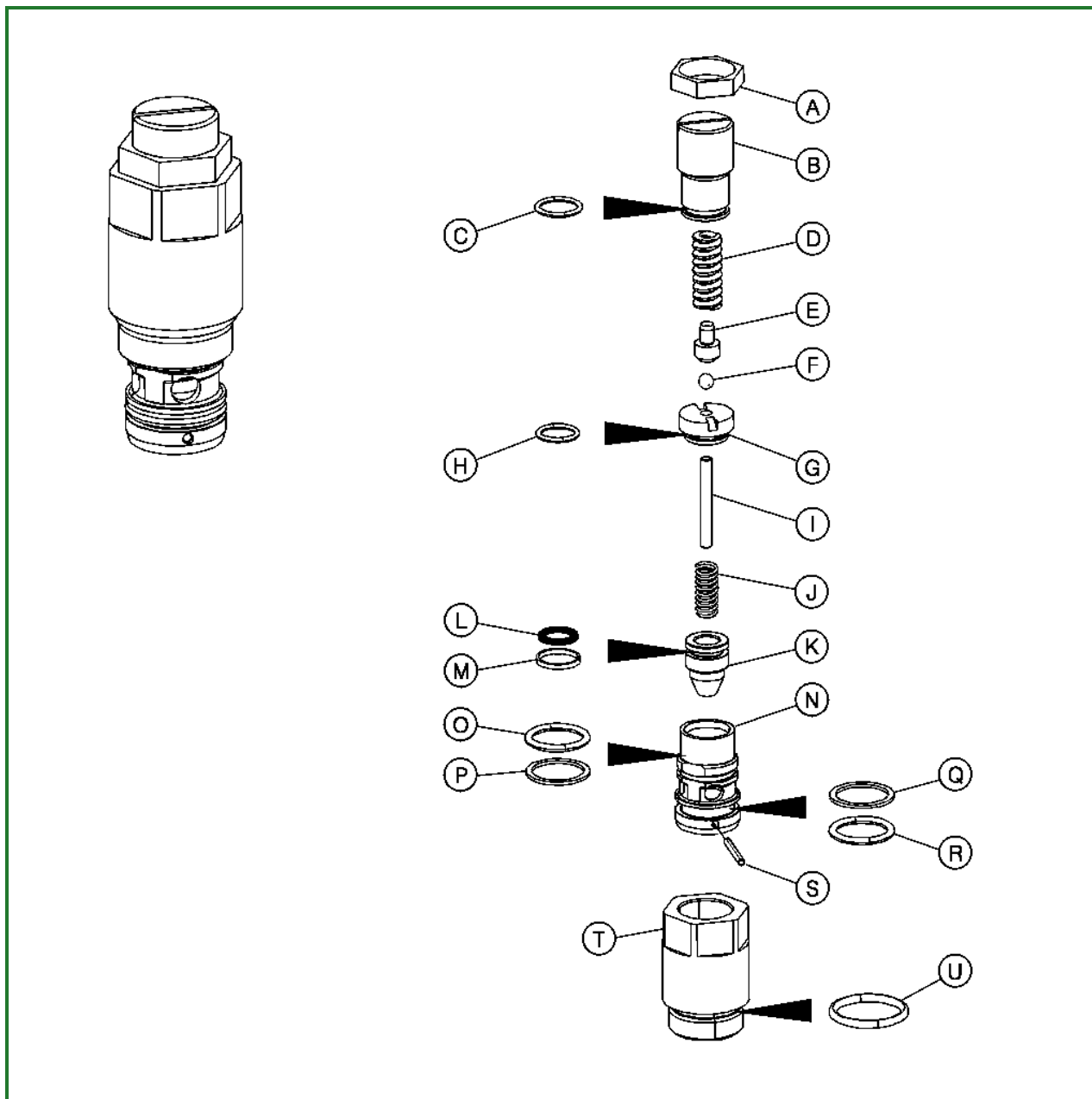

TX1009006-UN: Adjustable Circuit Relief Valve

LEGEND:

- A - Lock Nut
- B - Adjusting Screw
- C - O-ring
- D - Spring
- E - Poppet
- F - Ball
- G - Retainer
- H - O-ring
- I - Rod
- J - Spring
- K - Poppet
- L - Seal
- M - Ring
- N - Housing

- O - O-ring
- P - Backup Ring
- Q - Backup Ring
- R - O-ring
- S - Pin
- T - Valve Body
- U - O-ring

1. The non-adjustable circuit relief valve can be disassembled as shown.
2. Inspect poppet (E) seal for damage.
3. Replace o-rings, backup rings and seals.
4. When installing relief valve on control valve, tighten valve to specified torque.

Item	Measurement	Specification
Adjustable Circuit Relief Valve	Torque	100 N·m 75 lb-ft

5. Tighten adjustment screw lock nut to specified torque.

Item	Measurement	Specification
Adjustment Screw Lock Nut	Torque	88 N·m 65 lb-ft

Go to [Section_38:Group_3860](#)

GD61784,00000E1-19-20070706