

Replace Swing Arm Bushings

1.

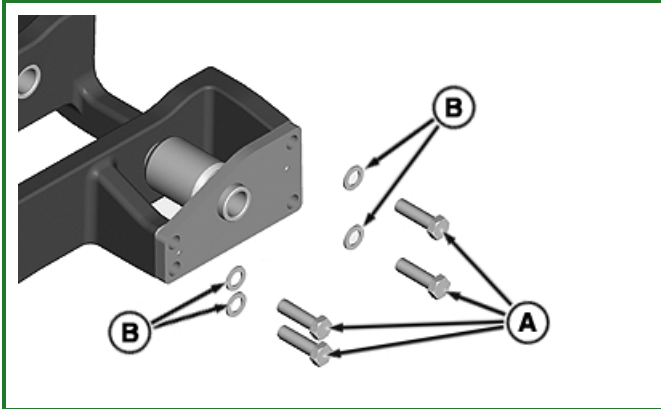

RXA0098288-UN: Cap Screws and Washers

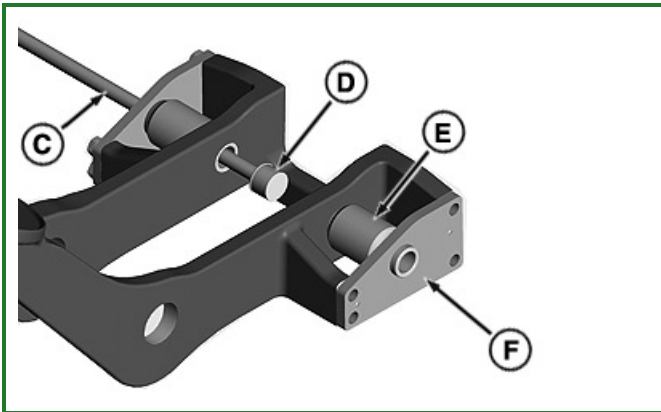

RXA0098291-UN: Driver and Handle

LEGEND:

- A - Cap Screws (4 used)
- B - Washers (4 used)
- C - JDG342 Driver Handle
- D - JDP-10 Bushing Installer
- E - Bushing
- F - Plate

Remove swing arm.

2. Remove cap screws (A) and washers (B).
3. Position **JDG342 Driver Handle** (C) through swing arm and install **JDP10 Bushing Installer** (D) to handle (C).
4. Remove bushing (E) and plate (F) using **JDG342 Driver Handle** and **JDP10 Bushing Installer** .

5. **NOTE:**

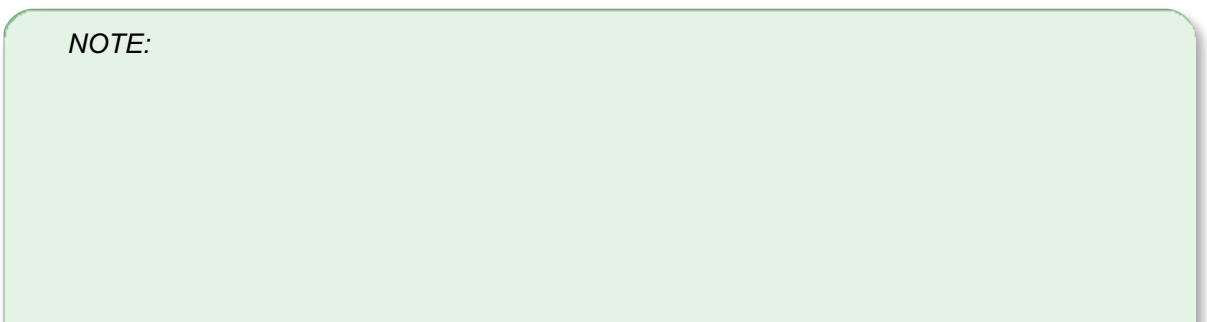

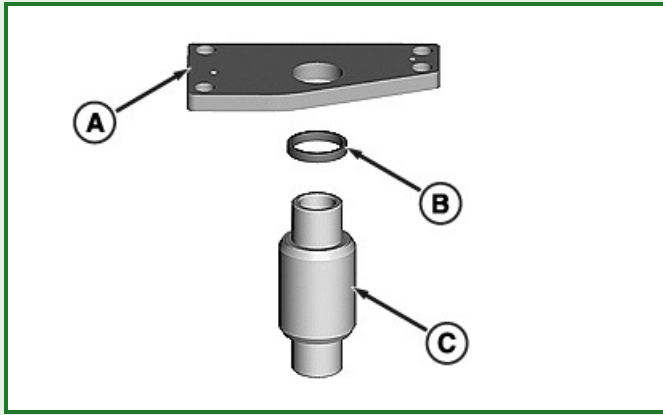

RXA0098289-UN: Bushing, Spacer, and Plate

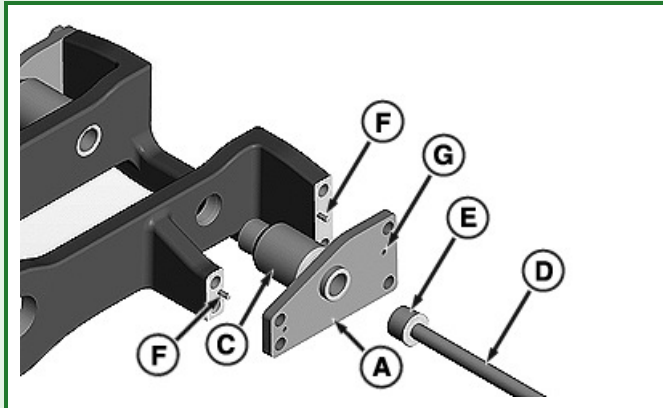

RXA0098290-UN: Install Bushing and Plate

LEGEND:

- A - Plate
- B - Spacer
- C - Bushing
- D - JDG342 Driver Handle
- E - JDP-10 Bushing Installer
- F - Guide Pins (2 used)
- G - Guide Holes (2 used)

Driver disk is part of D01045AA Disk Set .

Using a hydraulic press and a 52 mm (2-1/16 in.) driver disk, remove bushing (C) and spacer (B) from plate (A).

6. Replace parts as necessary.
7. Install spacer on bushing.
8. Press plate onto bushing until plate contacts spacer.
9. Install bushing and plate assembly onto swing arm.
10. Ensure guide pins (F) are started in guide holes (G).
11. Drive bushing and plate assembly into swing arm using **JDG342 Driver Handle (D)** and **JDP10 Bushing Installer (E)** until plate (A) is flush with swing arm.