

Replace Walking Beam Pivot Bushing and Isolator Bushing

1.

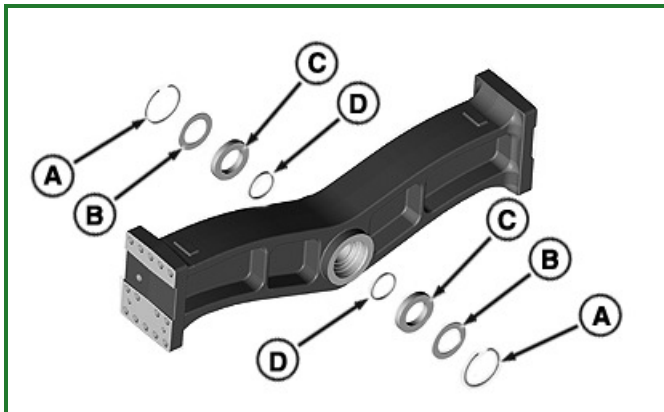

RXA0098297-UN: Walking Beam Center

LEGEND:

A - Snap Rings (2 used)

B - Washers (2 used)

C - Foam Seals (2 used)

D - Lip Seals (2 used)

For Both Bushings:

- Remove walking beam.

2. Remove snap rings (A), washers (B), foam seals (C), and lip seals (D) from both sides of walking beam.

3.

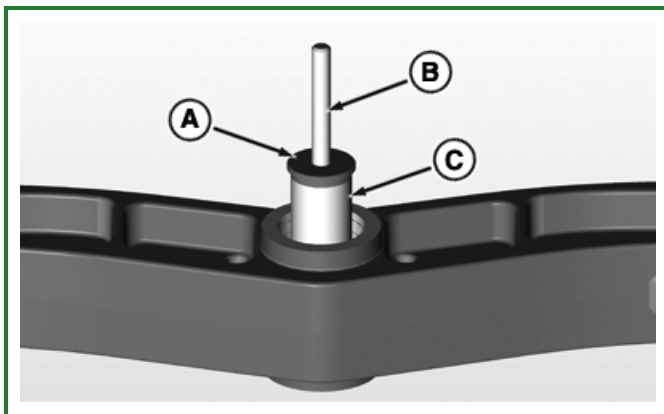

RXA0098300-UN: Install Pivot Bushing

LEGEND:

A - JDG1427 Driver

B - JDG537 Driver Handle

C - Pivot Bushing

Replacing Pivot Bushing Only:

- Remove pivot bushing by cutting with a hacksaw blade.

4.

NOTE:

Driver disk is part of D01045AA Disk Set.

Support bottom of isolator bushing in press using a 108 mm (4-1/4 in.) driver disk.

5. Press in new pivot bushing (C) using JDG1427 Driver (A) and JDG537 Driver Handle (B) until driver contacts isolator bushing.

6. **NOTE:**

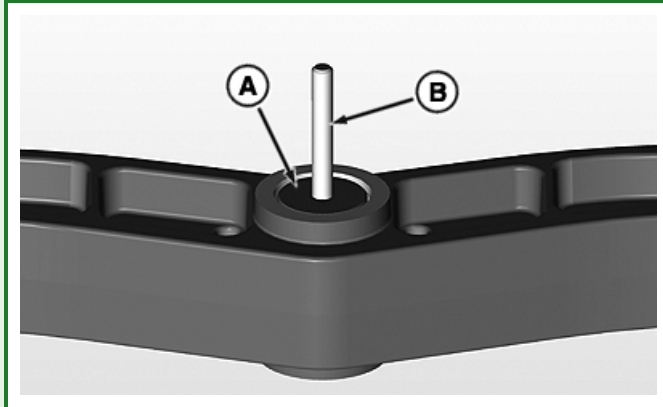

RXA0098301-UN: Removing Isolator and Pivot Bushing

LEGEND:

A - Driver Disk

B - Handle

Handle and driver disk are part of D01045AA Disk Set.

Replacing Isolator Bushing and Pivot Bushing:

- Press out isolator bushing (with pivot bushing) using a 108 mm (4-1/4 in.) driver disk (A) and handle (B).

- 7.

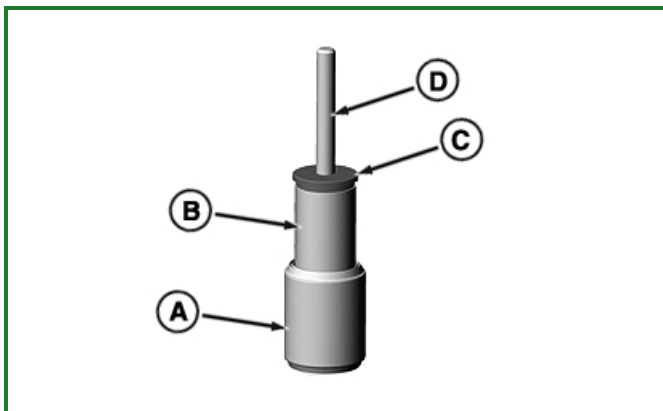

RXA0098302-UN: Assembling Bushing

LEGEND:

A - Isolator Bushing

B - Pivot Bushing

C - JDG1427 Driver

D - JDG537 Driver Handle

Press new pivot bushing (B) into isolator bushing (A) using JDG1427 Driver (C) and JDG537 Driver Handle (D) until driver contacts isolator bushing.