

## Remove, Repair, and Install Two Piece Mid-Roller Assembly

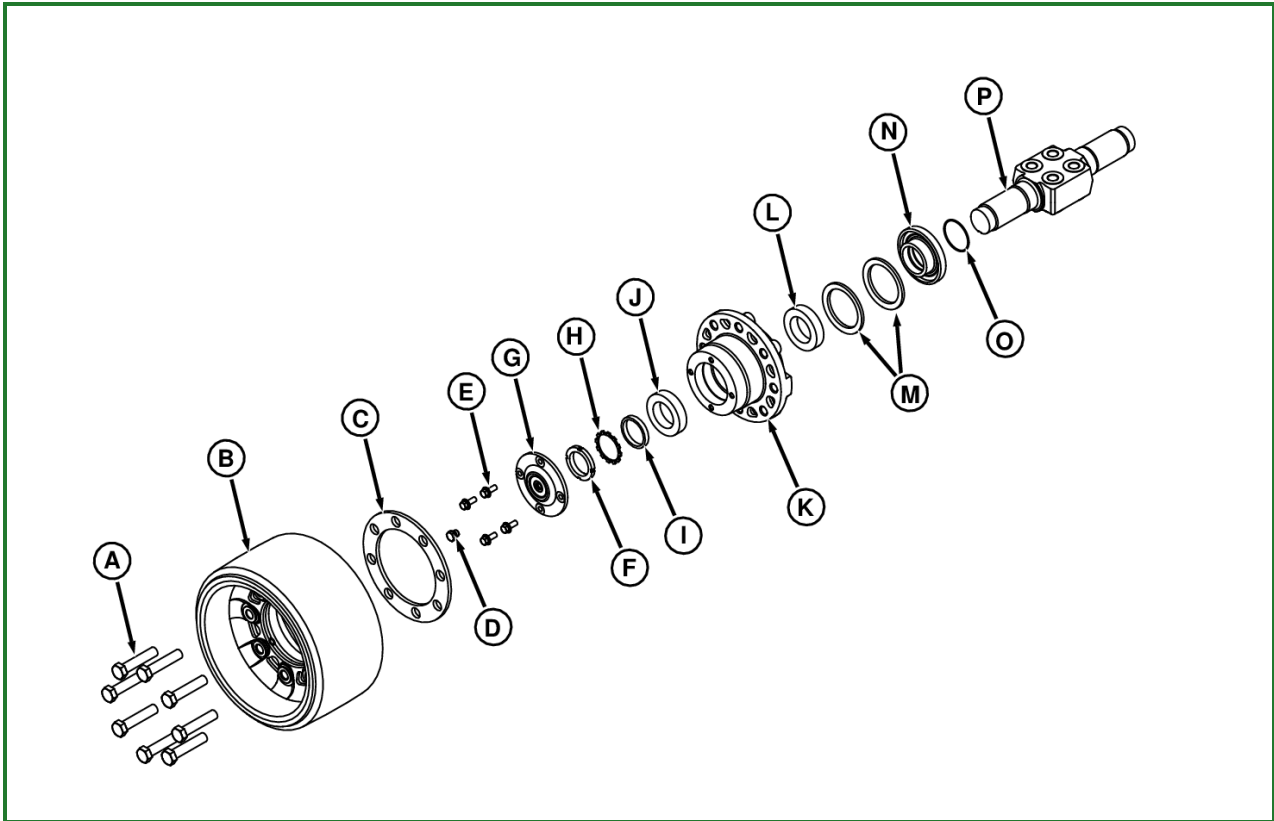

### RXA0061969-UN: Two Piece Mid-Roller Assembly Exploded View

#### **LEGEND:**

- A - Cap Screws (8 used)
- B - Mid-Roller Wheel
- C - Spacer Ring (European Wide Track Only)
- D - Oil Fill Plug
- E - Cover Retaining Cap Screw (4 used)
- F - Idler Hub Cover
- G - Mid-Roller Assembly Retaining Nut
- H - Lock Washer
- I - Washer
- J - Bearing Cone
- K - Mid-Roller Hub
- L - Bearing Cone
- M - Seals (2 used)
- N - Seal Retainer
- O - O-Ring
- P - Mid-Roller Spindle

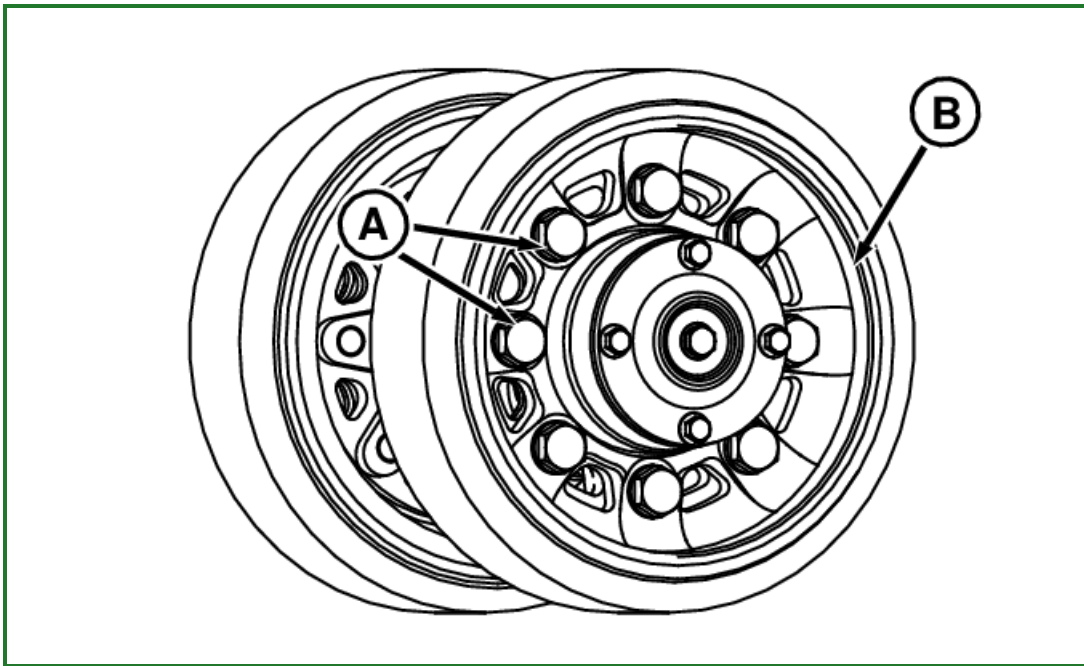

**RXA0062514-UN: Mid-Roller Wheel**



**RXA0062630-UN: Mid-Roller Assembly Retaining Cap Screws**

**LEGEND:**

- A - Cap Screws (8-used)
- B - Mid-Roller Wheel
- C - Cap Screws (4-used)

1. Remove cap screws (A) and remove mid-roller wheel (B).
2. Remove cap screws (C) and remove mid-roller assembly from tractor.

3.

**NOTE:**

See DFRW173 if the existing Mid-Roller Bracket (A) does not have added holes in it.