

Reference 290-20-040, Heating and Ventilation

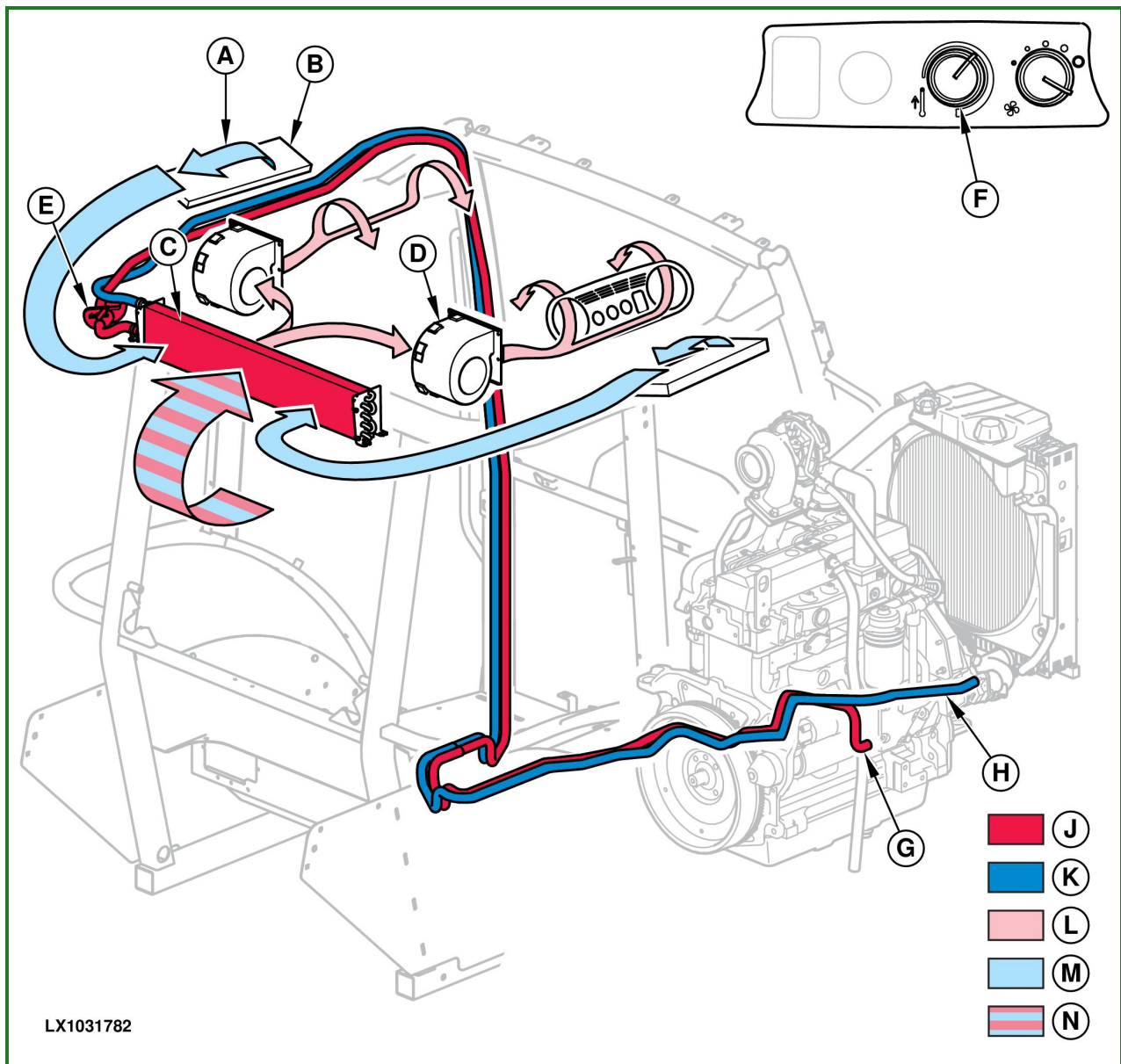

LX1031782-UN: Heating and ventilation

LEGEND:

- A - Air inlet (2 used)
- B - Cab air filter (2 used)
- C - Radiator
- D - Fan motor (2 used)
- E - Heater valve
- F - Knob for heating
- G - Inlet (from cylinder block)
- H - Return to coolant pump
- J - Hot water inlet
- K - Warm water return
- L - Warm air
- M - Fresh air
- N - Recirculated air

The heating system is connected to the tractor engine cooling system. The heated engine coolant is directed out of the engine block to the heater valve in the roof and from there to the radiator. The heater valve regulates or completely shuts off the flow of coolant. When the valve is open, engine coolant flows through the radiator and via

the return line to the coolant pump.

The fan motors suck in fresh air through the air inlets under each side of the cab roof.

The fresh air passes through the air filters into the air ducts in the cab roof and mixes with air recirculated from the cab. This air mixture flows through the radiator and becomes heated. The two fans push warm air through the cab air vents, which can be adjusted to direct the air as desired.

The fans provide a positive pressure in the cab to keep dust and dirt out.

[Go to Section_290:Group_20](#)

OULXA64,0000A64-19-20030206